

War Department mapping project.  
Under direction of the Chief of Engineers.  
Control by the U. S. Coast and Geodetic Survey.  
Planimetry compiled from air photographs by U. S. Coast and Geodetic Survey.  
Planimetry and field edit by U. S. Coast and Geodetic Survey, 1942.  
Polyconic projection, North American datum of 1927.  
This map complies with the national standard map accuracy requirements.

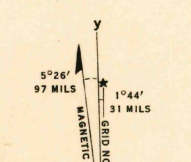
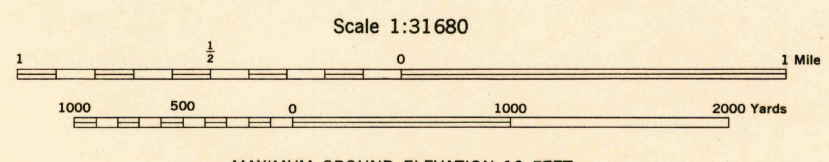

REPRODUCED BY THE U. S. COAST AND GEODETIC SURVEY. (W 8 N) 1943  
AGE NO. 120762

Recoverable horizontal control stations of less than third order accuracy are shown by circles.

ROAD CLASSIFICATION 1942

Dependable hard-surface, heavy-duty road.	Loose-surface graded, dry-weather road.	U. S. route 74
Secondary, hard-surface, all-weather road.	Dirt road.	State route 26

More than two lanes indicated by note along road with tick at point of change 3 LANE 4 LANE

MAXIMUM GROUND ELEVATION 10 FEET  
DATUM IS MEAN SEA LEVEL

ONE THOUSAND YARD GRID COMPUTED FROM "GRID SYSTEM FOR PROGRESSIVE MAPS IN THE U. S. ZONE A, U. S. C. & S. SPECIAL PUBLICATION NO. 58"  
THE LAST THREE DIGITS OF THE GRID NUMBERS ARE OMITTED  
THE STATE GRIDS ARE INDICATED AT 10,000 FOOT INTERVALS  
NOTE: OFFICERS USING THIS MAP WILL MAKE NECESSARY CORRECTIONS AND ADJUSTMENTS WHICH COME TO THEIR ATTENTION AND WILL DIRECT TO "THE CHIEF OF ENGINEERS, WASHINGTON, D. C."

USCS  
Historical File  
Topographic Division

MARION, MD.  
N3800-W7545/7.5

U. S. G. S.  
FILE COPY  
Inspection and Editing.