

War Department mapping project.
Under direction of the Chief of Engineers.
Control by the U. S. Coast and Geodetic Survey.
Planimetry compiled from air photographs by U. S. Coast and Geodetic Survey.
Planimetric topography and field edit by U. S. Coast and Geodetic Survey, 1943.
Polyconic projection, North American datum of 1927.
This map complies with the national standard map accuracy requirements.

ROAD CLASSIFICATION 1943

Dependable hard-surface, heavy-duty road.	Loose surface graded, dry-weather road.	U. S. route
Secondary, hard-surface, all-weather road.	Dirt road.	State route

More than two lanes indicated by note along road with tick at point of change.

Scale 1:31680

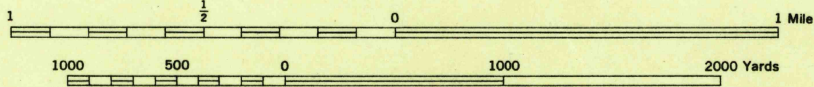

CONTOUR INTERVAL 20 FEET
DATUM IS MEAN SEA LEVEL

ONE THOUSAND-YARD GRID COMPUTED FROM "GRID SYSTEM FOR PROGRESSIVE MAPS
IN THE U. S.," ZONE A, U. S. C. & G. S. SPECIAL PUBLICATION NO. 59
THE LAST THREE DIGITS OF THE GRID NUMBERS ARE OMITTED.
THE STATE GRID IS INDICATED AT 10,000 FOOT INTERVALS.
NOTE: OFFICERS USING THIS MAP WILL MARK HEREON CORRECTIONS AND ADDITIONS WHICH COME
TO THEIR ATTENTION AND MAIL DIRECT TO "THE CHIEF OF ENGINEERS WASHINGTON, D. C."

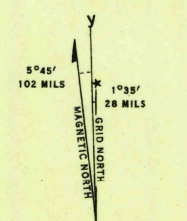

REPRODUCED BY THE U. S. COAST AND GEODETIC SURVEY (W & H) 1943

ANS NO. 120775

Recoverable horizontal control stations of less
than third order accuracy are shown by circles.

POCOMOKE CITY, MD.-VA.
N3800-W7530/7.5

USCS
Historical File
Topographic Division