

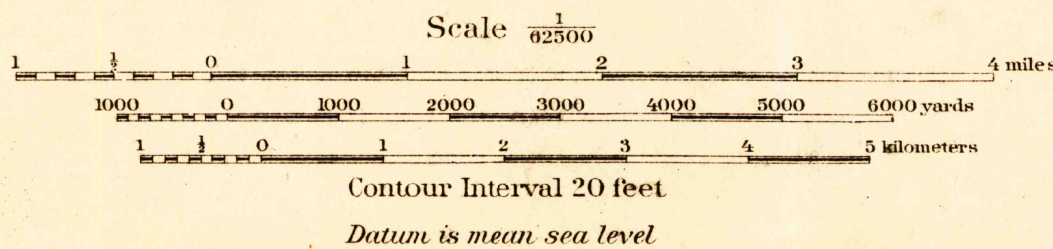

Base map from U.S.G.S. engravings.  
Corrections and additions by Department  
Engineer, Eastern Department.  
Additional field work and compilation under the direction  
of Col. H. Taylor, Corps of Engineers, U. S. A.  
Department Engineer, Eastern Department.  
Additional field work by 1st Lieuts. W.W. Rose, C. A. C.  
1st Lieut. David H. Scott, 2nd Lieuts. Paul D. Carlisle of  
the 5th Cavalry, 2nd Lieut. J. M. Eager, 3rd Field Artillery.  
Nov. 1915

Reprint E. R. P. 1921



NOTE: OFFICERS USING THIS MAP WILL MARK HEREON CORRECTIONS AND ADDITIONS WHICH COME  
TO THEIR ATTENTION AND MAIL DIRECT TO "THE CHIEF OF ENGINEERS, WASHINGTON, D. C."

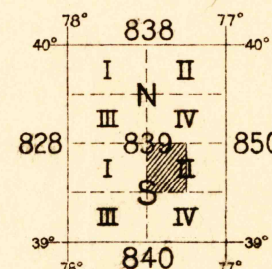

APPROXIMATE MEAN  
DECLINATION 1920

Board of Surveys & Maps  
FILE COPY  
Map Information Office  
RECEIVED  
FEB 15 1921  
Map Information Office

(Now Frederick)  
Maryland

IJAMSVILLE