

DEPARTMENT OF THE INTERIOR
U. S. GEOLOGICAL SURVEY

Advance sheet
Subject to correction

MAINE
ALLAGASH QUADRANGLE

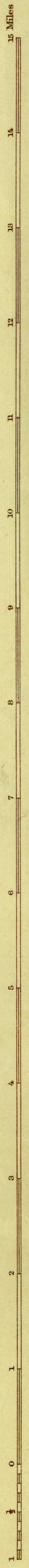

2 800 000
YARDS

St. Francis

Albert Pike, Division Engineer
Topography by T. T. Ranney, S. L. Parker, J. G. Groninger,
W. H. Austin, C. H. Price, J. L. Watkins, H. F. Ewing and Clayton Chase
Control by U. S. Geological Survey and
International Boundary Commission
Surveyed in 1930

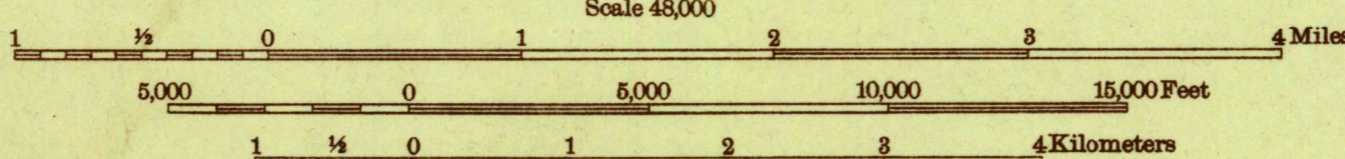

Contour interval 20 feet
Datum is mean sea level

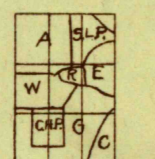

APPROXIMATE MEAN
DECLINATION, 1980

Polyconic projection. North American datum
5000 yard grid based upon U. S. zone system, A

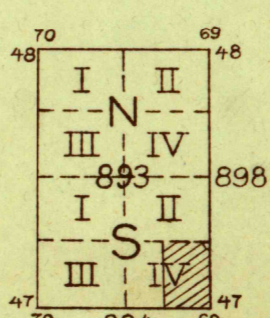

FILE COPY

RETURN TO CENTRAL FILE

ALLAGASH, ME.

NOT REMOVE