

This sheet must not be taken from the files without an order from the Chief Topographic Engineer.

TOPOGRAPHIC FILES

DEPARTMENT OF THE INTERIOR
U. S. GEOLOGICAL SURVEY

899-N-11-W/2
STATE OF MAINE
PUBLIC UTILITIES COMMISSION
ALBERT J. STEARNS, CHAIRMAN
HERBERT W. TRAFLET, ALBERT GREENLAW, COMMISSIONERS
(Square Lake)

Advance sheet
Subject to correction

MAINE
(AROOSTOOK COUNTY)
PORTAGE QUADRANGLE



15 Miles
14
13
12
11
10
9
8
7
6
5
4
3
2
1
0
1
2
3
4
5
6
7
8
9
10
11
12
13
14
15

2 775 000
YARDS

1 380 000
YARDS

Albert Pike, Division Engineer
Topography by R.F. Wilcoxon, H.B. Smith, T.T. Ranney,
Paul Bleke, A.G. England, C.H. Price, G.E. Hamond
and B.H. Yeaman
Control by U.S. Geological Survey and
U.S. Coast and Geodetic Survey
Surveyed in 1929

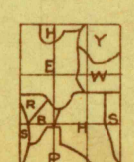

APPROXIMATE MEAN
DECLINATION, 1929

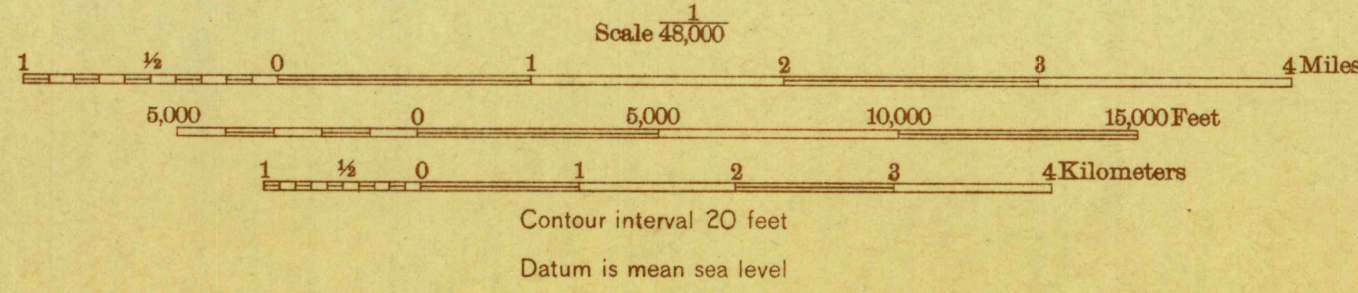

Polyconic projection. North American datum
5000 yard grid based upon U. S. zone system, A.

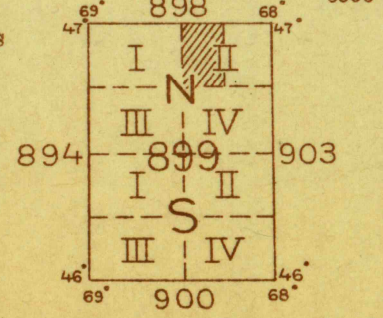

FILE COPY
RETURN TO CENTRAL FILE
PORTAGE, ME.