

69°00' 47'15" 55' 50' 68°45' 47'15"

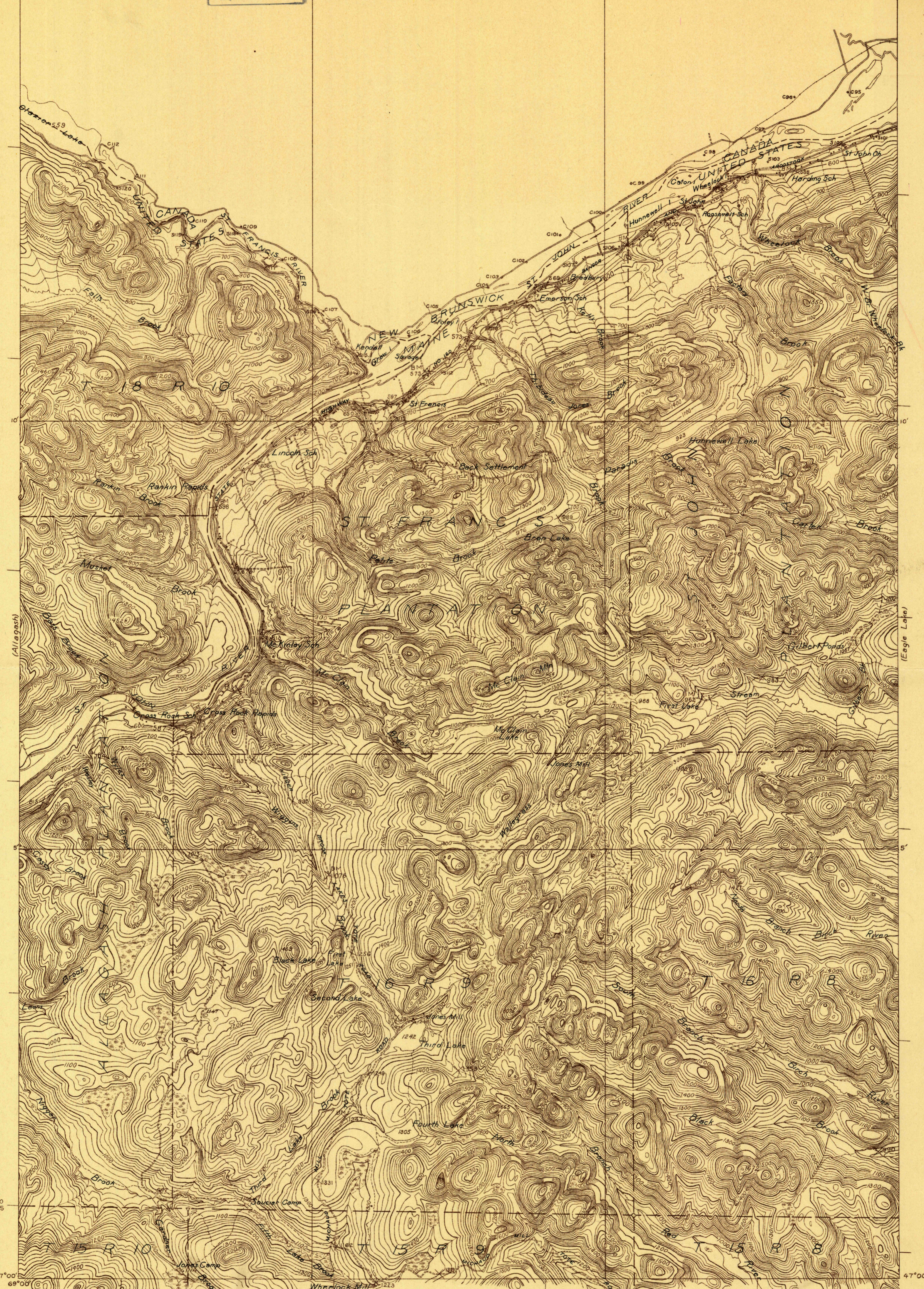

2 800 000  
YARDS

Albert Pike, Division Engineer, 1:335,000 YARDS  
Topography by K.W. Trimble, E.V. Holloway,  
J.L. Watkins, H.F. Ewing, H.D. Cummings,  
W.E. Bishop and International Boundary Commission  
Control by U. S. Geological Survey and  
International Boundary Commission  
Surveyed in 1930



APPROXIMATE MEAN  
DECLINATION, 1930

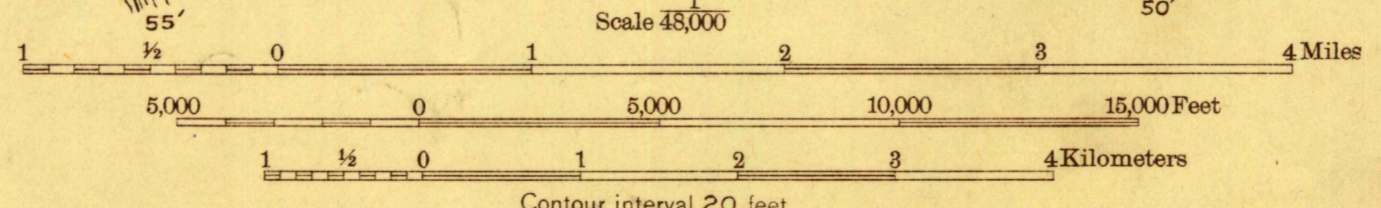

Contour interval 20 feet  
Datum is mean sea level

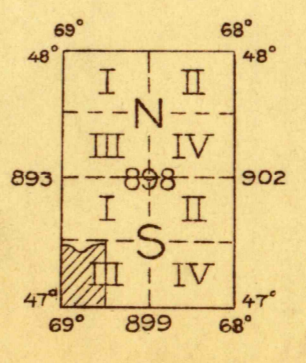

Polyconic projection - North American datum  
5000 yard grid based upon U. S. zone system, A

**FILE COPY**  
Inspection and Editing.

ST. FRANCIS, ME.

68°45' (Winterville)