

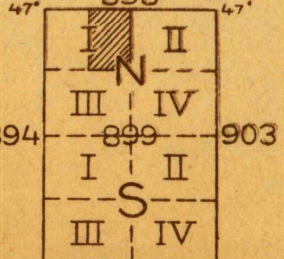

15 Miles
14
13
12
11
10
9
8
7
6
5
4
3
2
1
0
-1
-2

Glenn S. Smith, Division Engineer
Topography by Fred Graff, Jr., R. J. Belton,
J. O. Kilmartin, H. B. Smith, B. P. Taylor,
R. G. Carpenter, D. H. Bassett, and J. H. Lycett
Control by U. S. Geological Survey and
U. S. Coast and Geodetic Survey
Surveyed in 1928

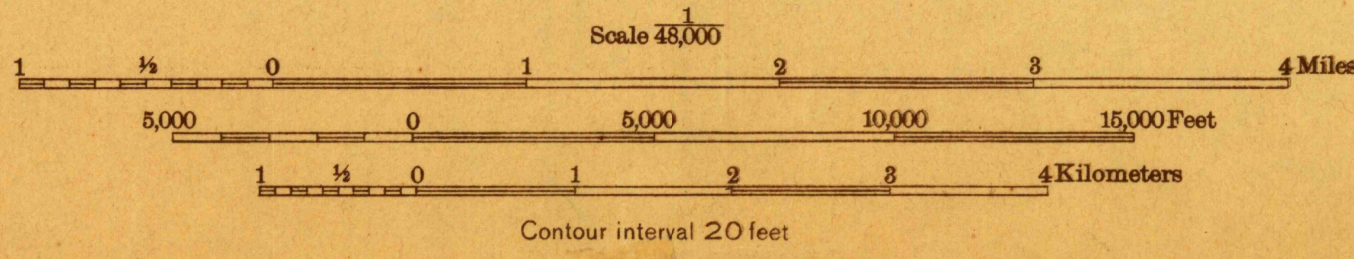
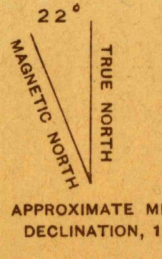

HISTORICAL FILES
Polyconic projection, with Albers conic
5000 yard grid based on U. S. zone system, A
FILE COPY (DO NOT REMOVE)
RETURN TO CENTRAL FILE
WINTERVILLE, ME.