

68°15' (Stockholm)



FT. KENT 30 MI.
WINTERVILLE 9 MI.

2775 000
YARDS

46°45'

Topography by R.F. Wilcox, H.B. Smith, T.T. Ranney,
Paul Blake, and A.G. England
Control by U.S. Geological Survey and
U.S. Coast and Geodetic Survey
Surveyed in 1929

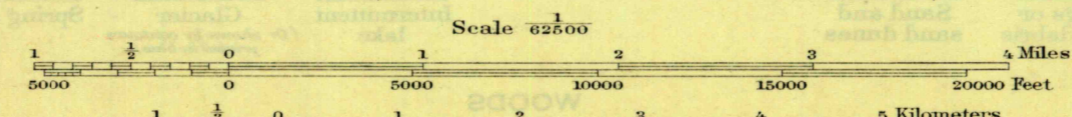
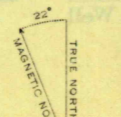

Scale 62500
Contour interval 20 feet
Datum is mean sea level

HISTORICAL FILES

HARD IMPERVIOUSLY SURFACED ROADS
OTHER MAIN TRAVELED ROADS
(DO NOT REMOVE)

**SURFACE WATER BRANCH
SPECIAL REPORTS SECTION**

PORTAGE, ME.
Edition of 1931