

(FORT KENT)
68°30'
47°15'

(FRENCHVILLE)

MADAWASKA 8 MI.
FRENCHVILLE (JUNC. U.S. 1) 2 MI.

GRAND ISLE
68°15'
47°15'

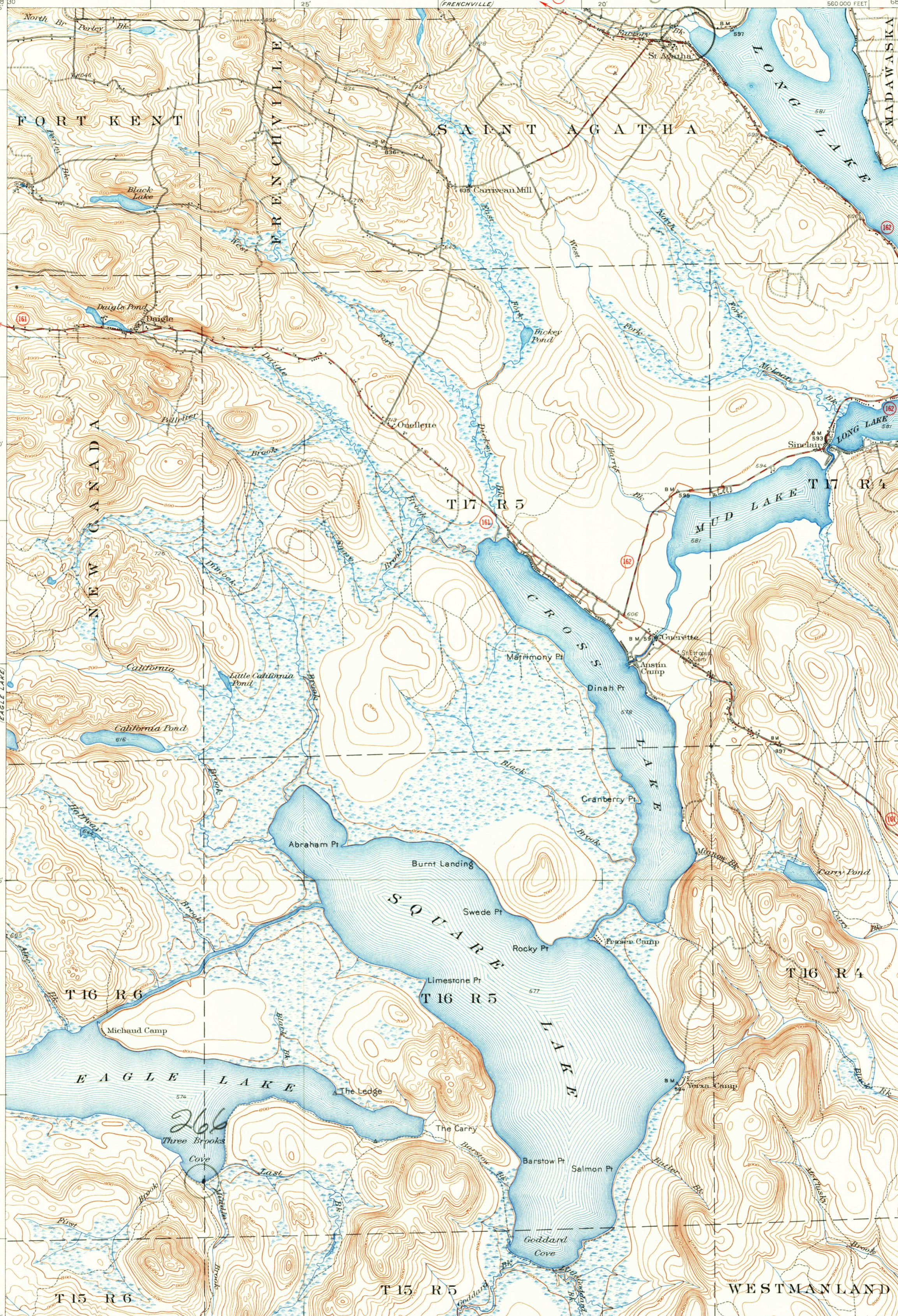

MADAWASKA 30 MI.
FT. KENT (JUNC. U.S. 1) 10 MI.

EAGLE LAKE

116000
FEET

47°00'
68°30'

(WINTERVILLE)

Mapped, edited, and published by the Geological Survey
Control by USGS, USCBGS, and International Boundary Commission
Topography by plane-table surveys 1927, Revised 1953
Polyconic projection, 1927 North American datum
10,000-foot grid based on Maine coordinate system,
east zone

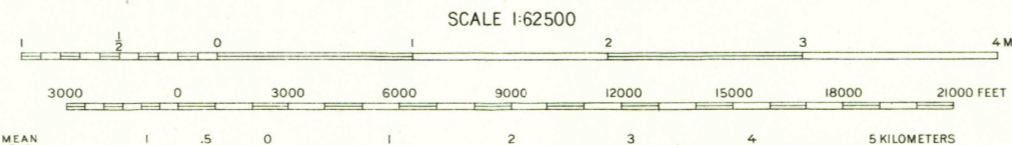
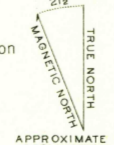

CONTOUR INTERVAL 20 FEET
DATUM IS MEAN SEA LEVEL

THIS MAP COMPLIES WITH NATIONAL MAP ACCURACY STANDARDS
FOR SALE BY U. S. GEOLOGICAL SURVEY, WASHINGTON 25, D. C.
A FOLDER DESCRIBING TOPOGRAPHIC MAPS AND SYMBOLS IS AVAILABLE ON REQUEST

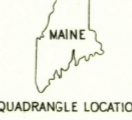

QUADRANGLE LOCATION

ROAD CLASSIFICATION

Heavy-duty	4 LANE 16 LANE	Light-duty
Medium-duty	4 LANE 16 LANE	Unimproved dirt
U. S. Route		State Route

SQUARE LAKE, ME.
N4700-W6815/15
1953

RT-F FILE COPY

1060
5780
400

1060
5780
400