

Seney SW

DEPARTMENT OF THE INTERIOR
U. S. GEOLOGICAL SURVEY

STATE OF MICHIGAN
DEPARTMENT OF CONSERVATION
GEO. R. HOGARTH, DIRECTOR
GEOLOGICAL SURVEY DIVISION, R. A. SMITH, STATE GEOLOGIST

Advance sheet
Subject to correction

U. S. G. S.
FILE COPY
MICHIGAN
BLANEY QUADRANGLE
NE QUARTER



Glenn S. Smith, Division Engineer
Compiled in part from aerial photographs
taken by Air Corps. U. S. Army
Control by U. S. Geological Survey
Surveyed in 1931

2°
TRUE NORTH
MAGNETIC NORTH
APPROXIMATE MEAN
DECLINATION, 1931

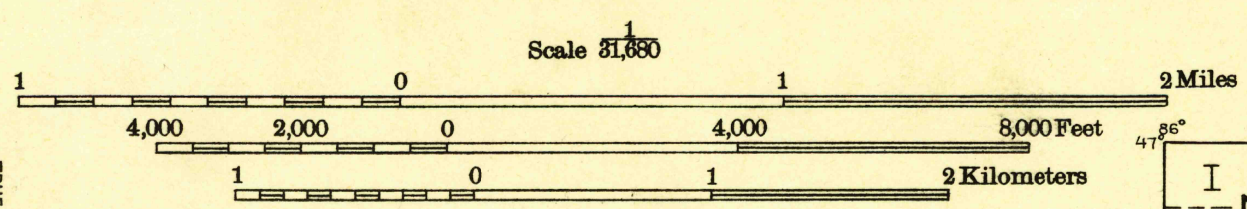

Polyconic projection. North American datum

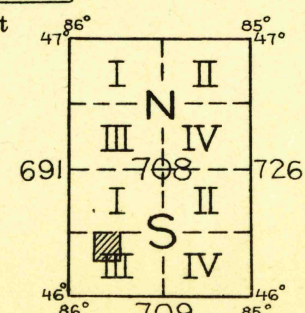

USGS
Historical File
Topographic Division

BLANEY, MICH
NE'

Gould City NW
Gould City SW