

DEPARTMENT OF THE INTERIOR
U. S. GEOLOGICAL SURVEY

STATE OF MICHIGAN
DEPARTMENT OF CONSERVATION
GEO. F. HOGARTH, DIRECTOR
GEOLOGICAL SURVEY DIVISION, R. A. SMITH, STATE GEOLOGIST
(Manistique River)

Advance sheet
Subject to correction

MICHIGAN
(SCHOOLCRAFT COUNTY)
MANISTIQUE QUADRANGLE

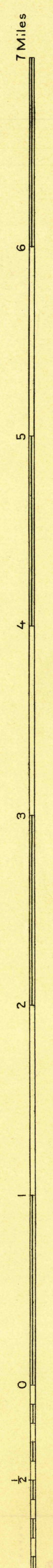
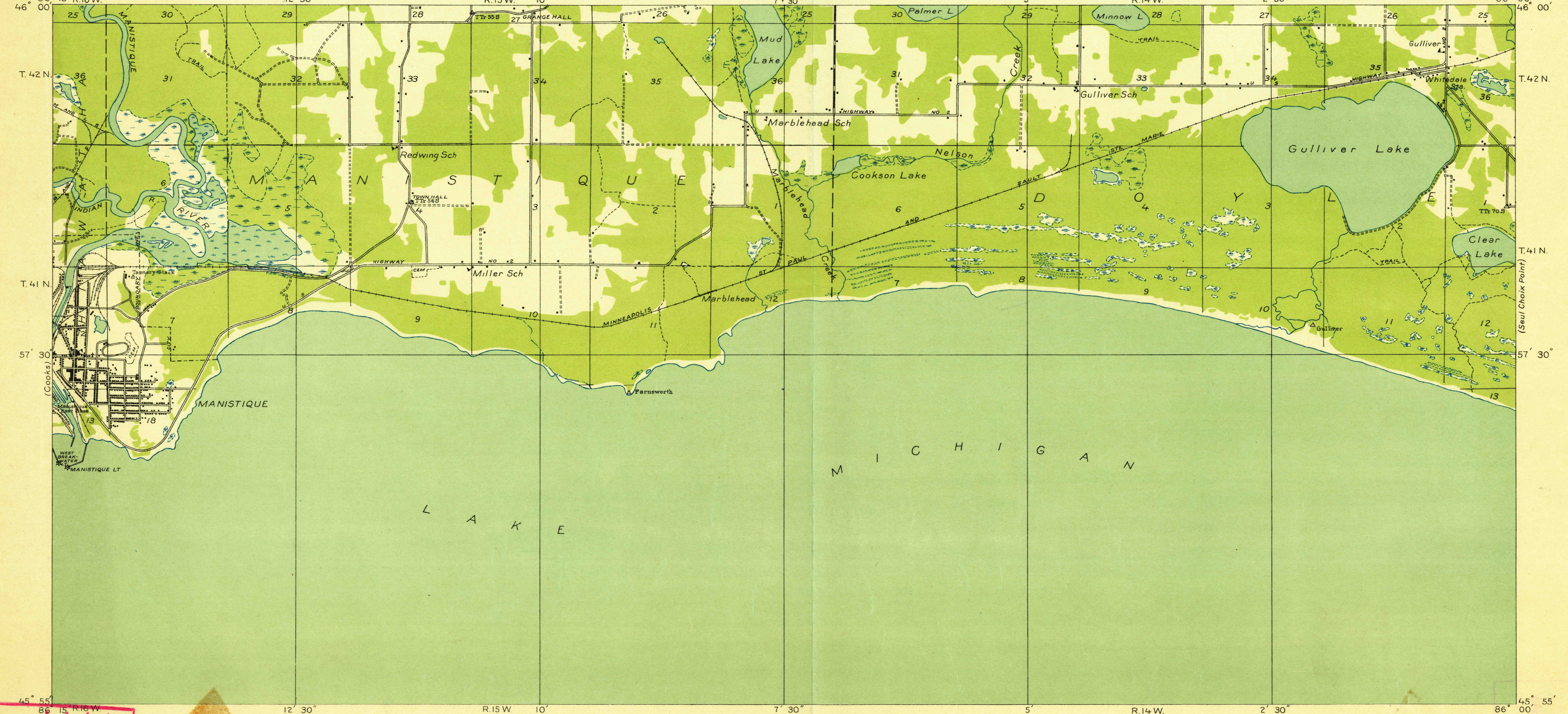

U.S. GEORGRAPHICAL NAMES
M6300 1689
Glenn S. Smith, Division Engineer
Compiled in part from aerial photographs
taken by Air Corps U. S. Army
Control by U. S. Geological Survey and U.S. Lake Survey
Surveyed in 1933

TRUE NORTH
MAGNETIC NORTH
APPROXIMATE MEAN
DECLINATION, 1981

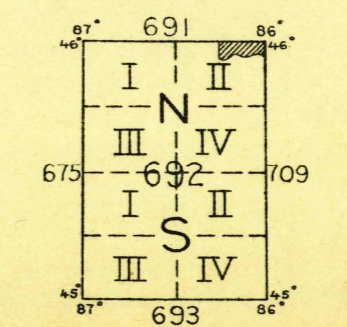
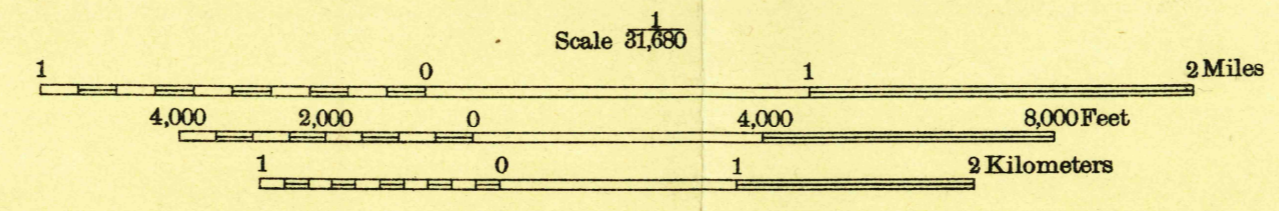

U. S. Board on
Geographical Names

MANISTIQUE, MICH.