

BOARD OF SURVEYS & MAPS  
 RECEIVED  
 NOV 22 1920  
 Map Information Office

FINAL SHEET  
 762-S-1-W $\frac{1}{2}$

CONFIDENTIAL

MICHIGAN  
 GROSSE POINTE QUADRANGLE

No military notes  
 accompany this map.

*U.S. Geol. Survey  
 Atlas Sheet*

*No credit given*



DOMINION OF CANADA

Survey and drafting under the direction of  
 Lieut. Col. George A. Zinn, Corps of Engineers, U.S. A.  
 Department Engineer, Central Division.  
 Field work under the immediate supervision of  
 2<sup>nd</sup> Lieut. William A. Beach, 23<sup>rd</sup> Infantry, 1912.  
 Map drawn in 1913.

SURVEYED IN COOPERATION WITH THE STATE OF MICHIGAN.  
 Additions by G. A. Hussey, Jr. Engr. Nov. 1913.  
 Partial office revision made by Lake Survey Dec. 1918.

- Road Legend
- A Excellent Concrete or Asphalt
  - B Poor Concrete or Macadam
  - C Excellent Dirt
  - D Medium Dirt
  - Roads not lettered - Fair country dirt.

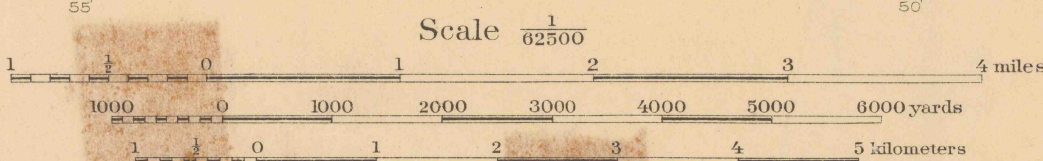

Contour Interval 20 feet  
 Datum is mean sea level

NOTE: OFFICERS USING THIS MAP WILL MARK HEREON CORRECTIONS AND ADDITIONS WHICH COME TO THEIR ATTENTION AND MAIL DIRECT TO "THE CHIEF OF ENGINEERS, WASHINGTON, D. C."

Reproduction by U.S. Lake Survey Office, Detroit, Mich.

Telegraph and Telephone Lines on all Rail Roads and Main Roads.  
 Dimensions of Bridges shown as follows:  
 Length X Height above water.

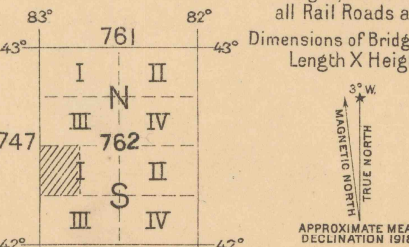

GROSSE POINTE  
 Mich.

*E.S.O.*