

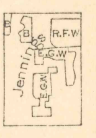

C.H. Birdseye, Chief Topographic Engineer.
W.H. Herron, Division Topographic Engineer.
Topography by J.H. Jennings, R.F. Wilcox,
E.G. Wingate, and E.C. Burt.
Control by U.S. Coast and Geodetic Survey, J.R. Ellis,
H.S. Senseney, R.B. Steele, and E.C. Bibbee.
Surveyed in 1920-1921.



Scale 1:25,000
Miles
Kilometers

Contour interval 10 feet.
Datum is mean sea level.

APPROXIMATE MEAN
DECADATION, 1921

Polyconic projection, North American datum.
5000 yard grid based upon U.S. zone system, S.

MARSHALL, MICH.
Edition of 1923.

SURVEYED IN COOPERATION WITH THE STATE OF MICHIGAN.