

UNITED STATES
DEPARTMENT OF THE INTERIOR
GEOLOGICAL SURVEY

STATE OF MINNESOTA
DEPARTMENT OF CONSERVATION

BREWSTER QUADRANGLE
MINNESOTA
7.5 MINUTE SERIES (TOPOGRAPHIC)

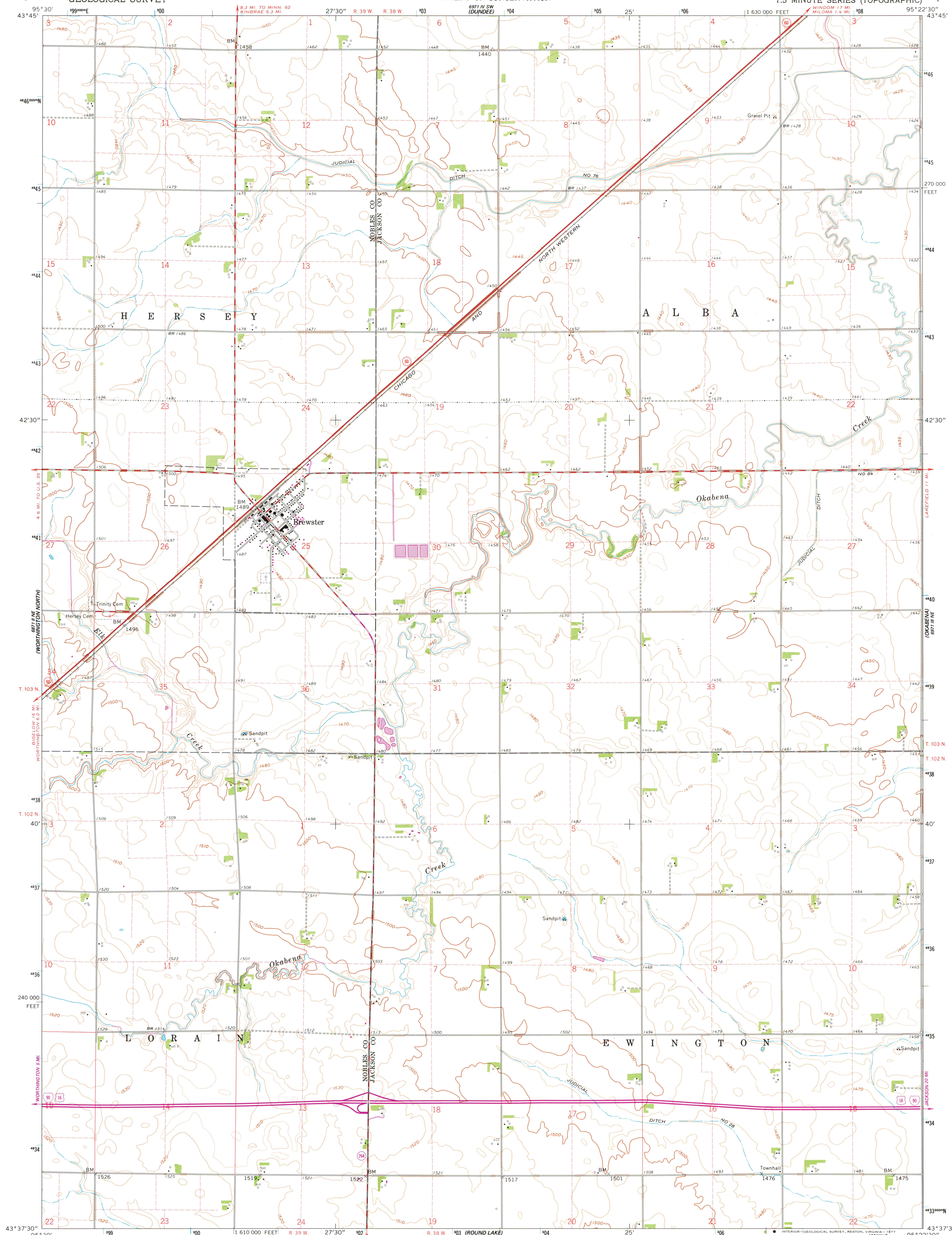

Maped, edited, and published by the Geological Survey
Control by USGS and USC&GS
Topography from aerial photographs by photogrammetric methods
Aerial photographs taken 1958. Field check 1960
Polyconic projection. 1927 North American datum
10,000-foot grid based on Minnesota coordinate system, south zone
1000-meter Universal Transverse Mercator grid ticks,
zone 15, shown in blue
Fine red dashed lines indicate selected fence and field lines where
generally visible on aerial photographs. This information is unchecked
Revisions shown in purple compiled from aerial photographs
taken 1976. This information not field checked

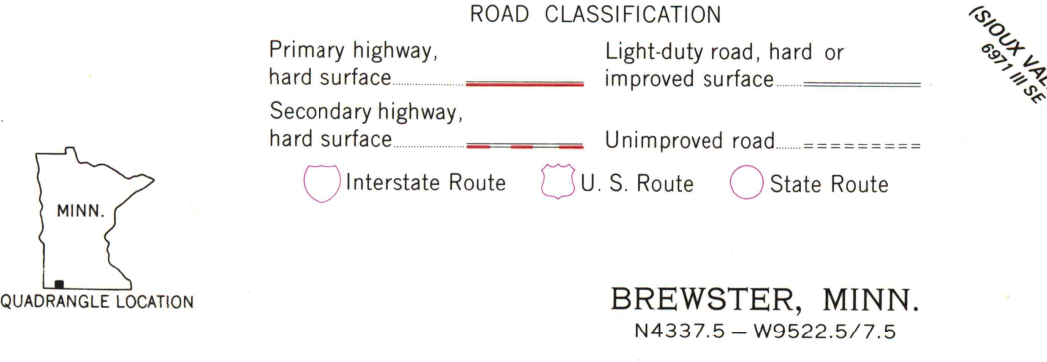
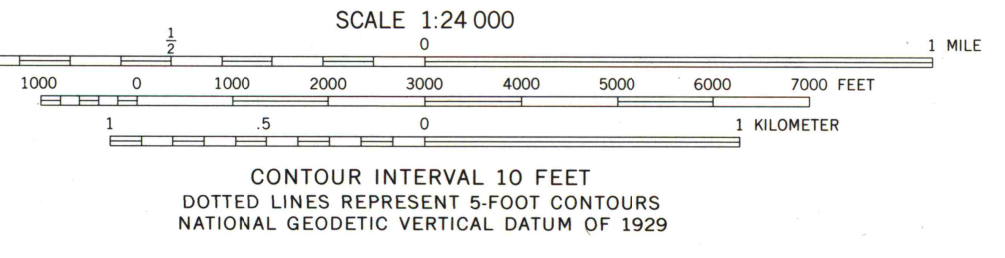
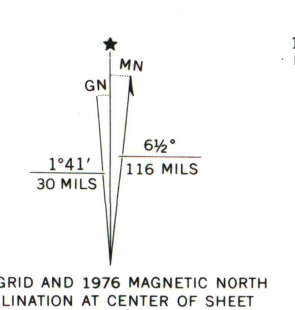

BREWSTER, MINN.
N4337.5 - W9522.5/7.5

MAP AND AIR PHOTO
LIBRARY

SEP 22 1978

University of Wisconsin
Madison