

TOPOGRAPHY

STATE OF MINNESOTA

A.O. EBERHART, GOVERNOR
SAMUEL G. IVERSON, STATE AUDITOR
JULIUS A. SCHMAHL, SEC. OF STATE
GEORGE A. RALPH, CHIEF ENGINEER

MINNESOTA
(OTTER TAIL COUNTY)
BATTLE LAKE QUADRANGLE

U.S. GEOLOGICAL SURVEY
GEORGE OTIS SMITH
DIRECTOR



F.B. Marshall, Chief Geographer.
W.H. Herron, Geographer in charge.
Topography by C.L. Sadler,
O.H. Nelson, F.B. Barrett, and W.A. Reiter.
Control by C.B. Kendall and J.M. Ray.
Surveyed in 1911-1912.

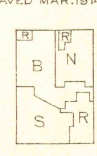

Scale 62500
0 1 2 3 4 Miles
0 1 2 3 4 5 Kilometers
Contour interval 10 feet.
Datum is mean sea level.

APPROXIMATE MEAN
DECLINATION 1912

Edition of Aug. 1914.
BATTLE LAKE



Readjustment of levels indicates that elevations on this map are one foot too high.