

(Greenbush)

CORPS OF ENGINEERS, U.S. ARMY
PROGRESSIVE MILITARY MAP

ADVANCE SHEET 516-S-I-W/2 (Garland)

NOT MAPPED BY U.S.G.
PRIOR TO 1921

MINNESOTA
(MARSHALL COUNTY)
ROLLIS QUADRANGLE

(Pencer)

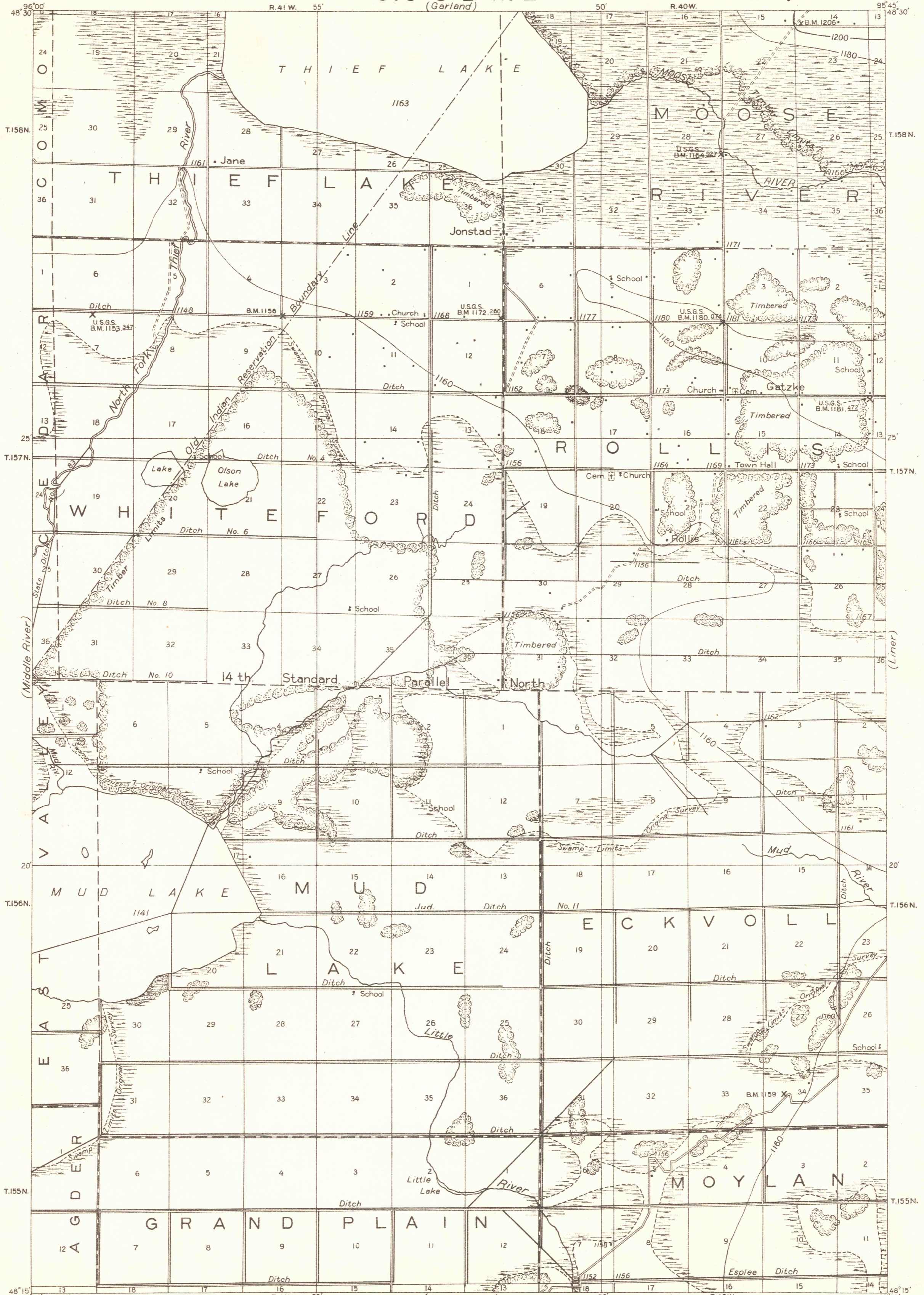

Compiled in office of Department
Engineer, Central Department, 1918.

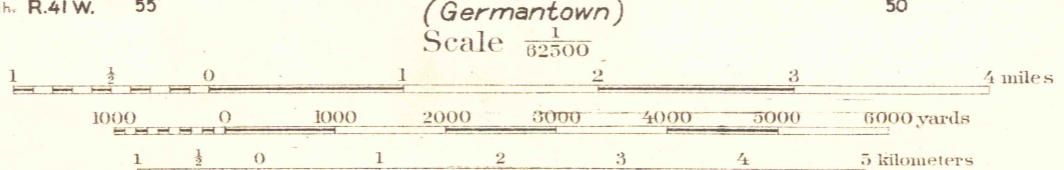

Contour Interval 20 feet
Datum is mean sea level

NOTE: OFFICERS USING THIS MAP WILL MARK HEREON CORRECTIONS AND ADDITIONS WHICH COME TO THEIR ATTENTION AND MAIL DIRECT TO "THE CHIEF OF ENGINEERS, WASHINGTON, D.C."

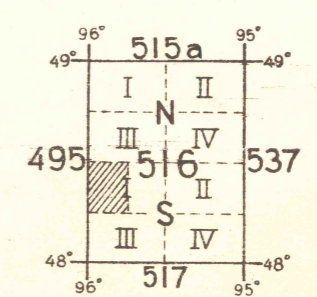

APPROXIMATE MEAN
DECLINATION 1918

ROLLIS, MINN.