

(Quiring)

CORPS OF ENGINEERS, U. S. ARMY
PROGRESSIVE MILITARY MAP

ADVANCE SHEET
538-N-IV-W/2
(Bridgie)

MINNESOTA
ROSY QUADRANGLE

*Not mapped
by USGS*

(Gemmell)

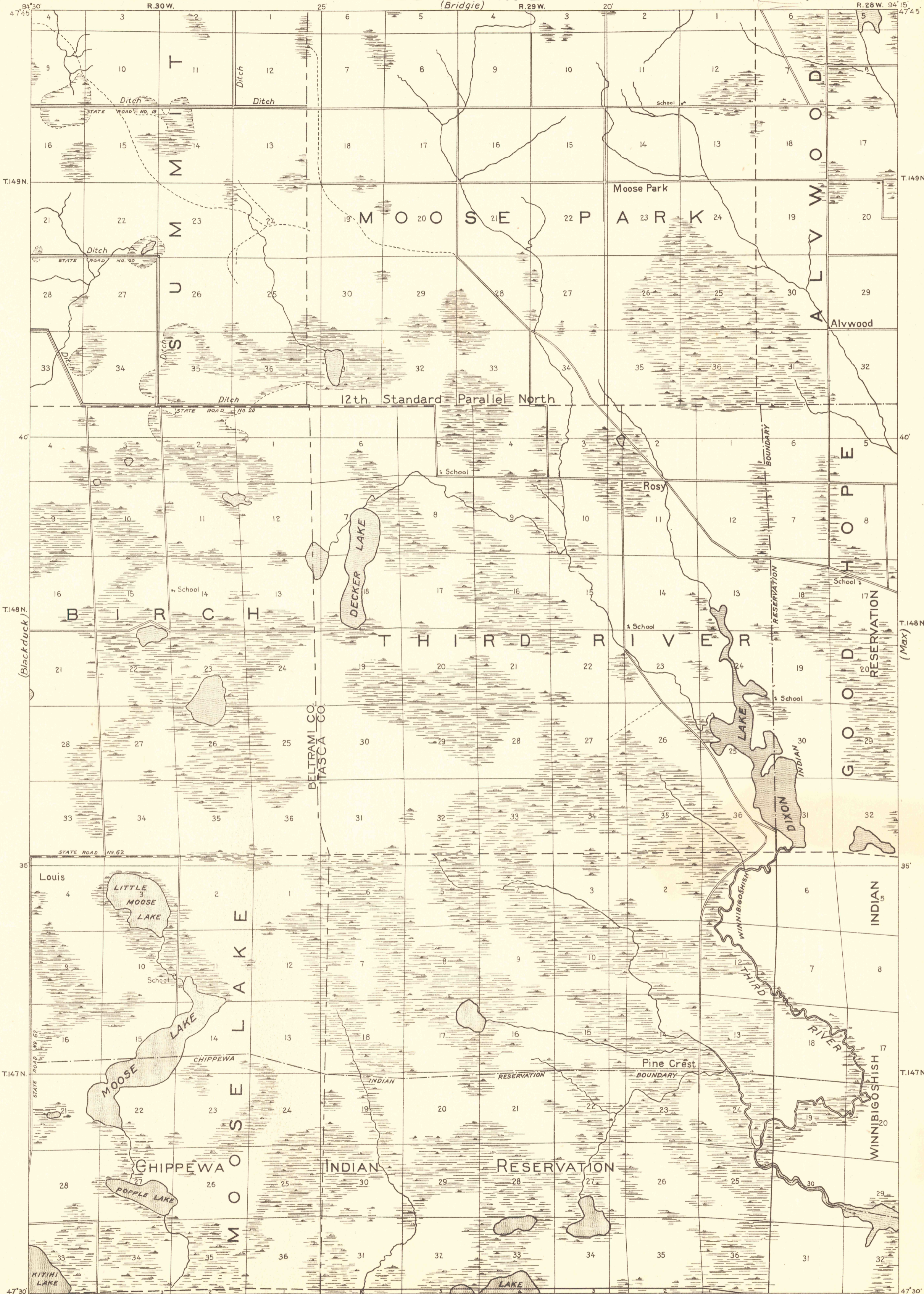

Compiled in office of Department Engineer, Central Department, in 1919 from the following sources:
Original Land Plats, Map of Beltrami County, Minnesota, compiled in 1913 by E. J. Bourgeois, C. E., Bemidji, Minn. Revised to 1917. Itasca County, Minnesota. The Land O'Lakes, corrected to August, 1918. Beltrami County Ditch map of Minnesota, by R. K. Biller, County Surveyor, September, 1918. W. H. Hixson & Co. State Atlas of Minnesota, 1915. Sectional map of Itasca County, Minnesota, compiled from latest Government Surveys and other authentic sources, published by Jewett & Son, St. Paul, Minnesota, 1905. U. S. Census Bulletin, 1910. Post Route Map of State of Minnesota, and Postal Guide.

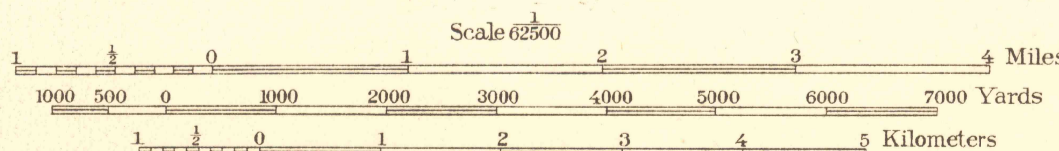

Datum is mean sea level.

NOTE: OFFICERS USING THIS MAP WILL MARK HEREON CORRECTIONS AND ADDITIONS WHICH COME TO THEIR ATTENTION AND MAIL DIRECT TO THE CHIEF OF ENGINEERS, WASHINGTON, D.C.

Engineer Reproduction Plant, U. S. Army, Washington Barracks, D. C. R. 28 W. 94 15
December 1919

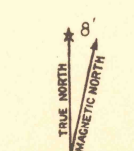
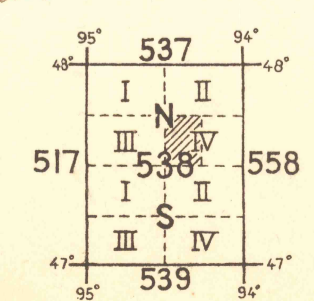

APPROXIMATE MEAN DECLINATION 1919

ROSY, MINN