

(Marcell)

# ADVANCE SHEET 558-S-II-W/2

MINNESOTA  
ITASCA COUNTY  
TROUT LAKE QUADRANGLE

CORPS OF ENGINEERS, U. S. ARMY  
PROGRESSIVE MILITARY MAP  
R. 25 W.

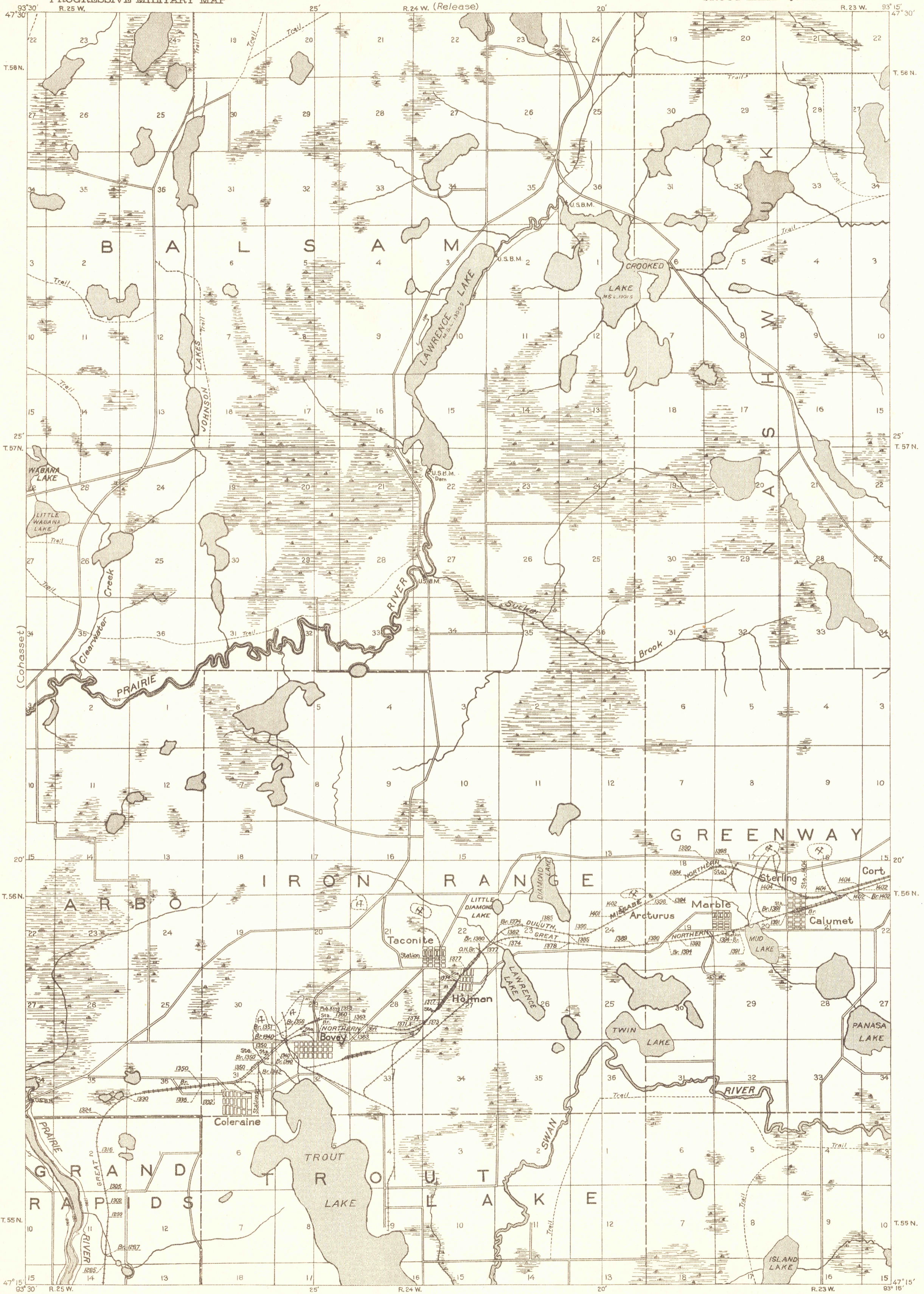

Compiled in office of Department Engineer, Central Department, in 1919 from the following sources:  
Original Land Plats: Duluth, Missabe and Northern Railroad and the Great Northern Railroad Profiles and Right of Way Maps, Sectional Map of Itasca County, Minnesota, published by Jewett & Son, St. Paul, Minn., 1910. Itasca County Minnesota, the Land O'Lakes Map by O. J. Lidberg, Supt. Highways, corrected to August, 1918. W. W. Hixson & Co., State Atlas of Minnesota, 1915. Survey of Prairie River and Lawrence Lake, 1911, in Atlas accompanying Report of Water Resources Investigation of Minnesota, 1909-1913, U. S. Census Bulletin, 1910. Post Route map of State of Minnesota and Postal Guide.

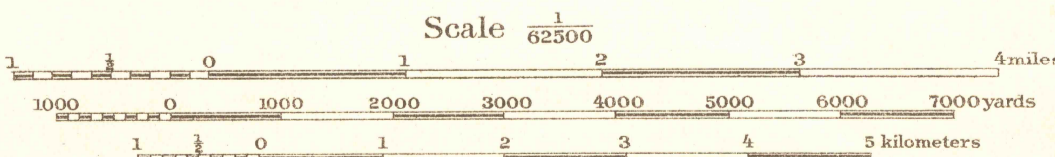

Contour Interval 20 feet  
Datum is mean sea level

NOTE: OFFICERS USING THIS MAP WILL MARK HEREON CORRECTIONS AND ADDITIONS WHICH COME TO THEIR ATTENTION AND MAIL DIRECT TO THE CHIEF OF ENGINEERS, WASHINGTON, D. C.

Engineer Reproduction Plant, U. S. Army, Washington Barracks, D. C.

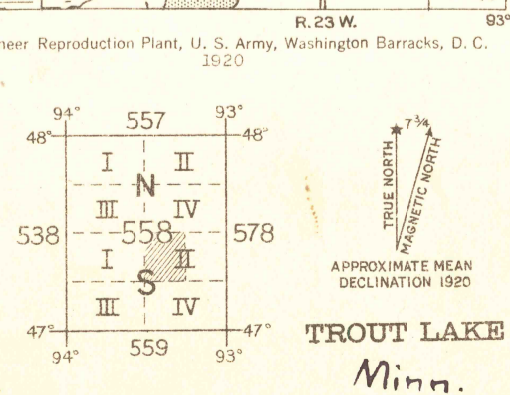

Board of Surveys & Maps  
FILE COPY  
Map Information Office

