

Advance sheet  
Subject to correction

U. S. G. S.  
**FILE COPY**  
Inspection and Editing.

DEPARTMENT OF THE INTERIOR  
U. S. GEOLOGICAL SURVEY

STATE OF MISSOURI  
GEOLOGICAL SURVEY AND WATER RESOURCES  
H. A. BUEHLER, STATE GEOLOGIST

MISSOURI  
**BAGNELL QUADRANGLE**  
R. 14 W.

(Tuscumbia 75000)

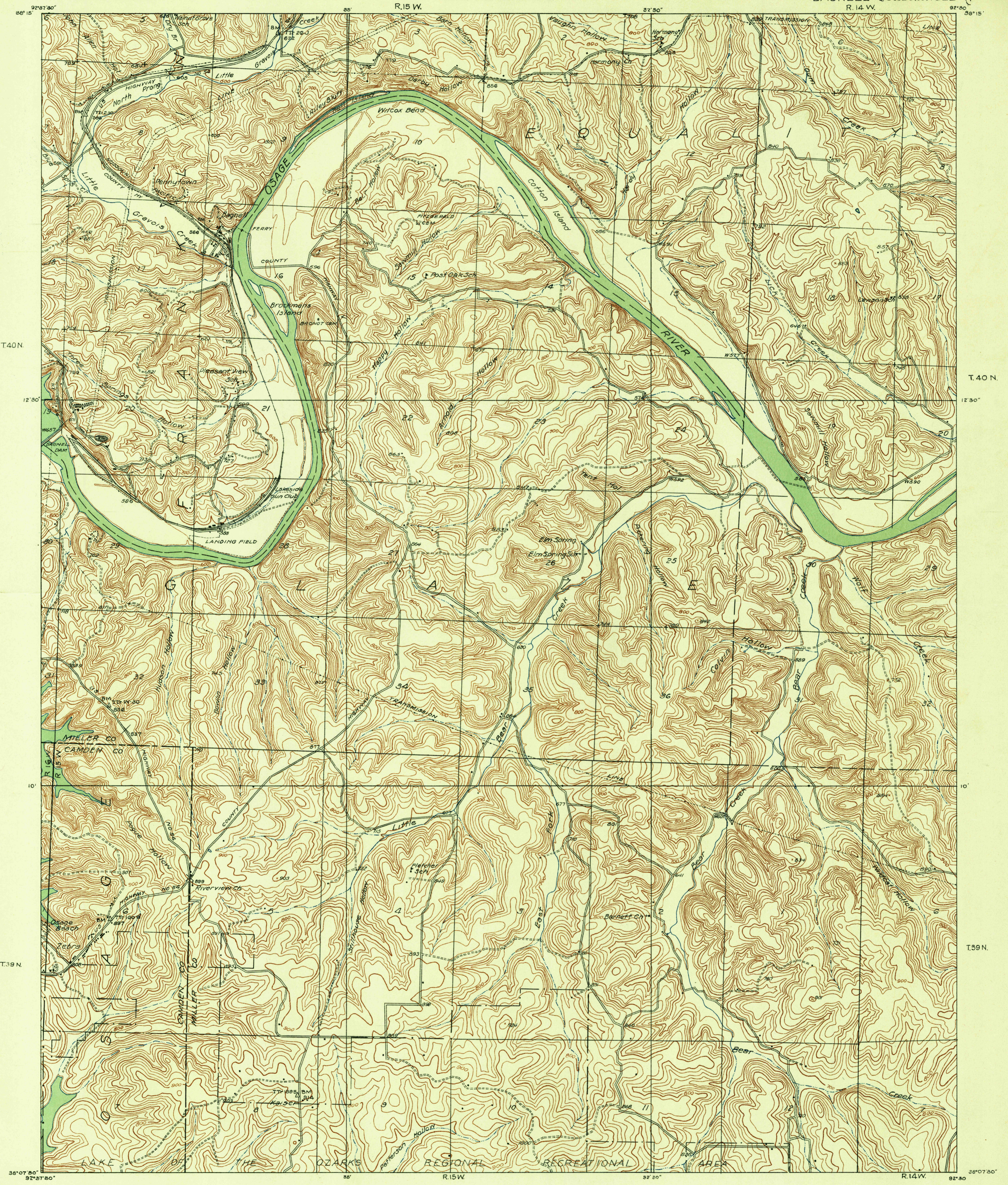

Glenn S. Smith, Division Engineer  
Topography by J. Bleachman and J. F. W. Smith.  
Control by U. S. Geological Survey  
and U. S. Coast and Geodetic Survey  
Surveyed in 1932-1934.

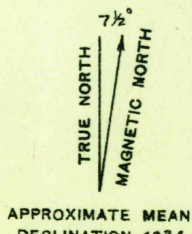

APPROXIMATE MEAN  
DECLINATION, 1954.

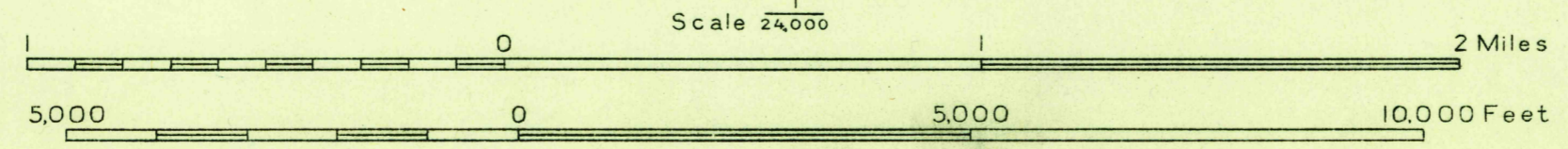

Contour interval 20 feet  
Datum is mean sea level

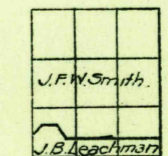

Polyconic projection. 1927 North American datum

USGS  
Historical File  
Topographic Division

**BAGNELL, MO.**