

KANSAS CITY 51 MI. UNITED STATES
 HIGGINSVILLE 8.5 MI.
 ODESSA 12 MI.
 DEPARTMENT OF THE INTERIOR
 GEOLOGICAL SURVEY

U.S.G.S.
 FILE COPY

STATE OF MISSOURI
 REPRESENTED BY THE
 GEOLOGICAL SURVEY AND WATER RESOURCES
 (Lexington 1:50,000)

MISSOURI
 KNOBPOSTER QUADRANGLE



R.B. Marshall, Chief Geographer.
 W.H. Heron, Geographer in charge.
 Topography by Frank W. Hughes and J.M. Rawls.
 Control by U.S. Coast and Geodetic Survey,
 E.L. McNair, and J.M. Rawls.
 Surveyed in 1915.
 Partial highway revision, 1949
 SURVEYED IN COOPERATION WITH THE STATE OF MISSOURI.

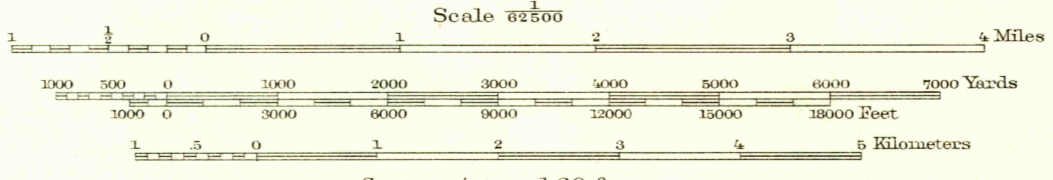
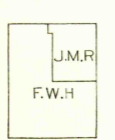

AIR BASE 1 MI.
 POLYCONIC PROJECTION.
 Edition of 1917, reprinted 1950
 with corrections

MO.
 KNOBPOSTER
 N3845-W9330/15

ROAD CLASSIFICATION
 HARD-SURFACE ALL WEATHER ROADS DRY WEATHER ROADS
 Heavy-duty ———— 4 LANE LANE Improved dirt ————
 Medium-duty ———— 4 LANE LANE Unimproved dirt ————
 Loose-surface, graded, or narrow hard-surface - - - - -
 U. S. Route State Route

Contour interval 20 feet
 Datum is mean sea level

USGS
 Historical File
 Topographic Division

Name changed to two words
 KNOBPOSTER