

Mapped, edited, and published by the Geological Survey
 Control by USGS, NOS/NOAA and Mississippi State Highway Department
 Topography by photogrammetric methods from aerial photographs taken 1975. Field checked 1978. Map edited 1982
 Projection and 10,000-foot grid ticks: Mississippi coordinate system, east zone (transverse Mercator)
 1000-meter Universal Transverse Mercator grid, zone 16
 1927 North American Datum
 To place on the predicted North American Datum 1983 move the projection lines 8 meters south and 6 meters east as shown by dashed corner ticks
 There may be private inholdings within the boundaries of the National or State reservations shown on this map
 Fine red dashed lines indicate selected fence and field lines where generally visible on aerial photographs. This information is unchecked

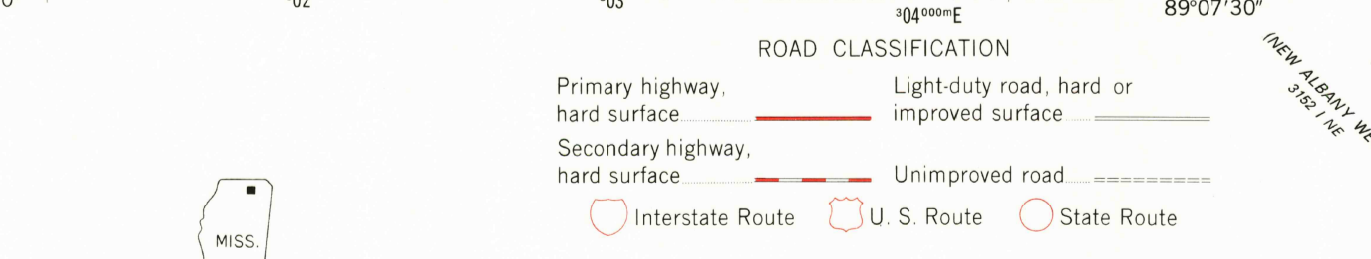

THIS MAP COMPLIES WITH NATIONAL MAP ACCURACY STANDARDS FOR SALE BY U. S. GEOLOGICAL SURVEY, RESTON, VIRGINIA 22092
 A FOLDER DESCRIBING TOPOGRAPHIC MAPS AND SYMBOLS IS AVAILABLE ON REQUEST

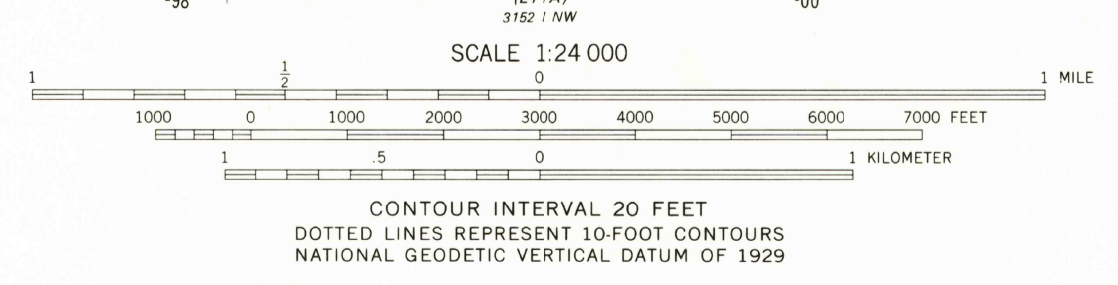
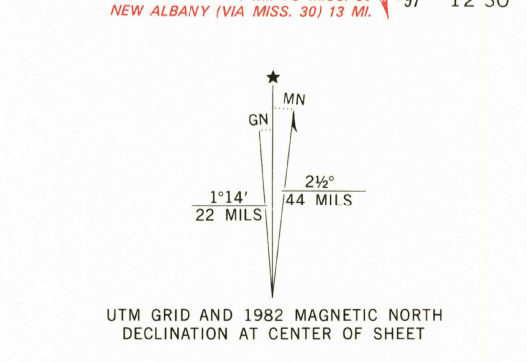

HICKORY FLAT, MISS.
 SW/4 BLUE MOUNTAIN 15' QUADRANGLE
 N3430-W8907.5/7.5
 1982
 DMA 3153 II SW-SERIES V843
 RETURN TO:
 USGS AND HISTORICAL MAP ARCHIVES

FEB 09 1982