

Produced by the United States Geological Survey
Planimetry by photogrammetric methods from imagery dated 1954
Topography by planimetric surveys 1958. Revised from imagery
dated 1989 and other sources. Field checked 1993. Map edited 1994
North American Datum of 1927 (NAD 27). Projection and
blue 1000-meter ticks: Universal Transverse Mercator, zone 16
10 000-foot ticks: Mississippi coordinate system, east zone
North American Datum of 1983 (NAD 83) is shown by dashed
corner ticks. The values of the shift between NAD 27 and NAD 83
for 7.5-minute intersections are obtainable from National Geodetic
Survey NADCON software.
There may be private inholdings within the boundaries of
the National or State reservations shown on this map

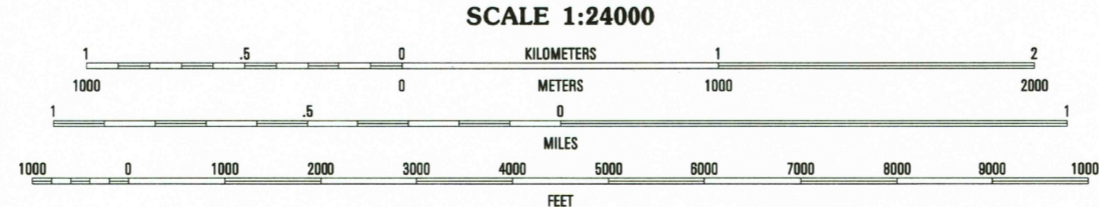

SCALE 1:24000
CONTOUR INTERVAL 5 FEET
NATIONAL GEODETIC VERTICAL DATUM OF 1929

THIS MAP COMPLIES WITH NATIONAL MAP ACCURACY STANDARDS
FOR SALE BY U.S. GEOLOGICAL SURVEY
DENVER, COLORADO 80225, OR RESTON, VIRGINIA 22092
A FOLDER DESCRIBING TOPOGRAPHIC MAPS AND SYMBOLS IS AVAILABLE ON REQUEST

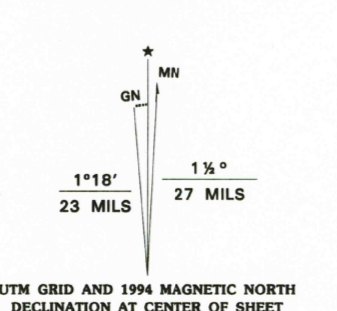
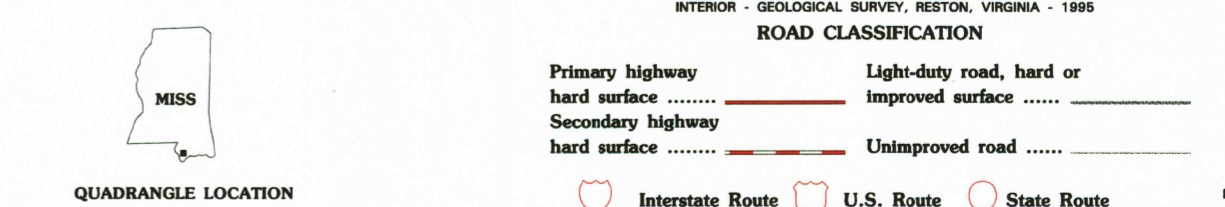

ADJOINING 7.5' QUADRANGLE NAMES

1	2	3	1 Nicholson
4	5	4 Haswood	2 Dead Tiger Creek
6	7	5 Waveland	3 Kilo
		6 Rigoleto	
		7 English Lookout	
		8 Saint Joe Pass	

USGS HISTORICAL
MAP ACQUISITION
OCT 31 1997
REC'D FILE COPY

LOGTOWN, MS
30089-CS-TF-024
1993
DMA 3044 I SE - SERIES 7843

