

DEPARTMENT OF THE INTERIOR
ALBERT B. FALL, SECRETARY
U. S. GEOLOGICAL SURVEY
GEORGE OTIS SMITH, DIRECTOR

STATE OF MISSISSIPPI
GEOLOGICAL SURVEY
E. N. LOWE, DIRECTOR

STATE OF LOUISIANA
J. T. MC CLELLAN, PRESIDENT BOARD OF COMMISSIONERS
FIFTH LOUISIANA LEVEE DISTRICT

MISSISSIPPI-LOUISIANA
NATCHEZ QUADRANGLE

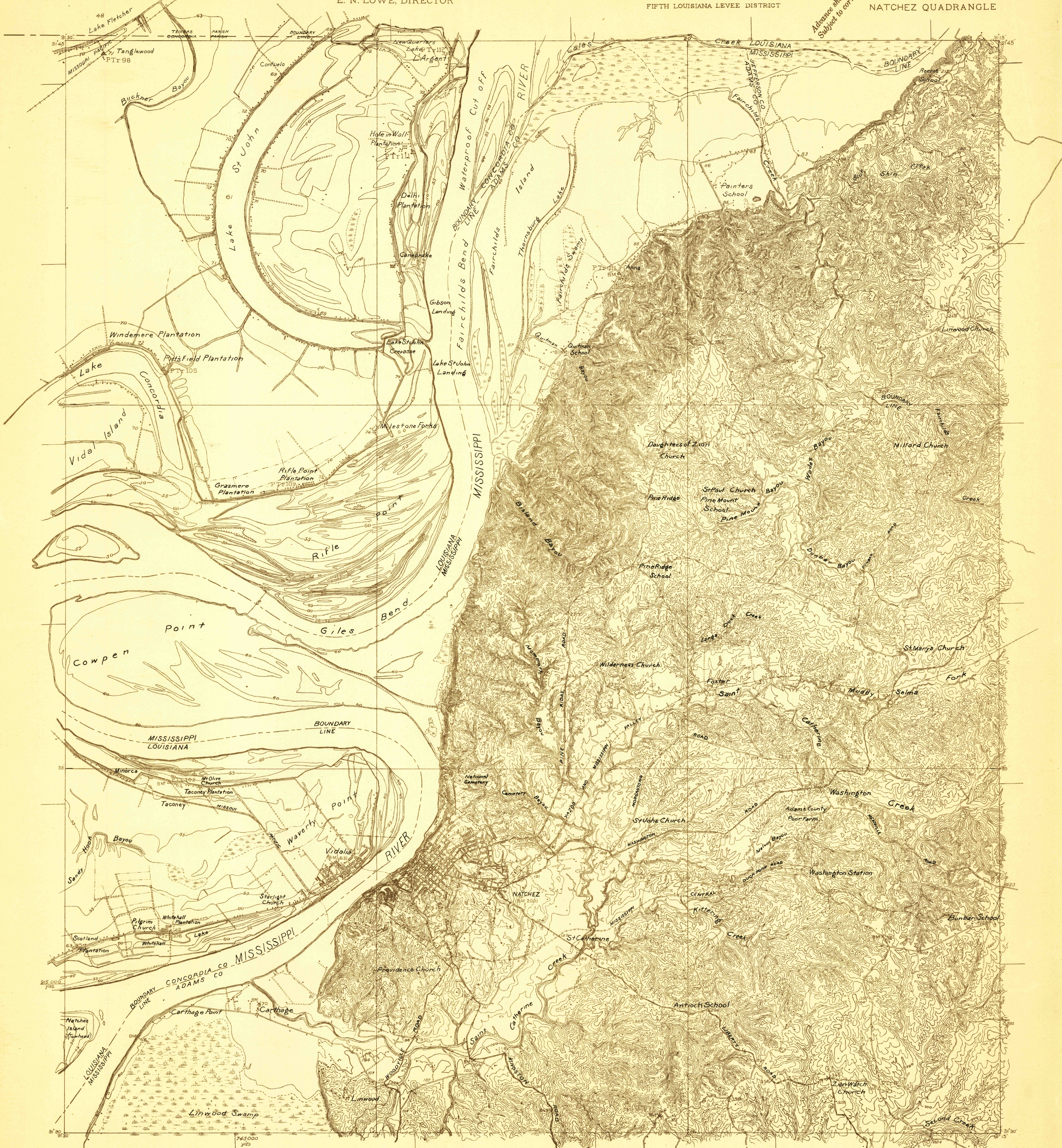

Advance sheet.
Subject to correction.

C. H. Birdseye, Chief Topographic Engineer
Frank Sutton, Division Topographic Engineer
Hersey Munroe, Topographic Engineer in charge
Topography by Mississippi River Commission,
E. I. Ireland, Roscoe Reeves, C. H. Davey, W. S. Beames,
C. R. DeMedicis, W. F. Chenault, E. V. Holmway,
Olinus Smith and H. W. Peabody.
Control by U.S. Corps of Engineers, U.S. Coast and
Geodetic Survey, J. R. Ellis, C. B. Kendall, H. S. Senseney
and T. A. Green.
Surveyed in 1909, 1916 and 1920.

Surveyed in Cooperation with the State of Mississippi,
and the Fifth Louisiana Levee District.

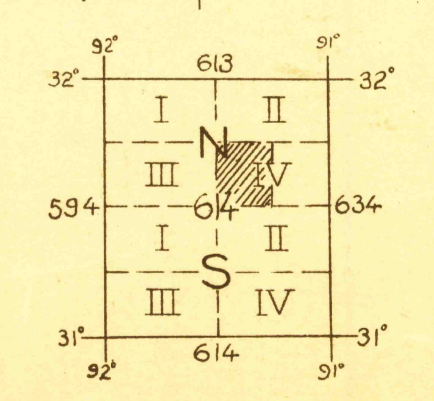
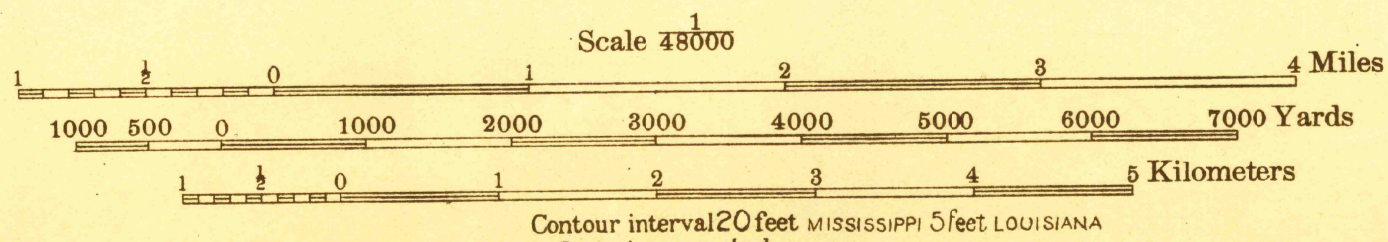
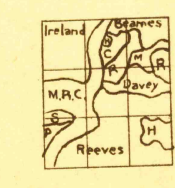

Polyconic projection, North American datum
APPROXIMATE MEAN
MAGNETIC NORTH
DECLINATION 1920

FILE COPY
RETURN TO CENTRAL FILE
NATCHEZ
Edition of 1921