

(Valley town)

CORPS OF ENGINEERS, U. S. ARMY
PROGRESSIVE MILITARY MAP

ADVANCE SHEET 287-S-W/2

MONTANA
GLASGOW QUADRANGLE

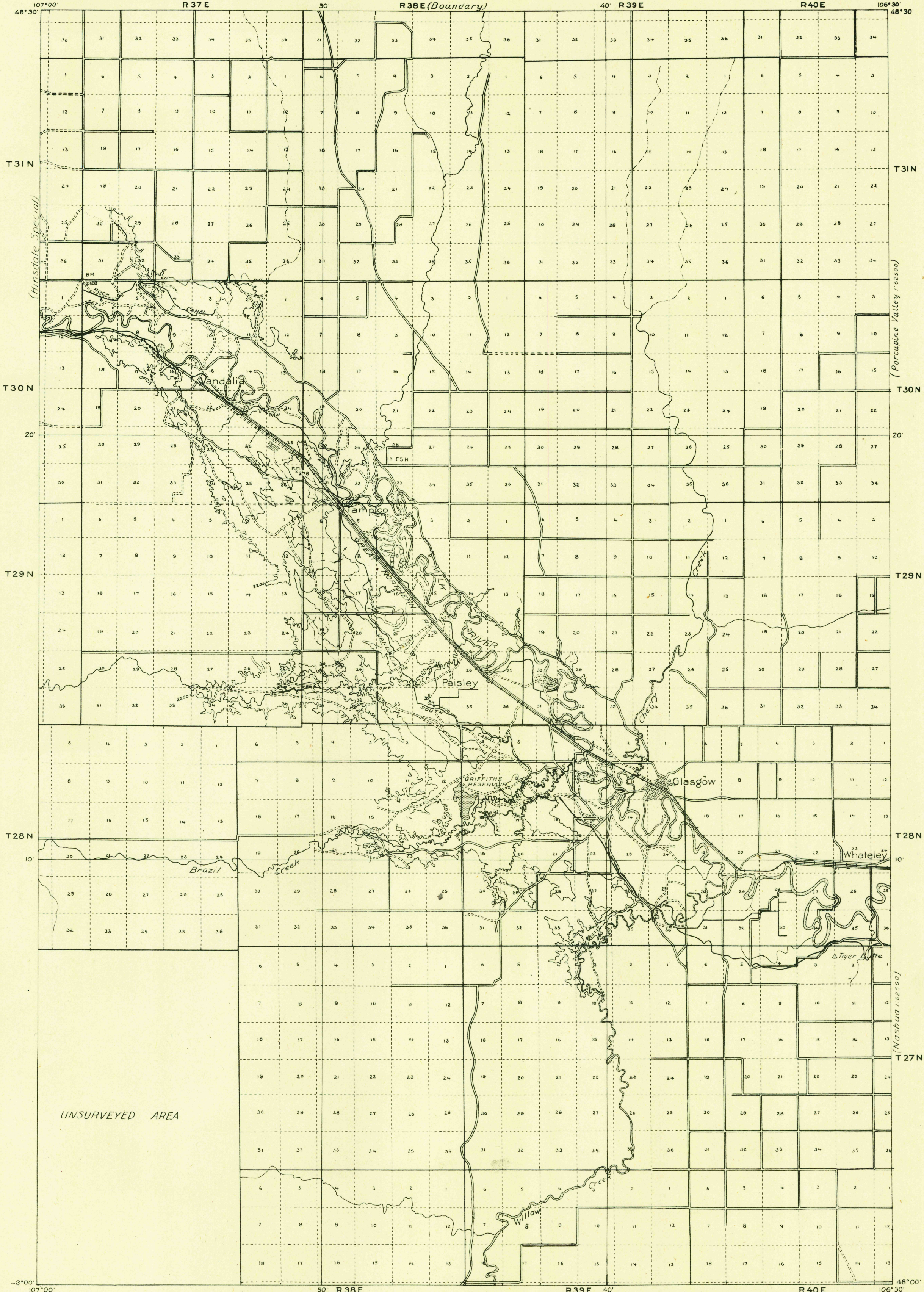

Compilation under direction of Col. Chas. L. Potter,
Corps of Engineers, U. S. A.,
Department Engineer, Western Department, 1919.
Triangulation from U. S. G. S.
U. S. Reclamation Service, Milk River Project.
Valley County Map, 1918.

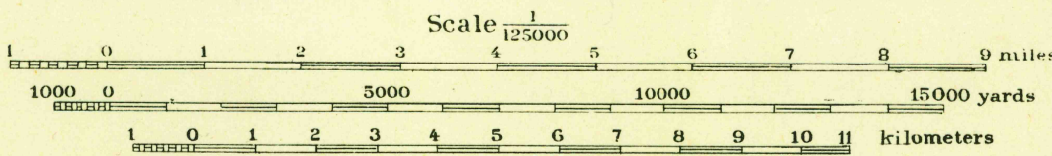

Contour Interval 50 feet
Datum is mean sea level

NOTE: OFFICERS USING THIS MAP WILL MARK HEREON CORRECTIONS AND ADDITIONS WHICH COME TO THEIR ATTENTION AND MAIL DIRECT TO 'THE CHIEF OF ENGINEERS, WASHINGTON, D. C.'

ARMY MAP SERVICE, U. S. ARMY, WASHINGTON, D. C., 101632
1943

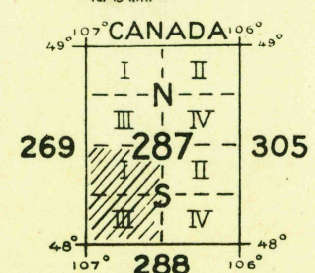

TRUE NORTH
MAGNETIC NORTH
APPROXIMATE MEAN DECLINATION 1920

USGS
HISTORICAL FILE
TOPOGRAPHIC DIVISION

GLASGOW