

Produced by the U.S. Geological Survey
Revised by the U.S. Forest Service
Areas outside the National Forest System lands may not have been revised
Topography compiled 1960. Planimetry derived from imagery taken 1991
Public Land Survey System and survey control current as of 1996. Partial
field check by U.S. Forest Service 1996
North American Datum of 1927 (NAD 27). Projection and 10 000-foot ticks:
Montana coordinate system, south zone (Lambert conformal conic)
Blue 1000-meter Universal Transverse Mercator ticks, zone 12
North American Datum of 1983 (NAD 83) is shown by dashed corner ticks
The values of the shift between NAD 27 and NAD 83 for 7.5-minute
intersections are obtainable from National Geodetic Survey NADCON software
Non-National Forest System lands within the National Forest
Inholdings may exist in other National or State reservations
This map is not a legal land line or ownership document. Public lands are
subject to change and leasing, and may have access restrictions; check
with local offices. Obtain permission before entering private lands

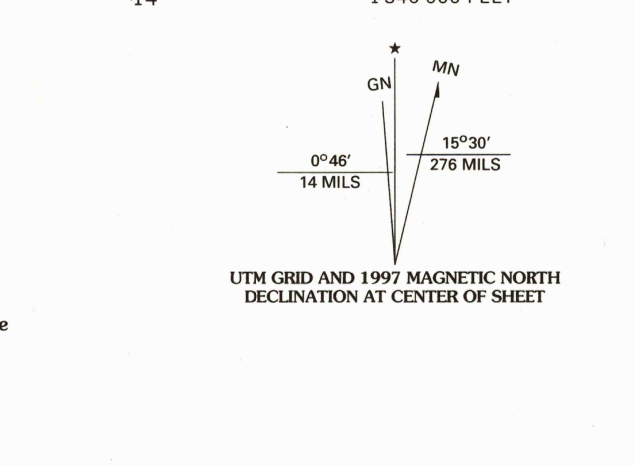

SCALE 1:24 000
CONTOUR INTERVAL 40 FEET
SUPPLEMENTARY CONTOUR INTERVAL 20 FEET
NATIONAL GEODETIC VERTICAL DATUM OF 1929
TO CONVERT FEET TO METERS MULTIPLY BY 0.3048

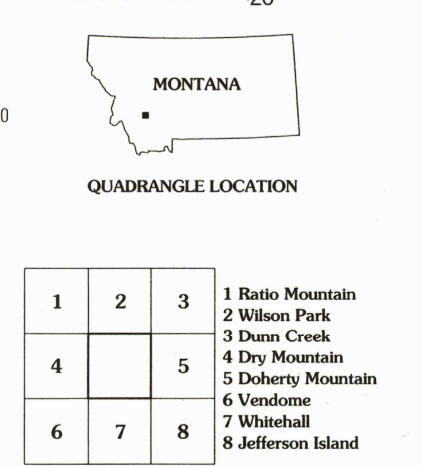

HIGHWAYS AND ROADS

Interstate	5	Primary highway	Red line
U. S.	26	Secondary highway	Red dashed line
State	6	Light-duty road	Black dashed line
County	6	Composition: Unspecified	Black solid line
National Forest, suitable for passenger cars	103	Paved	Black solid line with dashes
National Forest, suitable for high clearance vehicles	104	Gravel	Black solid line with dots
National Forest Trail	384	Dirt	Black solid line with triangles
		Unimproved; 4 wheel drive	Black solid line with squares
		Trail	Black solid line with circles
		Gate; Barrier	Black solid line with diamonds

QUADRANGLE LOCATION

1	2	3	1 Ratio Mountain
4	5	6	2 Wilton Park
6	7	8	3 Duan Creek
			4 Dry Mountain
			5 Doherty Mountain
			6 Vendome
			7 Whitehall
			8 Jefferson Island

ADJOINING 7.5' QUADRANGLES

RECEIVED
MAY 31 1999
USGS NMD
HISTORICAL MAP ARCHIVES



THIS MAP COMPLIES WITH NATIONAL MAP ACCURACY STANDARDS
FOR SALE BY U.S. GEOLOGICAL SURVEY, P.O. BOX 25286, DENVER, COLORADO 80225
A FOLDER DESCRIBING TOPOGRAPHIC MAPS AND SYMBOLS IS AVAILABLE ON REQUEST

BLACK BUTTE, MT
1996
NIMA 3575 1 NE - SERIES V894