

UNITED STATES  
DEPARTMENT OF THE INTERIOR  
GEOLOGICAL SURVEY

BOBCAT COULEE SE QUADRANGLE  
MONTANA - LIBERTY CO.  
7.5 MINUTE SERIES (TOPOGRAPHIC)

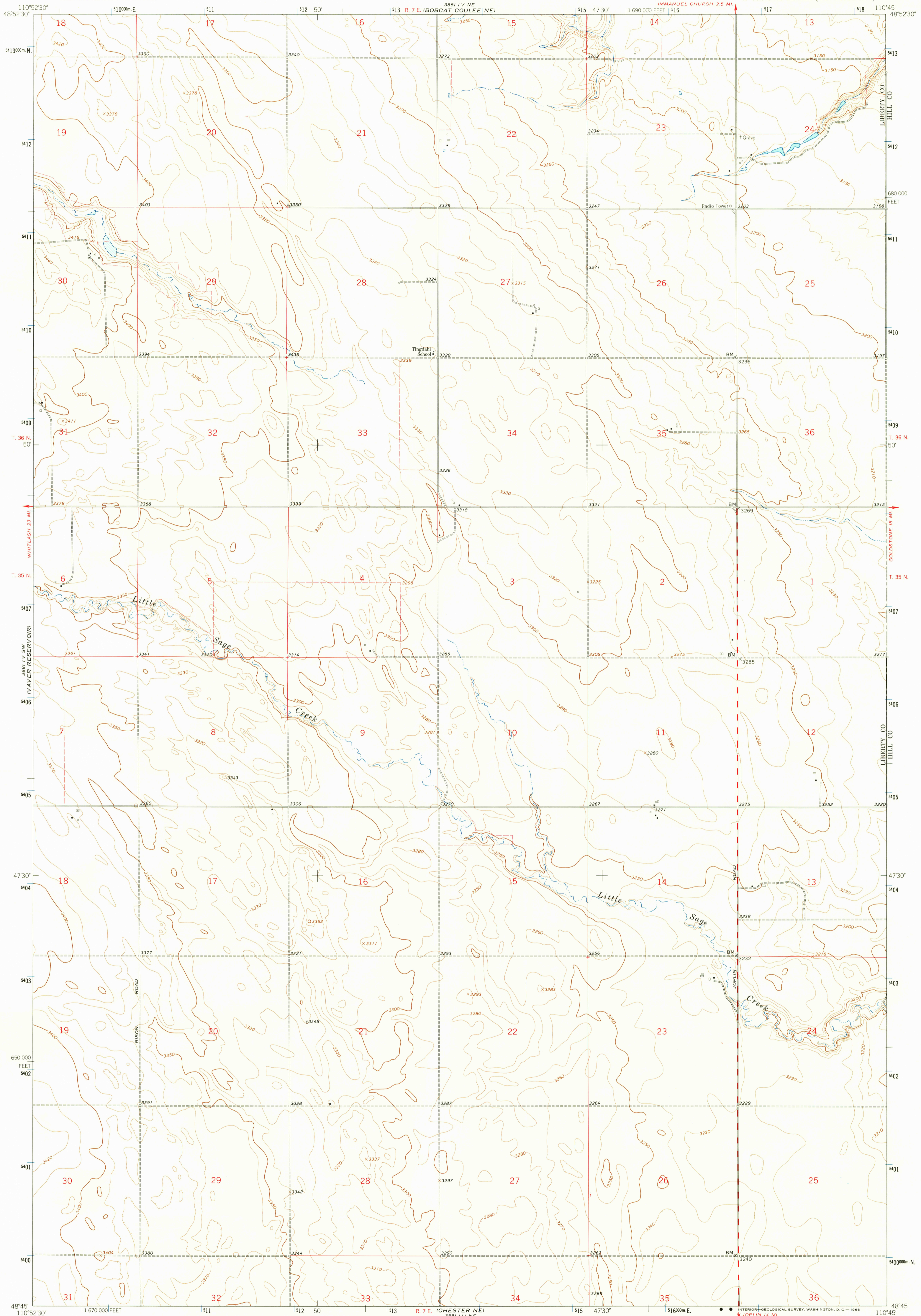

Maped, edited, and published by the Geological Survey

Control by USGS and USC&GS  
Topography by photogrammetric methods from aerial photographs taken 1962. Field checked 1963.  
Polyconic projection. 1927 North American datum. 10,000-foot grid based on Montana coordinate system, north zone. 1000-meter Universal Transverse Mercator grid ticks, zone 12, shown in blue.  
Fine red dashed lines indicate selected fence lines.

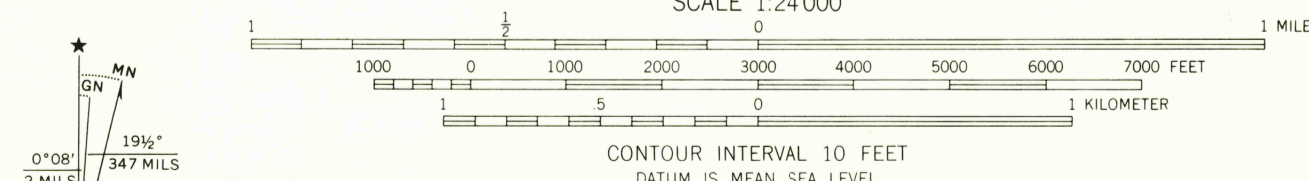

BOBCAT COULEE SE, MONT.  
N4845-W1045/75

1963

AMS 3881 IV SE - SERIES Y894

USGS  
Historical File  
Topographic Division

2260  
FEB 1 1966

U.S.G.S.  
FILE COPY  
TOPOGRAPHIC DIVISION

THIS MAP COMPLIES WITH NATIONAL MAP ACCURACY STANDARDS  
FOR SALE BY U. S. GEOLOGICAL SURVEY, DENVER, COLORADO 80225, OR WASHINGTON, D. C. 20242  
A FOLDER DESCRIBING TOPOGRAPHIC MAPS AND SYMBOLS IS AVAILABLE ON REQUEST