

(DA&M/R)

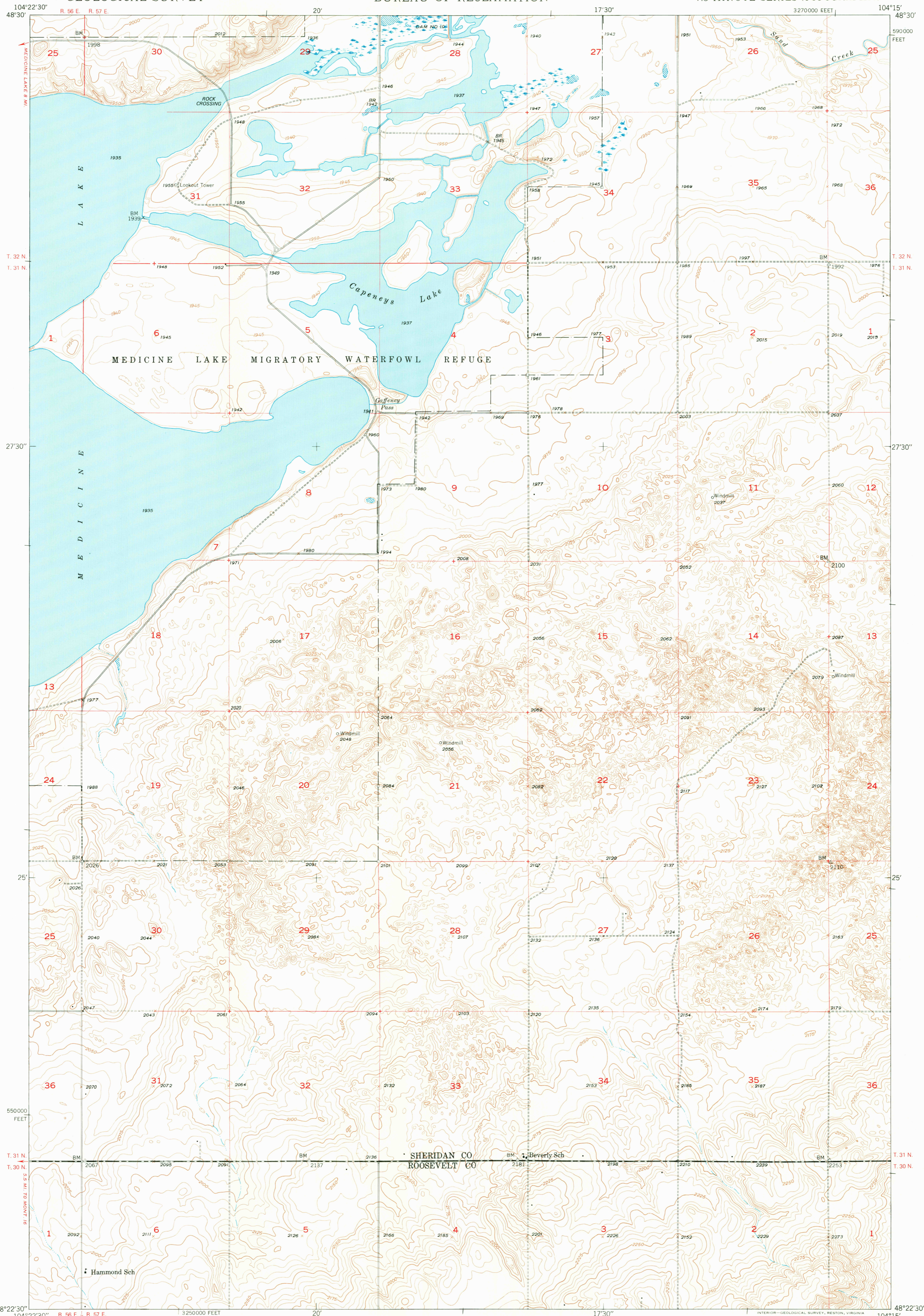

104°22'30" R. 56 E. R. 57 E. 20' 17'30" 3270000 FEET 104°15' 48°30' 590000 FEET
T. 32 N. T. 31 N. 27°30' 27°30' 25' 25' 550000 FEET
T. 31 N. T. 30 N. 48°22'30" 104°22'30" R. 56 E. R. 57 E. MC CABE 0.5 MI.
Mapped, edited, and published by the Geological Survey
Control by USGS
Culture and drainage in part compiled from aerial photographs taken May 1946
Topography by plane-table methods 1946-1947
Polyconic projection. 1927 North American datum
10,000-foot grid based on Montana coordinate system, north zone

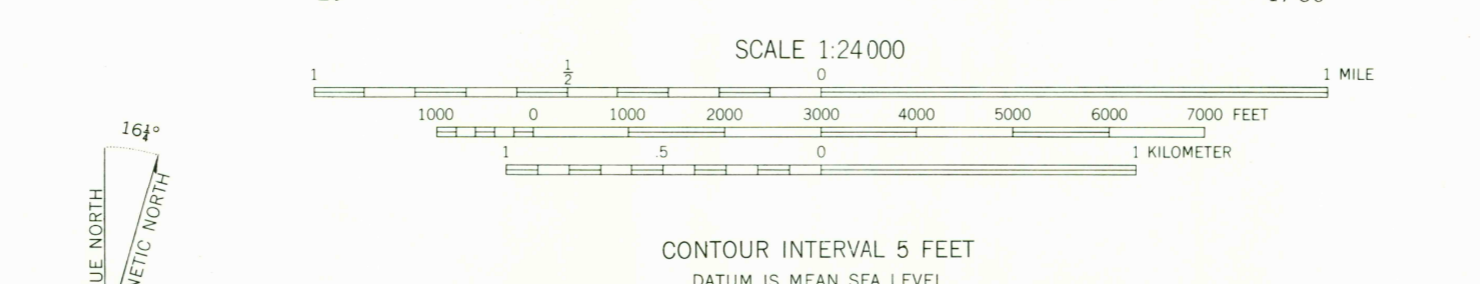

ROAD CLASSIFICATION
HARD-SURFACE ALL WEATHER ROADS DRY WEATHER ROADS
Heavy-duty 4 LANE 16 LANE Improved dirt
Medium-duty 4 LANE 16 LANE Unimproved dirt
Loose-surface or narrow hard-surface

APPROXIMATE MEAN DECLINATION, 1947
TRUE NORTH
MAGNETIC NORTH
16'

THIS MAP COMPLIES WITH NATIONAL MAP ACCURACY STANDARDS
FOR SALE BY U. S. GEOLOGICAL SURVEY, DENVER, COLORADO 80225, OR RESTON, VIRGINIA 22092
A FOLDER DESCRIBING TOPOGRAPHIC MAPS AND SYMBOLS IS AVAILABLE ON REQUEST

CAPENEYS LAKE, MONT.
N4822.5 - W10415.7.5
USGS
Historical File
Topographic Division
PRINTED 1948

1300
JAN 09 1978