

UNITED STATES
DEPARTMENT OF THE INTERIOR
GEOLOGICAL SURVEY

EMMA BUTTE QUADRANGLE
MONTANA—GARFIELD CO.
7.5 MINUTE SERIES (TOPOGRAPHIC)

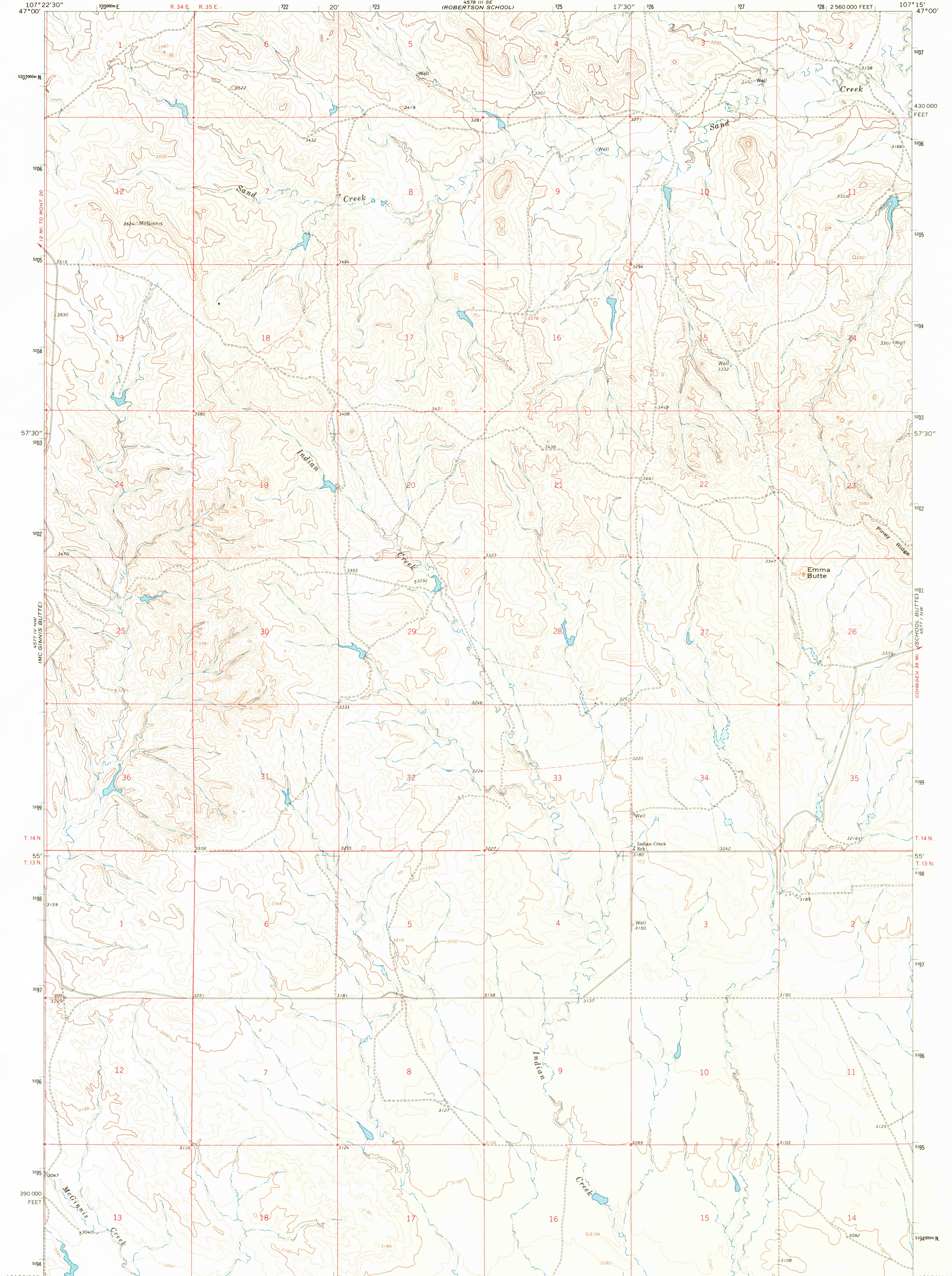

Mapped, edited, and published by the Geological Survey

Control by USGS and USC&GS

Topography by photogrammetric methods from aerial
photographs taken 1964. Field checked 1965

Polyconic projection. 1927 North American datum

10,000-foot grid based on Montana coordinate system,
central zone

1000-meter Universal Transverse Mercator grid ticks,
zone 13, shown in blue

Fine red dashed lines indicate selected fence lines

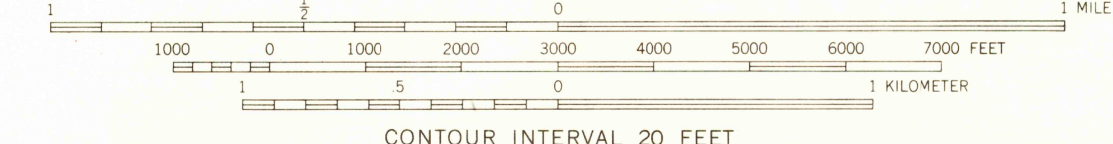
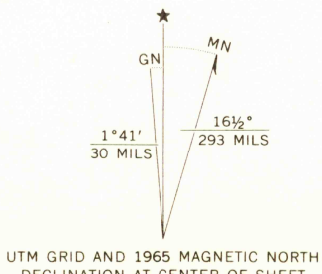

CONTOUR INTERVAL 20 FEET

DATUM IS MEAN SEA LEVEL



ROAD CLASSIFICATION
Light-duty ————— Unimproved dirt —————

EMMA BUTTE, MONT.
N4652.5—W10715.7.5

1965

AMS 4577 IV NE—SERIES Y894

USGS
Historical File
Topographic Division

U.S.G.S.
FILE COPY
TOPOGRAPHIC DIVISION

2215
017 2 1968