

UNITED STATES
DEPARTMENT OF THE INTERIOR
GEOLOGICAL SURVEY

FOURTEENMILE COULEE SE QUADRANGLE
MONTANA
7.5 MINUTE SERIES (TOPOGRAPHIC)

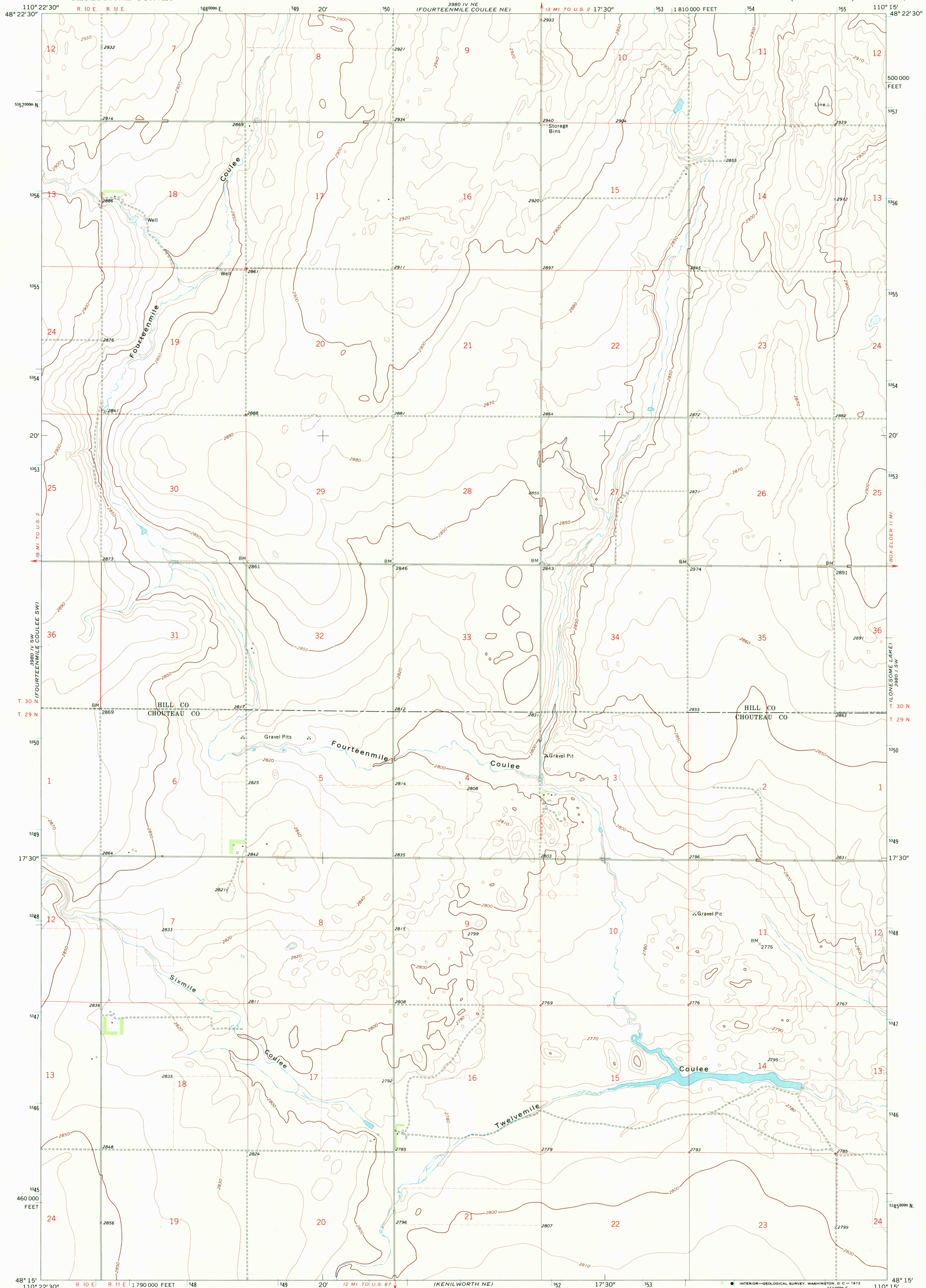

Mapped, edited, and published by the Geological Survey
Control by USGS and USC&GS
Topography by photogrammetric methods from aerial
photographs taken 1968. Field checked 1969
Polyconic projection. 1927 North American datum
10,000-foot grid based on Montana coordinate system,
north zone
1000-meter Universal Transverse Mercator grid ticks,
zone 12, shown in blue
Fine red dashed lines indicate selected fence lines

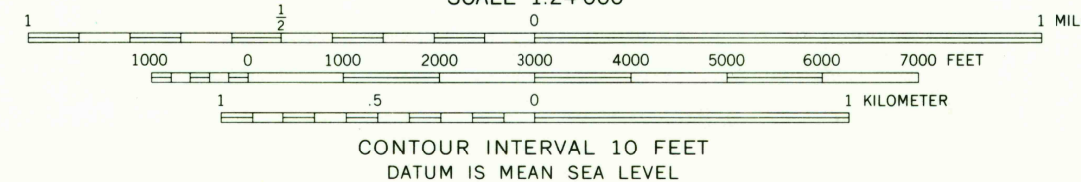
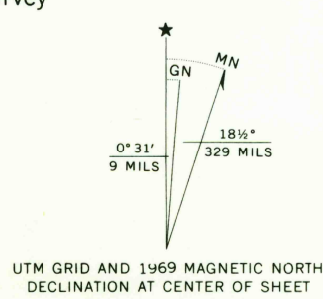

ROAD CLASSIFICATION
Light-duty road, all weather, Unimproved road, fair or dry
improved surface weather



FOURTEENMILE COULEE SE, MONT.
N4815-W11015/7.5

1969

AMS 3980 IV SE-SERIES V894

THIS MAP COMPLIES WITH NATIONAL MAP ACCURACY STANDARDS
FOR SALE BY U.S. GEOLOGICAL SURVEY, DENVER, COLORADO 80225, OR WASHINGTON, D.C. 20242
A FOLDER DESCRIBING TOPOGRAPHIC MAPS AND SYMBOLS IS AVAILABLE ON REQUEST

USGS
HISTORICAL FILE
TOPOGRAPHIC DIVISION

OCT 2 1972

277c