

UNITED STATES  
DEPARTMENT OF THE INTERIOR  
GEOLOGICAL SURVEY

FOURTEENMILE COULEE SW QUADRANGLE  
MONTANA  
7.5 MINUTE SERIES (TOPOGRAPHIC)

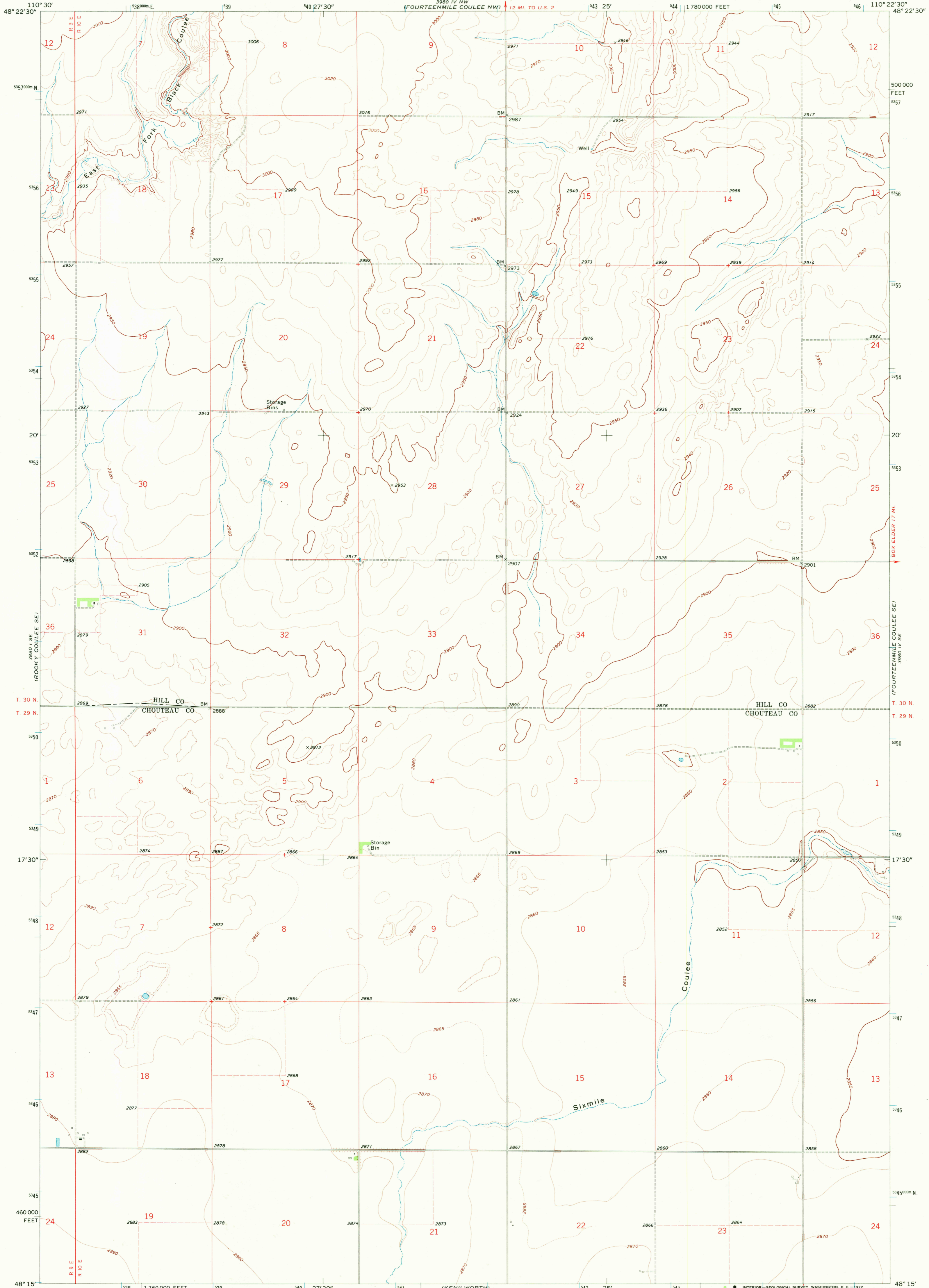

Mapped, edited, and published by the Geological Survey  
Control by USGS and USC&GS  
Topography by photogrammetric methods from aerial  
photographs taken 1968. Field checked 1969.  
Polyconic projection. 1927 North American datum  
10,000-foot grid based on Montana coordinate system,  
north zone  
1000-meter Universal Transverse Mercator grid ticks,  
zone 12, shown in blue  
Fine red dashed lines indicate selected fence lines

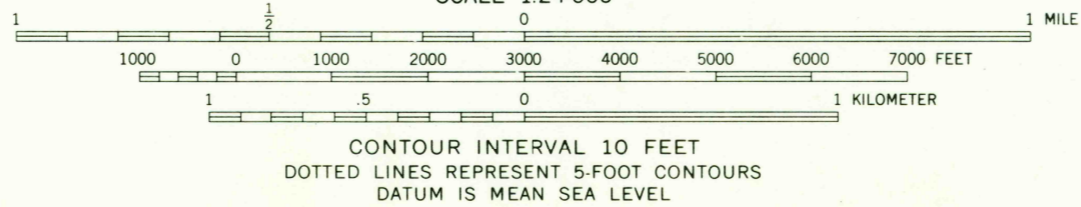
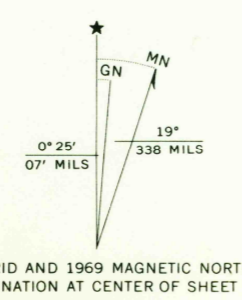

ROAD CLASSIFICATION  
Light-duty road, all weather, Unimproved road, fair or dry weather  
improved surface weather



FOURTEENMILE COULEE SW, MONT.  
N4815-W11022.5/7.5

THIS MAP COMPLIES WITH NATIONAL MAP ACCURACY STANDARDS  
FOR SALE BY U.S. GEOLOGICAL SURVEY, DENVER, COLORADO 80225, OR WASHINGTON, D.C. 20242  
A FOLDER DESCRIBING TOPOGRAPHIC MAPS AND SYMBOLS IS AVAILABLE ON REQUEST

1969  
AMS 3980 IV SW-SERIES V894

USGS  
HISTORICAL FILE  
TOPOGRAPHIC DIVISION

2250

SEP 8 1972