

3680 II SW  
LEGEND

UNITED STATES  
DEPARTMENT OF THE INTERIOR  
GEOLOGICAL SURVEY

FOWLER COULEE NW QUADRANGLE  
MONTANA  
7.5 MINUTE SERIES (TOPOGRAPHIC)

3680 II SE  
LEGEND  
(CENTRAL SCHOOL)

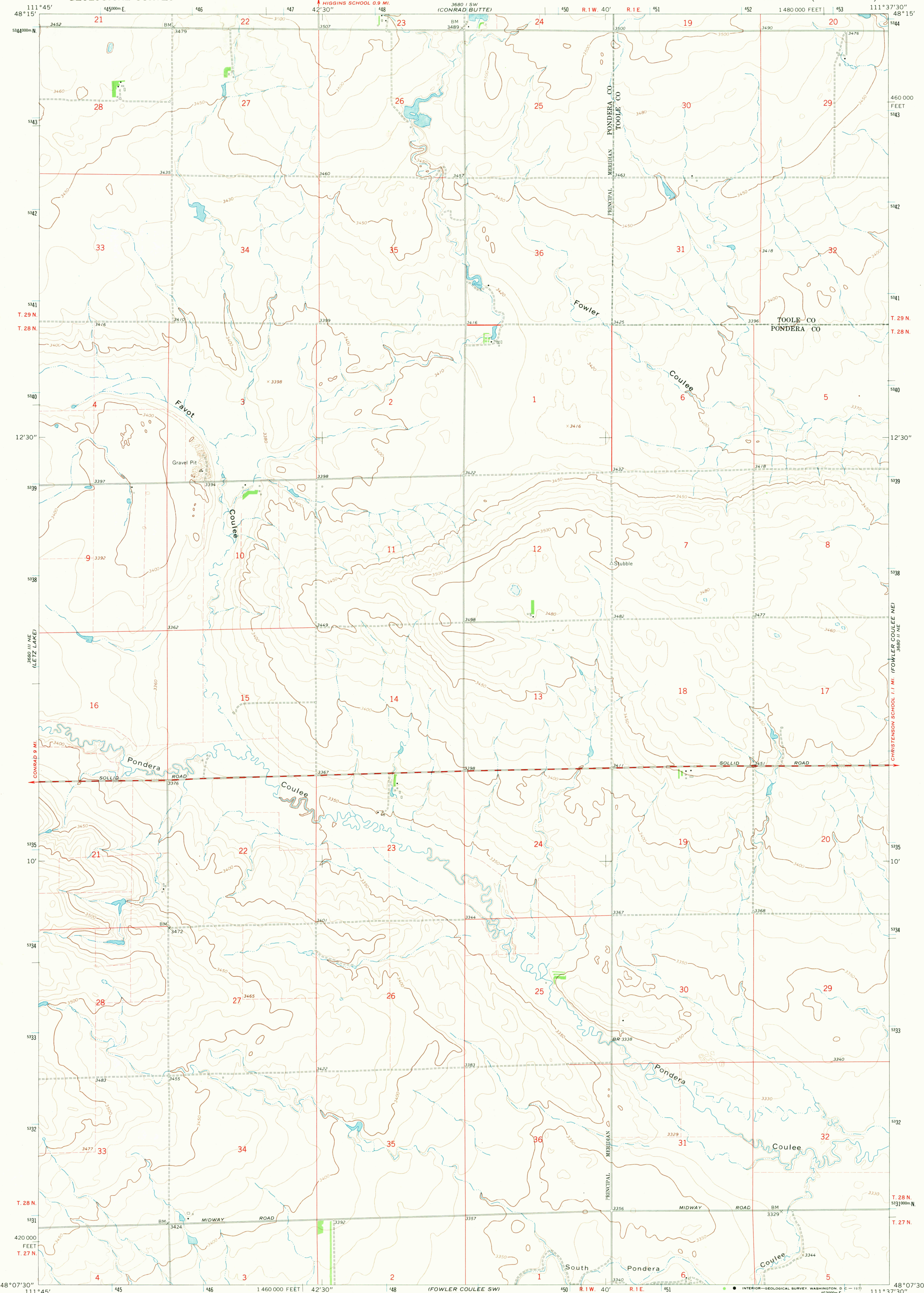

Mapped, edited, and published by the Geological Survey  
Control by USGS and USC&GS  
Topography by photogrammetric methods from aerial  
photographs taken 1965. Field checked 1967  
Polyconic projection. 1927 North American datum  
10,000-foot grid based on Montana coordinate system,  
north zone  
1,000-meter Universal Transverse Mercator grid ticks,  
zone 12, shown in blue  
Fine red dashed lines indicate selected fence lines

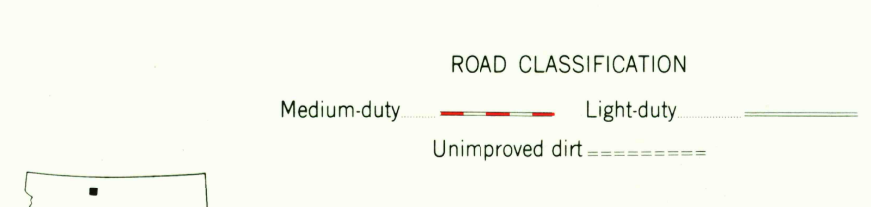
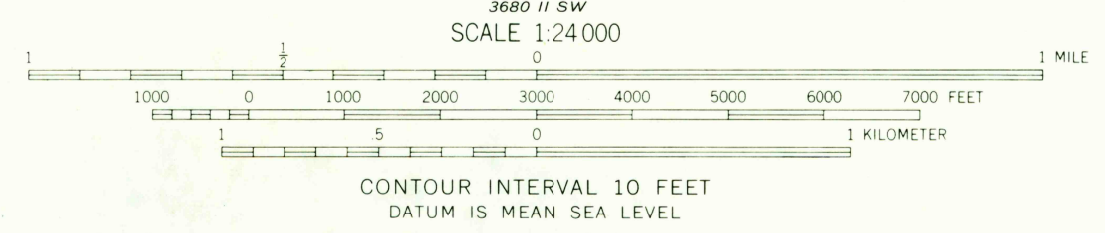
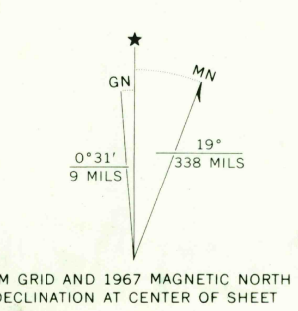

FOWLER COULEE NW, MONT.  
N4807.5—W11137.5/7.5

THIS MAP COMPLIES WITH NATIONAL MAP ACCURACY STANDARDS  
FOR SALE BY U.S. GEOLOGICAL SURVEY, DENVER, COLORADO 80225, OR WASHINGTON, D. C. 20242  
A FOLDER DESCRIBING TOPOGRAPHIC MAPS AND SYMBOLS IS AVAILABLE ON REQUEST

1967  
AMS 3680 II NW—SERIES V894

USGS  
Historical File  
Topographic Division

U.S.G.S.  
**FILE COPY**  
TOPOGRAPHIC DIVISION

2305  
FEB 2 1971