

5180 V NW
(MEDICINE LAKE)

UNITED STATES
DEPARTMENT OF THE INTERIOR
GEOLOGICAL SURVEY

FROID SE QUADRANGLE
MONTANA-ROOSEVELT CO.
7.5 MINUTE SERIES (TOPOGRAPHIC)

5180 V NW
(SUNNYSIDE SCHOOL)

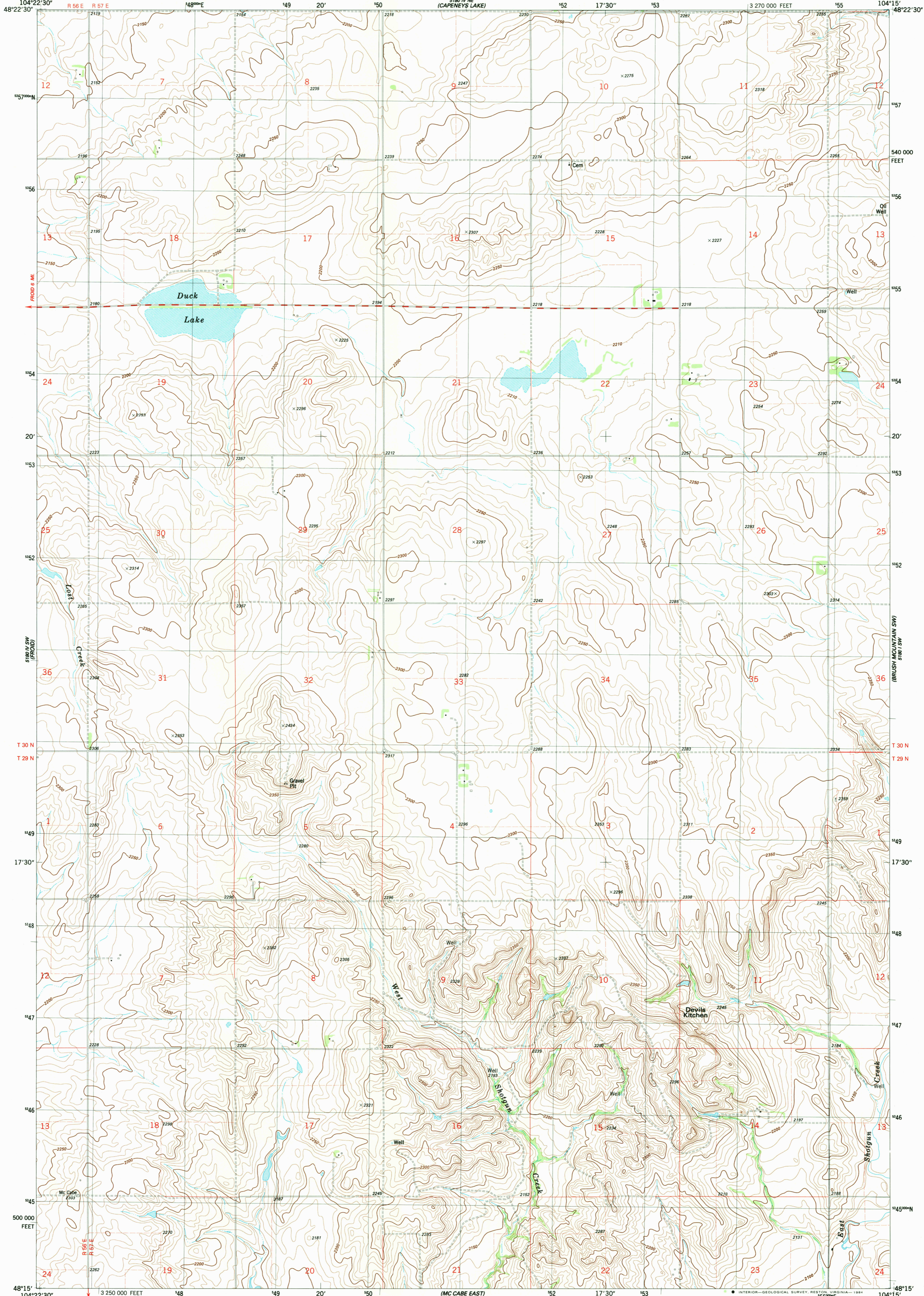

Mapped, edited, and published by the Geological Survey
Control by USGS and NOS/NOAA
Topography by photogrammetric methods from aerial photographs
taken 1975. Field checked 1977. Map edited 1983
Projection and 10,000-foot grid ticks: Montana
coordinate system, north zone (Lambert conformal conic)
1000-meter Universal Transverse Mercator grid, zone 13
1927 North American Datum
To place on the predicted North American Datum 1983
move the projection lines 2 meters north and
38 meters east as shown by dashed corner ticks
Fine red dashed lines indicate selected fence lines

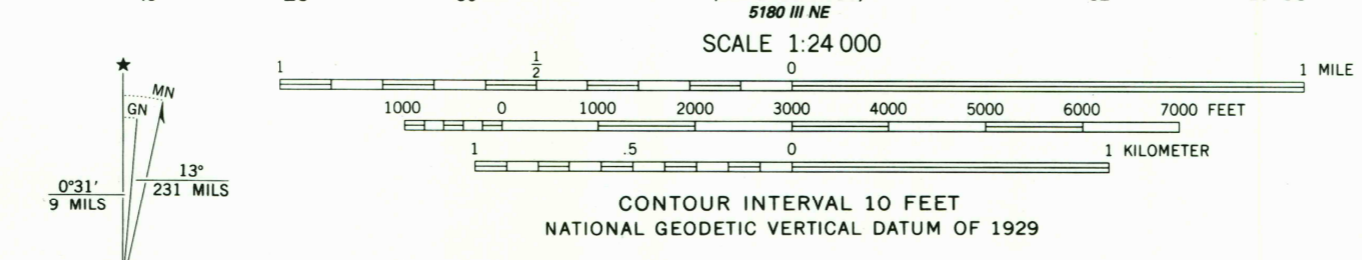

ROAD CLASSIFICATION

Primary highway, hard surface	Light-duty road, hard or improved surface
Secondary highway, hard surface	Unimproved road
Interstate Route	U. S. Route
	State Route



THIS MAP COMPLIES WITH NATIONAL MAP ACCURACY STANDARDS
FOR SALE BY U. S. GEOLOGICAL SURVEY, DENVER, COLORADO 80225, OR RESTON, VIRGINIA 22092
A FOLDER DESCRIBING TOPOGRAPHIC MAPS AND SYMBOLS IS AVAILABLE ON REQUEST

FROID SE, MONT.
N4815-W10415/7.5

1983
DMA 5180 IV SE-SERIES V894

USGS AND HISTORICAL MAP ARCHIVES