

(COLLINS 1:62,500)

UNITED STATES
DEPARTMENT OF THE INTERIOR
GEOLOGICAL SURVEY

GREENFIELD QUADRANGLE
MONTANA-TETON CO.
7.5 MINUTE SERIES (TOPOGRAPHIC)
NE/4 FAIRFIELD 15' QUADRANGLE

(DUTTON 1:62,500)

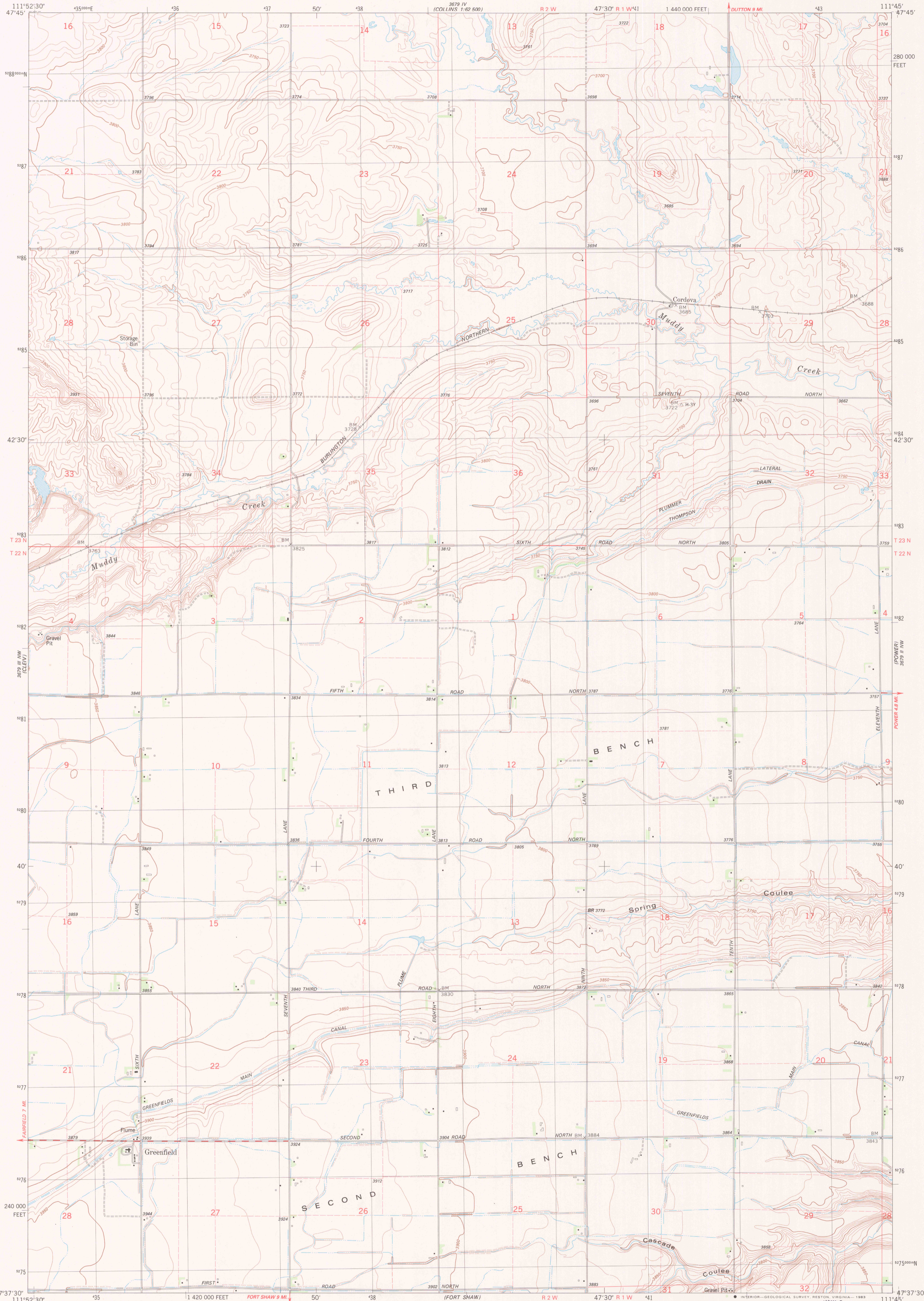

Mapped, edited, and published by the Geological Survey
Control by USGS and NOS/NOAA
Topography by photogrammetric methods from aerial photographs taken 1975. Field checked 1978. Map edited 1983
Projection and 10,000-foot grid ticks: Montana coordinate system, north zone (Lambert conformal conic) 1000-meter Universal Transverse Mercator grid, zone 12 1927 North American datum
To place on the predicted North American Datum 1983 move the projection lines 9 meters north and 63 meters east as shown by dashed corner ticks
Fine red dashed lines indicate selected fence lines

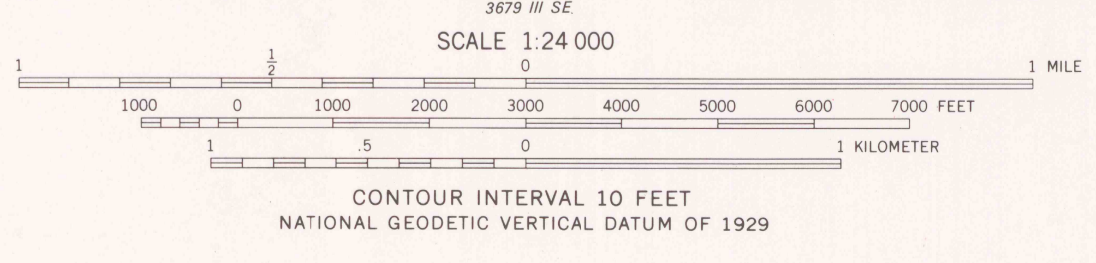
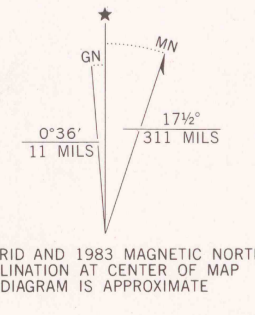

ROAD CLASSIFICATION

Primary highway, hard surface	Light-duty road, hard or unimproved surface
Secondary highway, hard surface	Unimproved road
Interstate Route	U. S. Route
	State Route

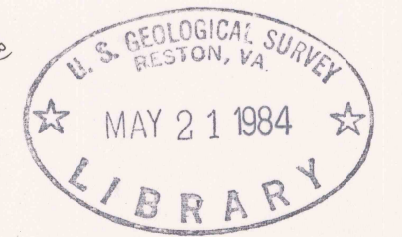

GREENFIELD, MONT.
NE/4 FAIRFIELD 15' QUADRANGLE
N4737.5-W11145.7.5

1983

DMA 3670 III NE-SERIES V804

THIS MAP COMPLIES WITH NATIONAL MAP ACCURACY STANDARDS
FOR SALE BY U. S. GEOLOGICAL SURVEY, DENVER, COLORADO 80225, OR RESTON, VIRGINIA 22092
A FOLDER DESCRIBING TOPOGRAPHIC MAPS AND SYMBOLS IS AVAILABLE ON REQUEST