

UNITED STATES
DEPARTMENT OF THE INTERIOR
GEOLOGICAL SURVEY

HEADLIGHT BUTTE QUADRANGLE
MONTANA—GLACIER CO.
7.5 MINUTE SERIES (TOPOGRAPHIC)

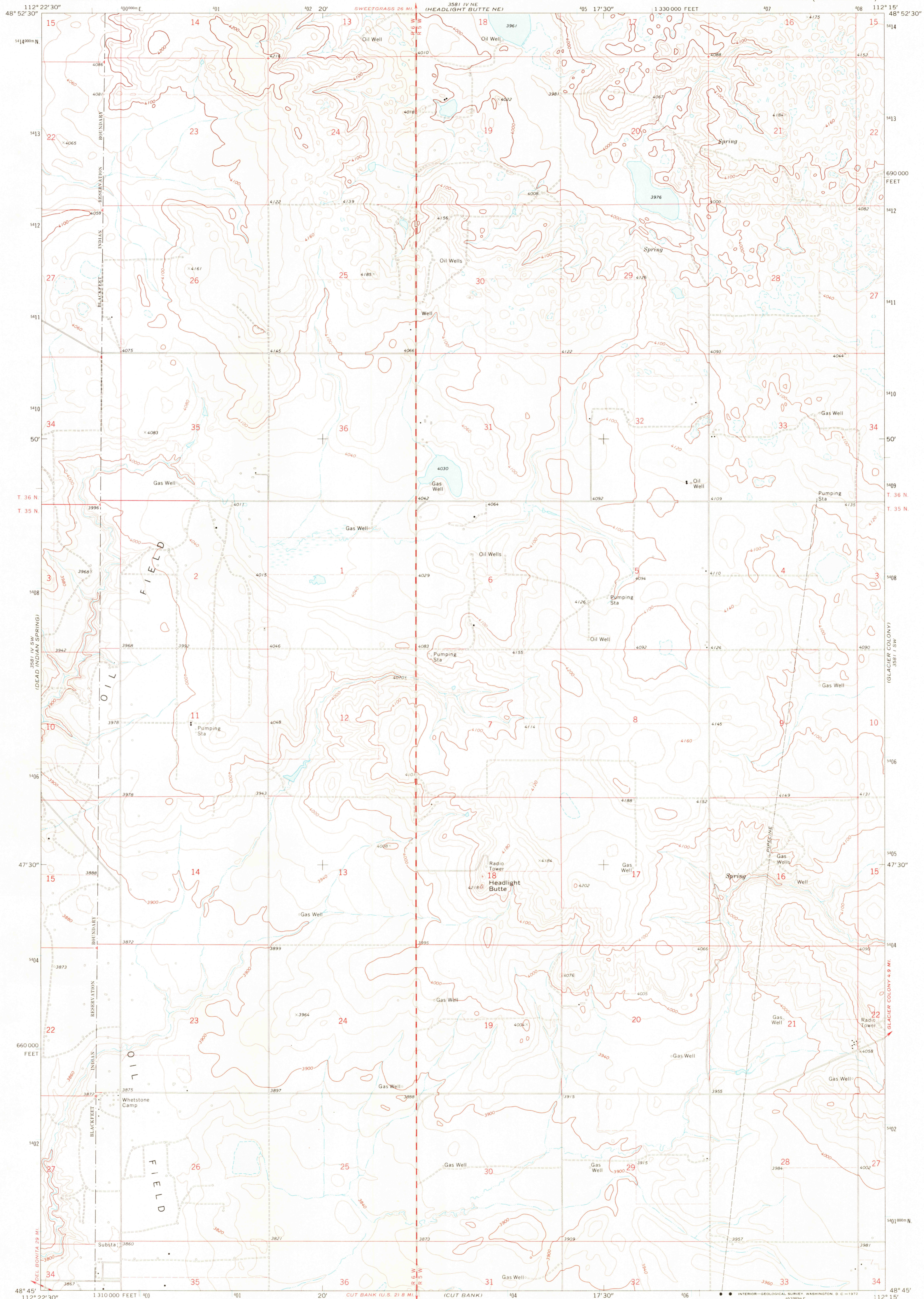

Mapped, edited, and published by the Geological Survey

Control by USGS and USC&GS
Topography by photogrammetric methods from aerial photographs taken 1966. Field checked 1968
Polyconic projection. 1927 North American datum
10,000-foot grid based on Montana coordinate system, north zone
1000-meter Universal Transverse Mercator grid ticks, zone 12, shown in blue
Fine red dashed lines indicate selected fence lines

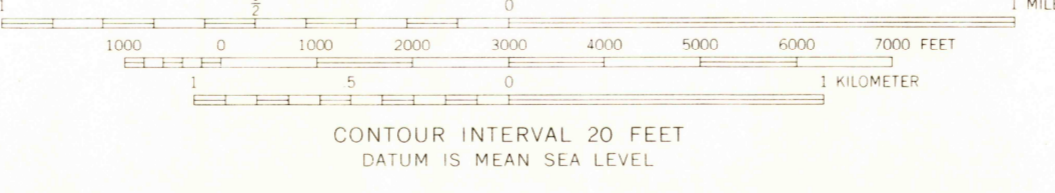
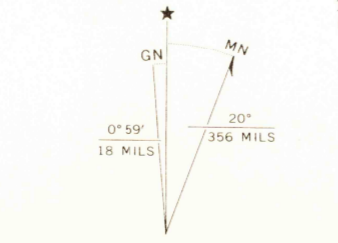

CONTOUR INTERVAL 20 FEET
DATUM IS MEAN SEA LEVEL

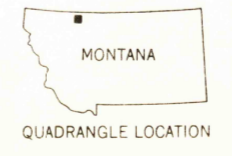

ROAD CLASSIFICATION
Secondary highway, all weather. Light-duty road, all weather, hard surface. Improved surface.
Unimproved road, fair or dry weather.

HEADLIGHT BUTTE, MONT.
N4845-W11215/7.5
1968

THIS MAP COMPLIES WITH NATIONAL MAP ACCURACY STANDARDS
FOR SALE BY U. S. GEOLOGICAL SURVEY, DENVER, COLORADO 80225, OR WASHINGTON, D. C. 20242
A FOLDER DESCRIBING TOPOGRAPHIC MAPS AND SYMBOLS IS AVAILABLE ON REQUEST

AMS 3581 IV SE—SERIES 8984

USGS
HISTORICAL FILE
TOPOGRAPHIC DIVISION

MAY 24 1972
2280