

WETLANDS COULEE

UNITED STATES
DEPARTMENT OF THE INTERIOR
GEOLOGICAL SURVEY

HERRON PARK QUADRANGLE
MONTANA—HILL CO.
7.5 MINUTE SERIES (TOPOGRAPHIC)
SE 1/4 ASSINIBOINE 15' QUADRANGLE

WETLANDS COULEE

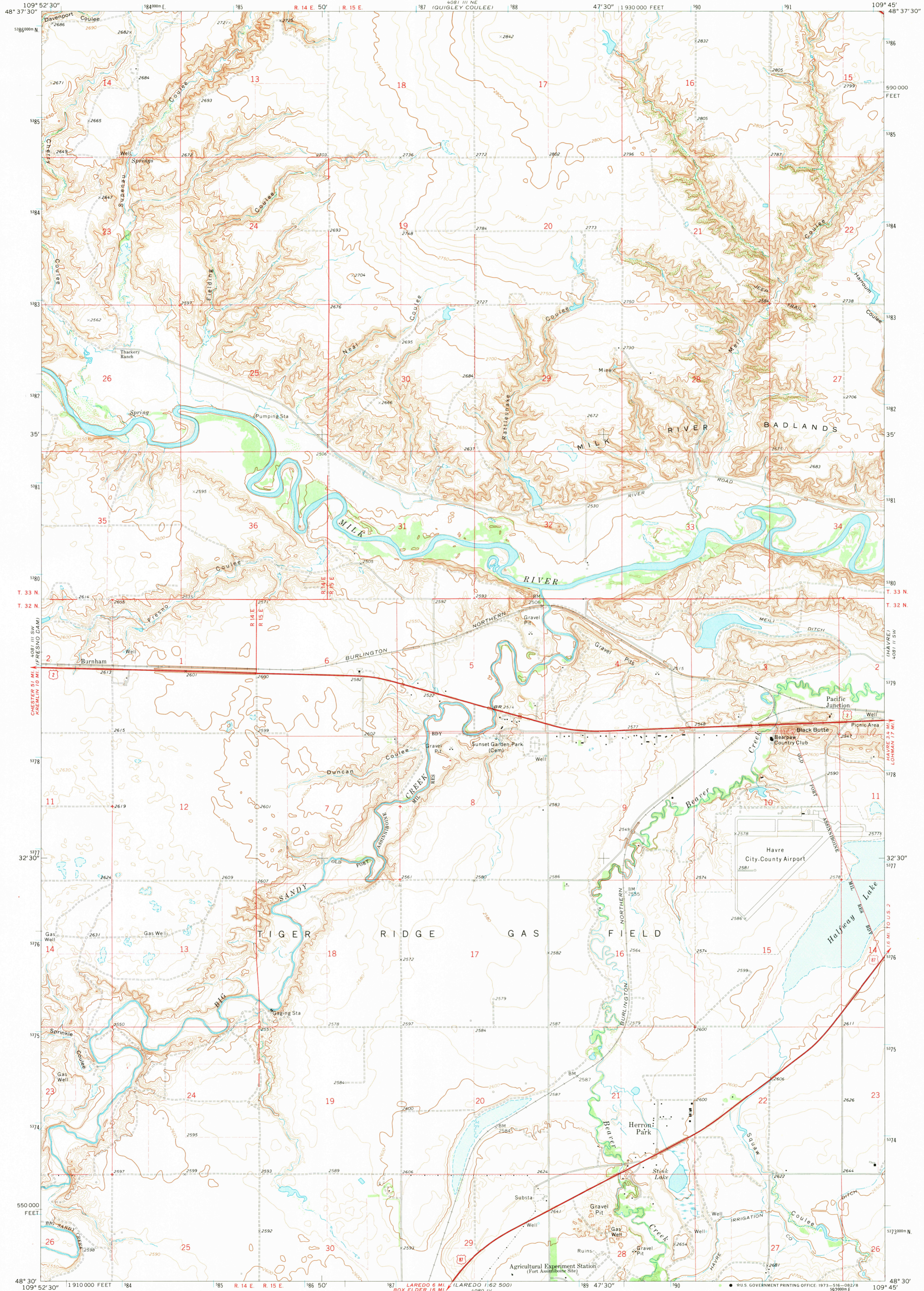

Maped, edited, and published by the Geological Survey as part of the Department of the Interior program for the development of the Missouri River Basin Control by USGS and USC&GS
Topography by photogrammetric methods from aerial photographs taken 1969. Field checked 1970
Polyconic projection. 1927 North American datum 10,000-foot grid based on Montana coordinate system, north zone
1000-meter Universal Transverse Mercator grid ticks, zone 12, shown in blue
Fine red dashed lines indicate selected fence lines

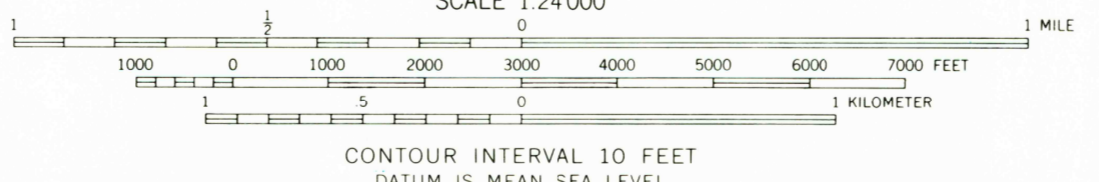
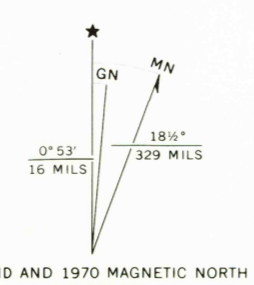

ROAD CLASSIFICATION

Primary highway, hard surface	Light-duty road, hard or improved surface
Secondary highway, hard surface	Unimproved road
Interstate Route	U. S. Route
	State Route

HERRON PARK, MONT.
SE 1/4 ASSINIBOINE 15' QUADRANGLE
N4830-W10945/7.5

1970
AMS 4081 III SE—SERIES V894

THIS MAP COMPLIES WITH NATIONAL MAP ACCURACY STANDARDS
FOR SALE BY U. S. GEOLOGICAL SURVEY, DENVER, COLORADO 80225, OR WASHINGTON, D. C. 20242
A FOLDER DESCRIBING TOPOGRAPHIC MAPS AND SYMBOLS IS AVAILABLE ON REQUEST

USGS
HISTORICAL FILE
TOPOGRAPHIC DIVISION

Hoer
NOV 3 1973
3000
50 plane