

3981 I NE
GOLDSTONE

UNITED STATES
DEPARTMENT OF THE INTERIOR
GEOLOGICAL SURVEY

McKINSEY RESERVOIR EAST QUADRANGLE
MONTANA—HILL CO.
7.5 MINUTE SERIES (TOPOGRAPHIC)

3981 IV NE
LOST RIVER

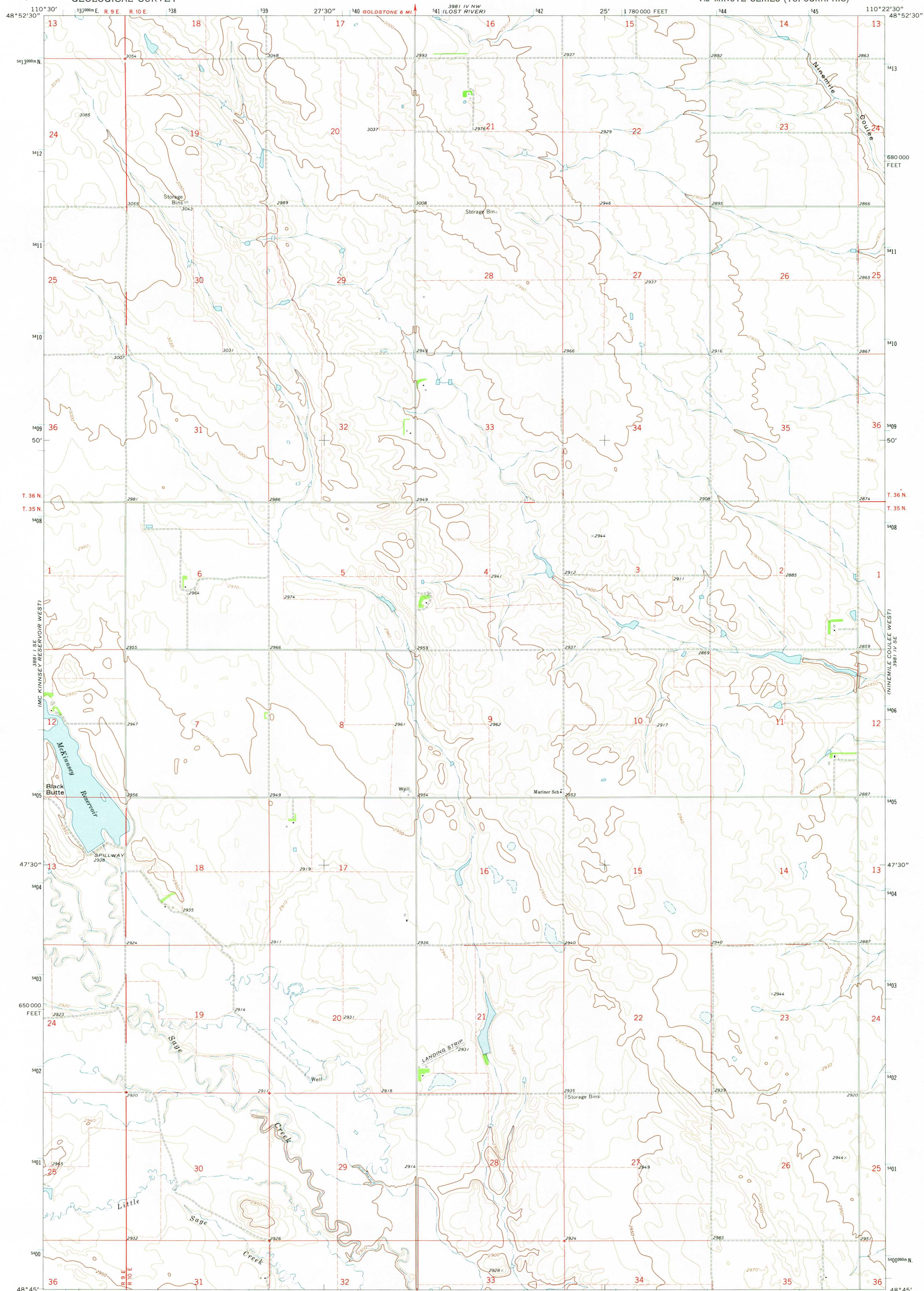

3981 IV NE
GOLDSTONE

Mapped, edited, and published by the Geological Survey
Control by USGS and USC&GS
Topography by photogrammetric methods from aerial
photographs taken 1970. Field checked 1972.
Projection and 10,000-foot grid ticks: Montana
coordinate system, north zone (Lambert conformal conic)
1000-meter Universal Transverse Mercator grid ticks,
zone 12, shown in blue. 1927 North American datum
Fine red dashed lines indicate selected fence lines

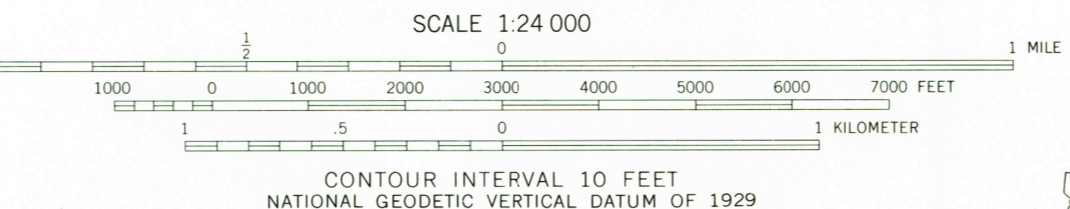
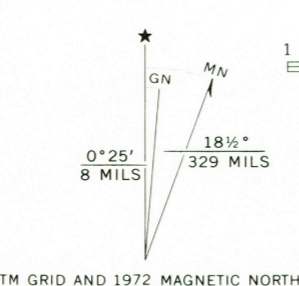

ROAD CLASSIFICATION

Primary highway, hard surface	Light duty road, hard or improved surface
Secondary highway, hard surface	Unimproved road
Interstate Route	U. S. Route
	State Route

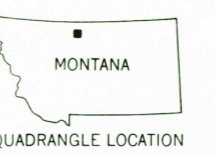

McKINSEY RESERVOIR EAST, MONT.
N4845-W11022.5/7.5

THIS MAP COMPLIES WITH NATIONAL MAP ACCURACY STANDARDS
FOR SALE BY U.S. GEOLOGICAL SURVEY, DENVER, COLORADO 80225, OR RESTON, VIRGINIA 22092
A FOLDER DESCRIBING TOPOGRAPHIC MAPS AND SYMBOLS IS AVAILABLE ON REQUEST

USGS
HISTORICAL FILE
TOPOGRAPHIC DIVISION
AMS 3981 IV SW—SERIES W894

2600
MAY 2 1 1975