

UNITED STATES
DEPARTMENT OF THE INTERIOR
GEOLOGICAL SURVEY

NEEDLE BUTTE QUADRANGLE
MONTANA
7.5 MINUTE SERIES (TOPOGRAPHIC)

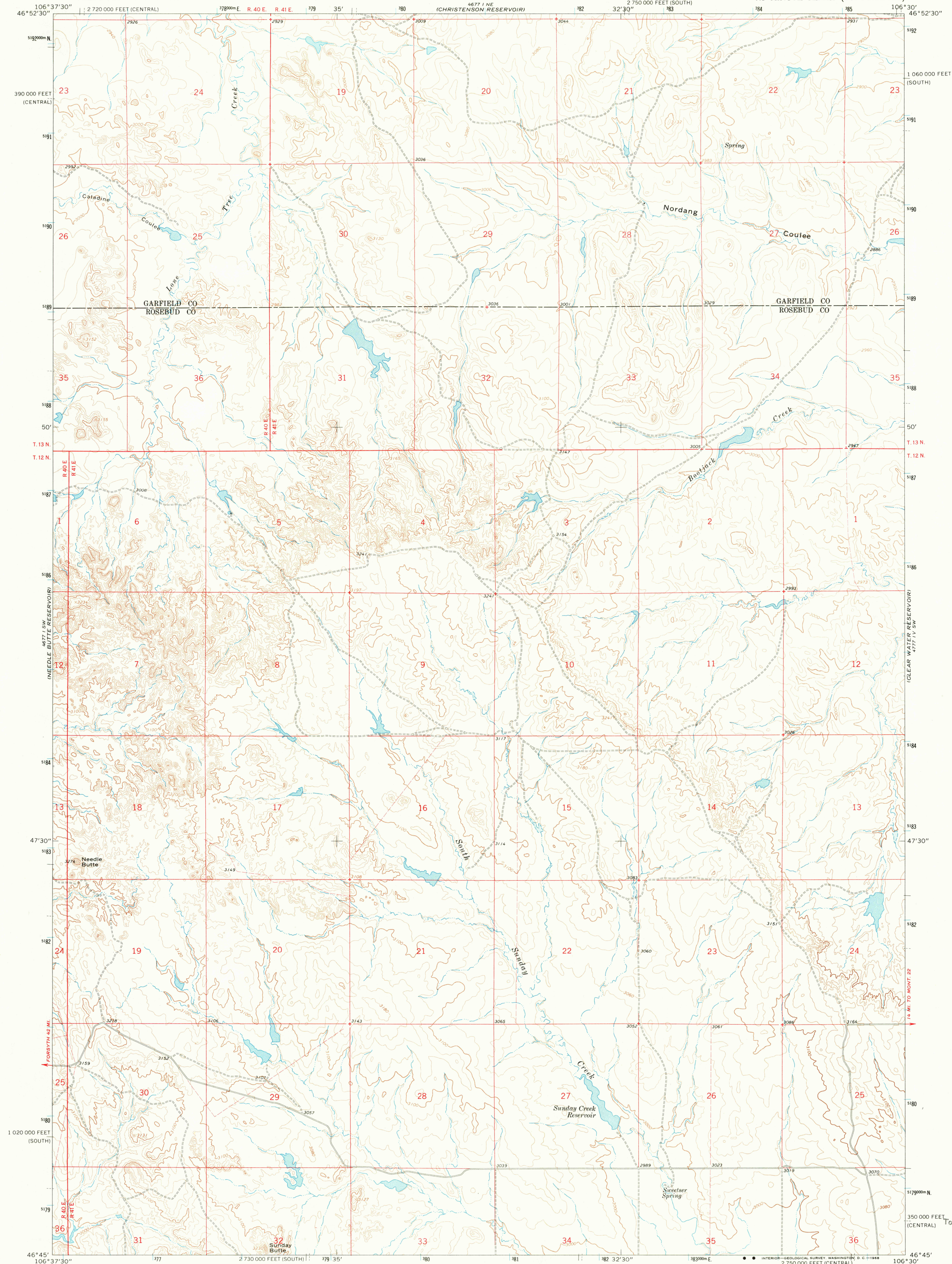

46°52'30" N
390 000 FEET (CENTRAL)
519 200 N
5191
5190
5189
5188
50'
T. 13 N
T. 12 N
5187
5186
5184
5183
47'30" N
5182
5180
1 020 000 FEET (SOUTH)
5179
46°45' N
106°37'30" W

106°37'30" W
2 750 000 FEET (SOUTH)
106°30" W
46°52'30" N
1 060 000 FEET (SOUTH)
5192
5191
5190
5189
5188
50'
T. 13 N
T. 12 N
5187
5186
5184
5183
47'30" N
5182
5180
1 020 000 FEET (SOUTH)
5179
46°45' N
106°37'30" W

Mapped, edited, and published by the Geological Survey
Control by USGS and USC&GS
Topography by photogrammetric methods from aerial photographs taken 1964. Field checked 1965
Polyconic projection. 1927 North American datum
10,000-foot grids based on Montana coordinate system, south and central zones
1000-meter Universal Transverse Mercator grid ticks, zone 13, shown in blue
Fine red dashed lines indicate selected fence lines

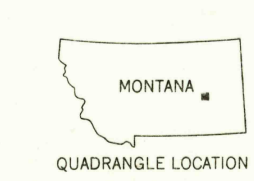
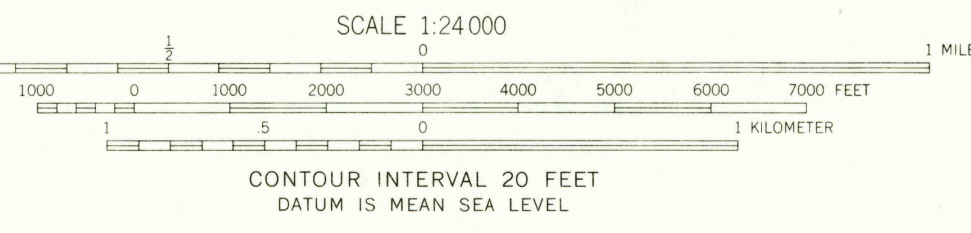
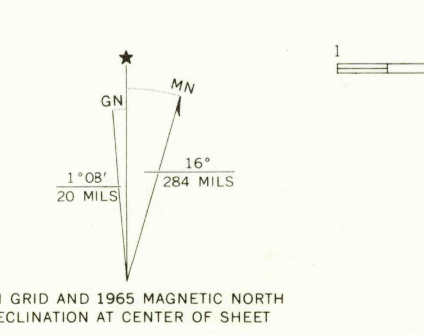

ROAD CLASSIFICATION
Light-duty ————— Unimproved dirt - - - - -

NEEDLE BUTTE, MONT.
N4645—W10630/7.5
1965

USGS
Historical File
Topographic Division
**U.S.G.S.
FILE COPY
TOPOGRAPHIC DIVISION**

THIS MAP COMPLIES WITH NATIONAL MAP ACCURACY STANDARDS
FOR SALE BY U. S. GEOLOGICAL SURVEY, DENVER, COLORADO 80225, OR WASHINGTON, D. C. 20242
A FOLDER DESCRIBING TOPOGRAPHIC MAPS AND SYMBOLS IS AVAILABLE ON REQUEST

APR 2 1969
2355

AMS 4677 1 SE—SERIES V894