

UNITED STATES
DEPARTMENT OF THE INTERIOR
GEOLOGICAL SURVEY

VAUGHN QUADRANGLE
MONTANA
15 MINUTE SERIES (TOPOGRAPHIC)

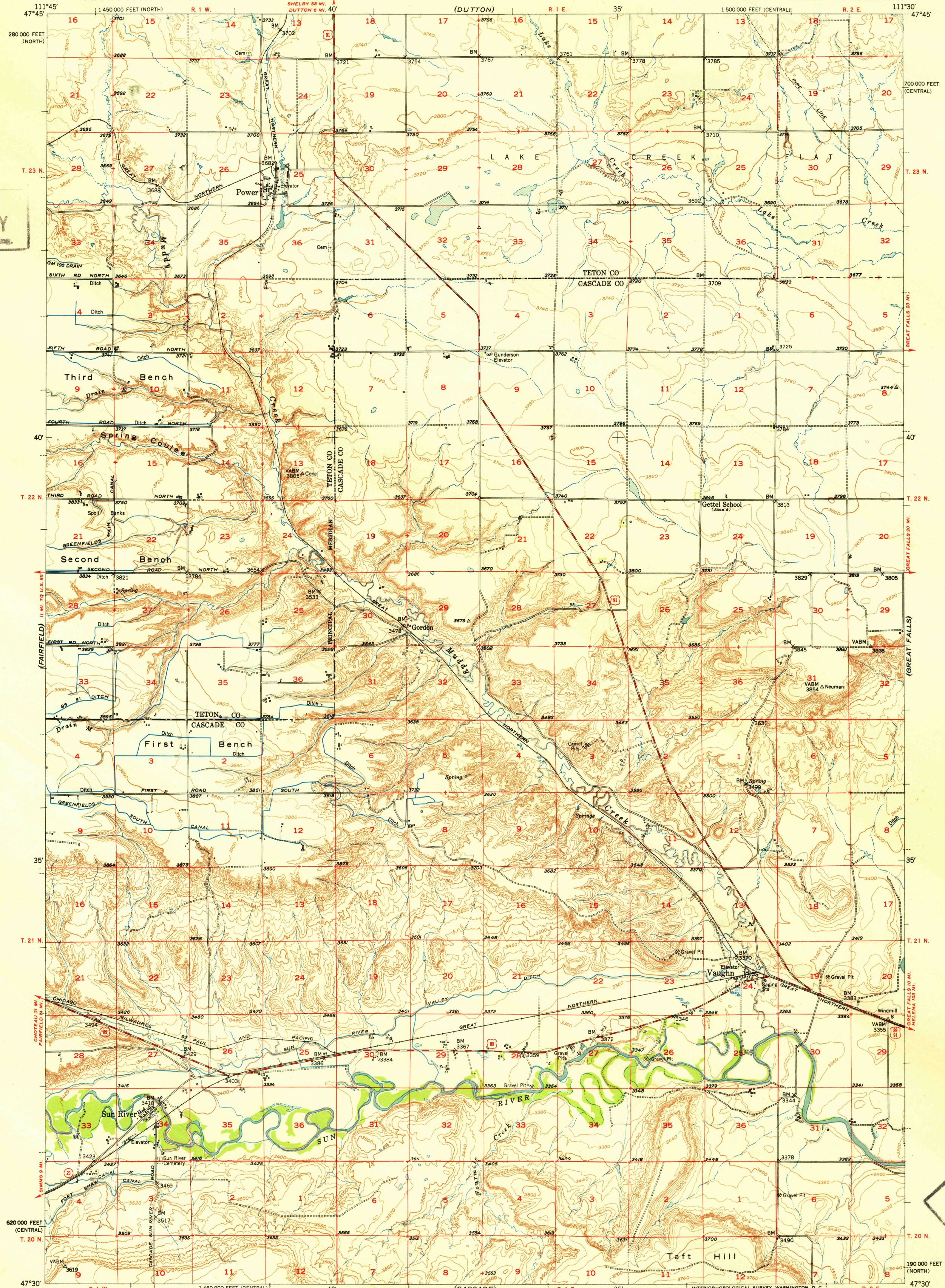

U.S.G.S.
FILE COPY
Inspection and Editing.

U.S.G.S.
FILE COPY
Inspection and Editing.

Mapped, edited, and published by the Geological Survey as part of the Department of the Interior program for the development of the Missouri River Basin Control by USGS and USC&GS
Topography from aerial photographs by multiplex methods Aerial photographs taken July 1946. Field check 1949
Polyconic projection. 1927 North American datum 10,000-foot grid based on Montana coordinate system, central zone and north zone.

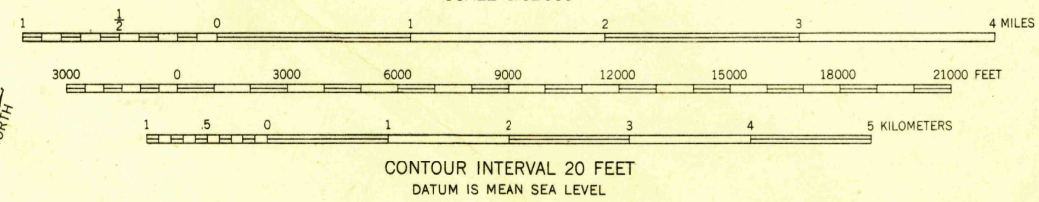

ROAD CLASSIFICATION
Heavy-duty... 4 LANE 16 LANE Light-duty...
Medium-duty... 4 LANE 16 LANE Unimproved dirt...
U. S. Route State Route

APPROXIMATE MEAN DECLINATION, 1949

THIS MAP COMPLIES WITH NATIONAL MAP ACCURACY STANDARDS
FOR SALE BY U.S. GEOLOGICAL SURVEY, FEDERAL CENTER, DENVER, COLORADO OR WASHINGTON 25, D. C.
A FOLDER DESCRIBING TOPOGRAPHIC MAPS AND SYMBOLS IS AVAILABLE ON REQUEST

VAUGHN, MONT.
N4730-W11130/15
EDITION OF 1952

2115

MAR 3 1952