

679 N W (NEW ROCKFORD)

UNITED STATES DEPARTMENT OF THE INTERIOR GEOLOGICAL SURVEY

BARLOW QUADRANGLE NORTH DAKOTA 7.5 MINUTE SERIES (TOPOGRAPHIC) SW/4 NEW ROCKFORD 15' QUADRANGLE

679 N E (NEW ROCKFORD NE)

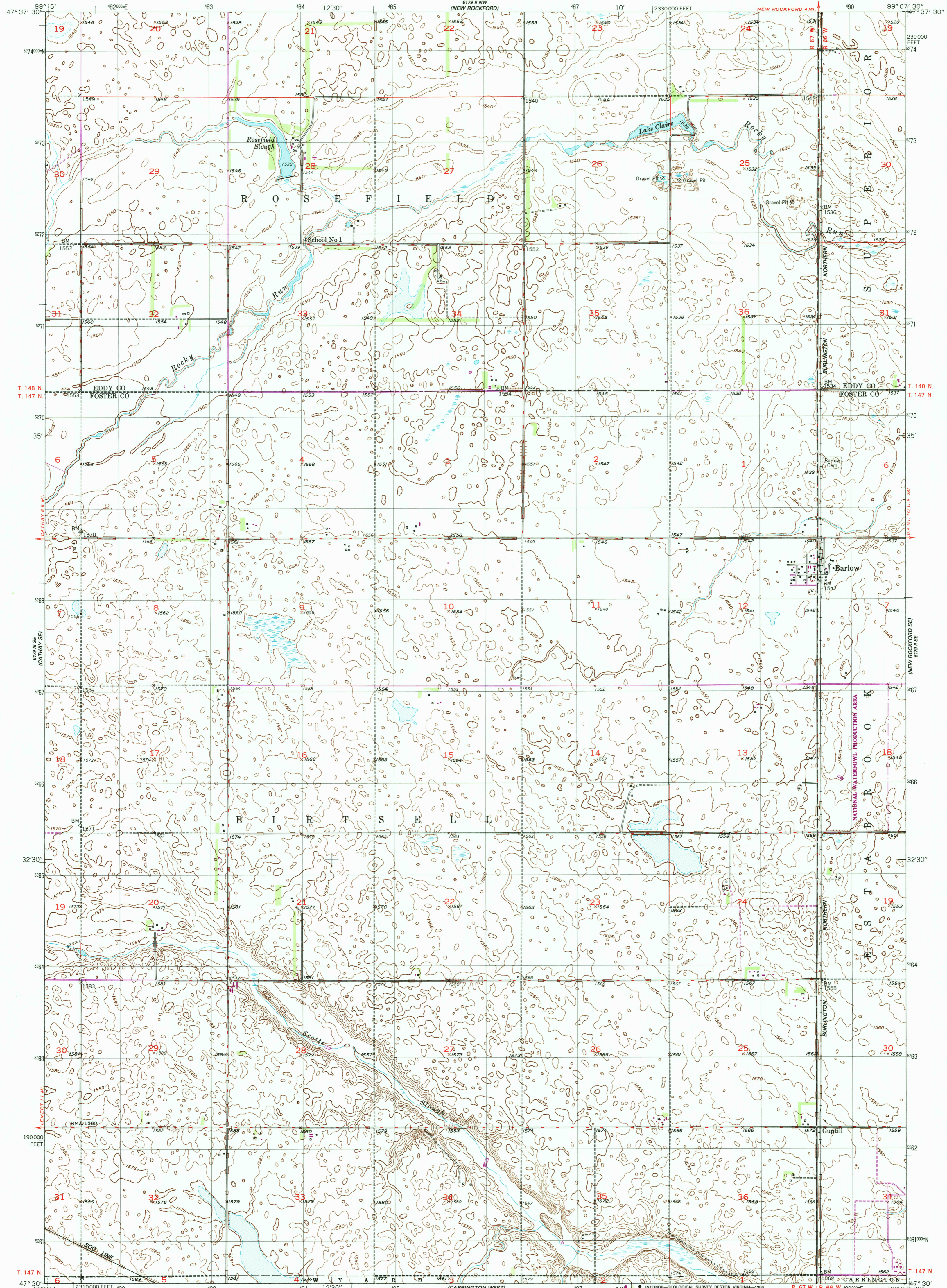

Mapped, edited, and published by the Geological Survey as part of the Department of the Interior program for the development of the Missouri River Basin... Culture and drainage in part compiled from aerial photographs taken 1944... Topography by plane-table methods 1949... POLYCONIC PROJECTION. 1927 North American datum 10,000-foot grid based on North Dakota coordinate system, north zone... 1000-meter Universal Transverse Mercator grid, zone 14 To place on the predicted North American Datum 1983, move the projection lines 4 meters north and 29 meters east as shown by dashed corner ticks There may be private inholdings within the boundaries of the National or State reservations shown on this map

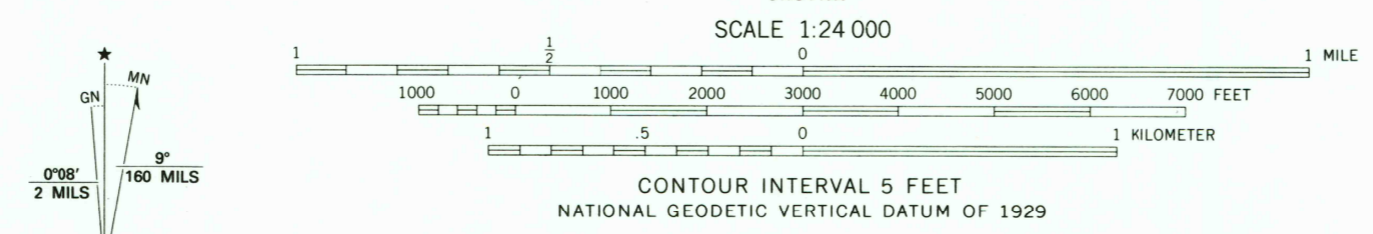

ROAD CLASSIFICATION  
HARD SURFACE ALL WEATHER ROADS DRY WEATHER ROADS  
Heavy-duty 2 LANE 16 LANE Improved dirt  
Medium-duty 2 LANE 16 LANE Unimproved dirt  
Loose-surface, graded, or narrow hard-surface  
U. S. Route State Route

BARLOW, N. DAK.  
SW/4 NEW ROCKFORD 15' QUADRANGLE  
47099-E2-TF-024  
1950  
PHOTOREVISED 1986  
DMA 6179 11 SW-SERIES V871

USGS NMD HISTORICAL MAP  
AUG 14 1986  
REC'D FILE COPY