

UNITED STATES  
DEPARTMENT OF THE INTERIOR  
GEOLOGICAL SURVEY

BEACH WEST QUADRANGLE  
NORTH DAKOTA-MONTANA  
7.5 MINUTE SERIES (TOPOGRAPHIC)

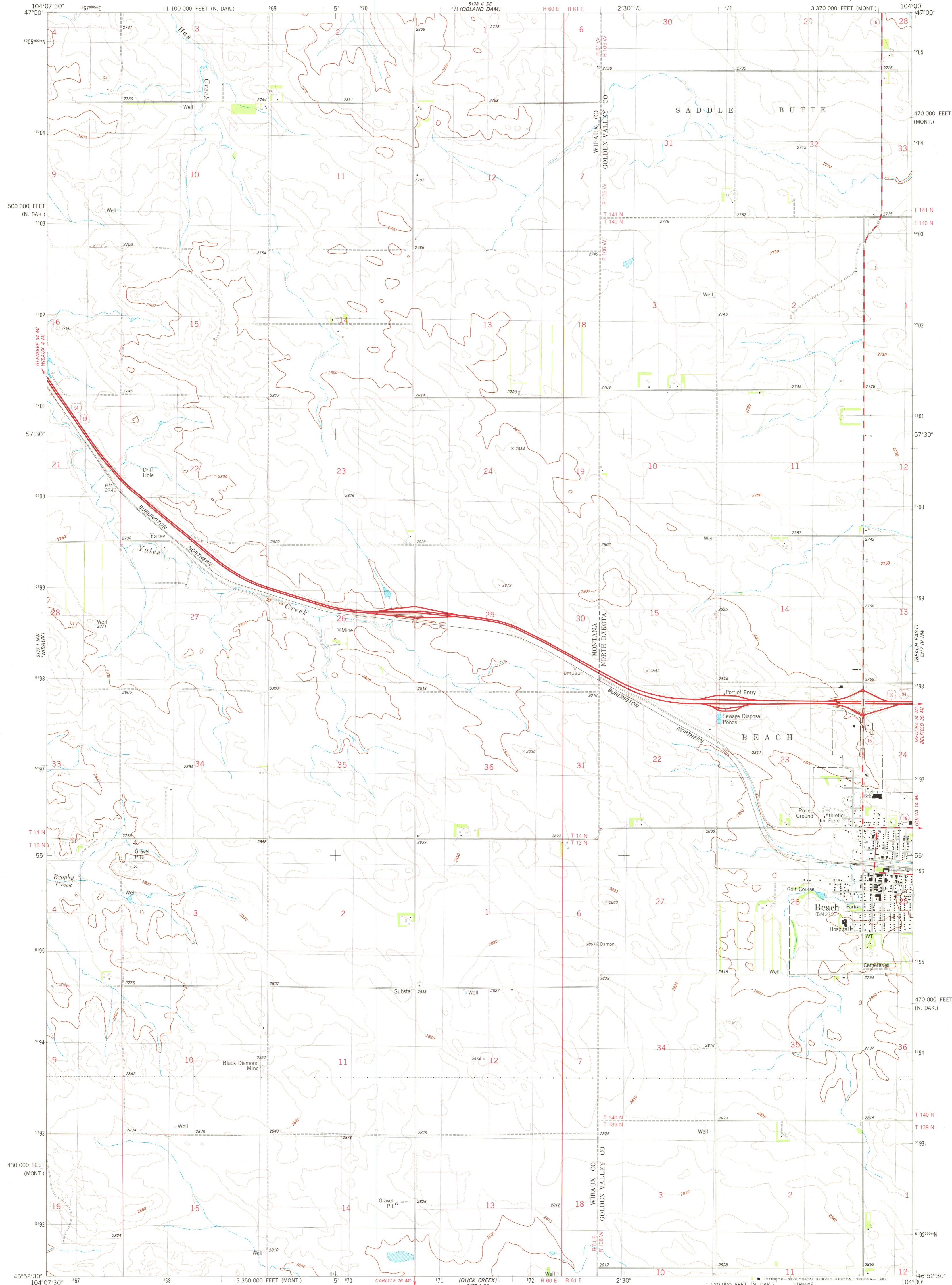

Mapped, edited, and published by the Geological Survey  
Control by USGS and NOS/NOAA  
Topography by photogrammetric methods from aerial photographs taken 1974. Field checked 1976. Map edited 1982  
Projection: Montana coordinate system, central zone (Lambert conformal conic)  
10,000-foot grid ticks based on Montana coordinate system, central zone and North Dakota coordinate system south zone 1000-meter Universal Transverse Mercator grid, zone 13 1927 North American datum  
To place on the predicted North American Datum 1983 move the projection lines 4 meters north and 40 meters east as shown by dashed corner ticks  
Fine red dashed lines indicate selected fence lines

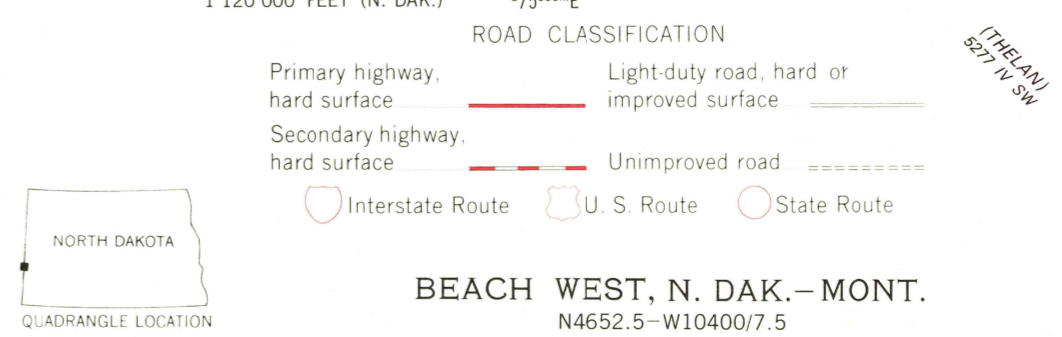
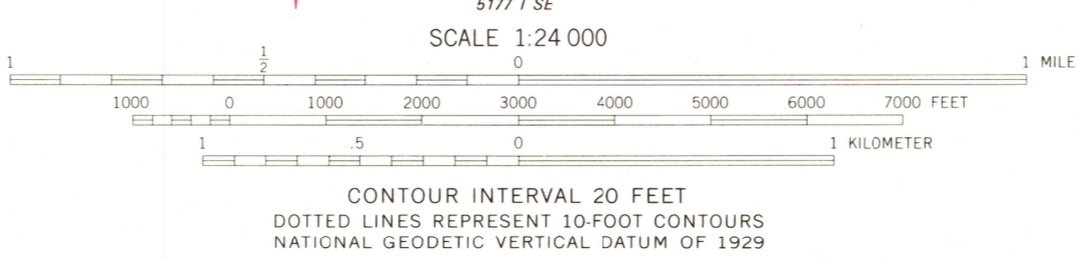
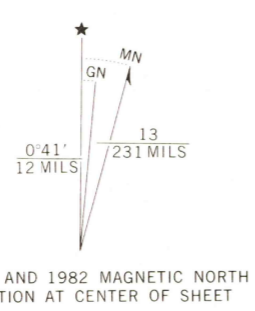

THIS MAP COMPLIES WITH NATIONAL MAP ACCURACY STANDARDS  
FOR SALE BY U.S. GEOLOGICAL SURVEY, DENVER, COLORADO 80225, OR RESTON, VIRGINIA 22092  
AND BY THE STATE WATER COMMISSION, BISMARCK, NORTH DAKOTA 58501  
A FOLDER DESCRIBING TOPOGRAPHIC MAPS AND SYMBOLS IS AVAILABLE ON REQUEST

BEACH WEST, N. DAK.-MONT.  
N4652.5-W10400/7.5  
1982  
DMA 5177 1 NE-SERIES V894

AUG 13 1982

2700