

U. S. G. S.  
**FILE COPY**  
Impression and fading.

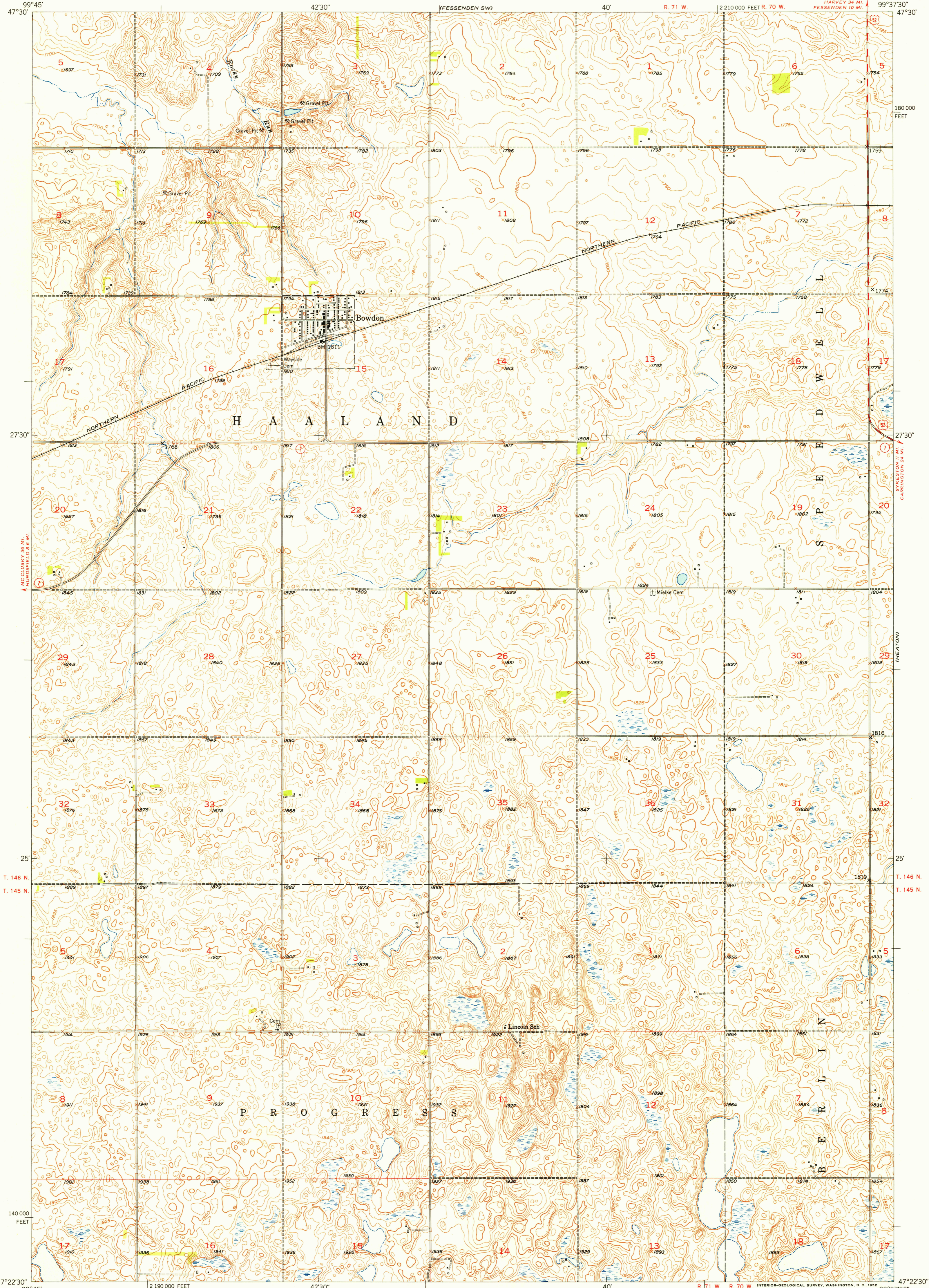

Mapped, edited, and published by the Geological Survey as part of the Department of the Interior program for the development of the Missouri River Basin.

Control by USGS and USC&GS

Culture and drainage in part compiled from aerial photographs taken 1940. Topography by plane-table surveys 1951

Polyconic projection. 1927 North American datum  
10,000-foot grid based on North Dakota coordinate system, north zone

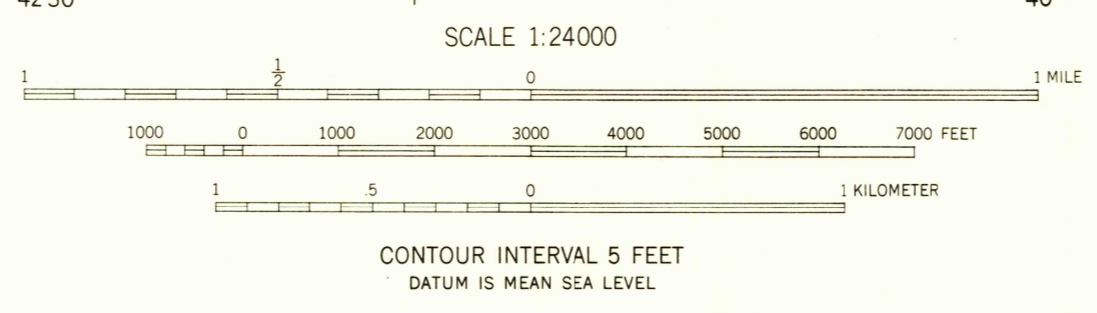
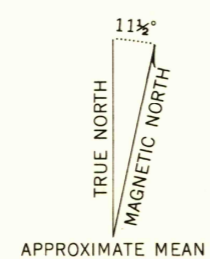

ROAD CLASSIFICATION

Heavy-duty	2 LANE 6 LANE	Light-duty
Medium-duty	2 LANE 6 LANE	Unimproved dirt
U. S. Route		State Route

U. S. G. S.  
**FILE COPY**  
Impression and fading.

THIS MAP COMPLIES WITH NATIONAL MAP ACCURACY STANDARDS  
FOR SALE BY U. S. GEOLOGICAL SURVEY, FEDERAL CENTER, DENVER, COLORADO OR WASHINGTON 25, D. C.  
AND BY THE STATE WATER CONSERVATION COMMISSION, BISMARCK, NORTH DAKOTA  
A FOLDER DESCRIBING TOPOGRAPHIC MAPS AND SYMBOLS IS AVAILABLE ON REQUEST

BOWDON, N. DAK.  
N4722.5-W9937.5/7.5

1951