

387 W 1/2 SE
1/4 NW 1/4 SE

387 E 1/2 SE
1/4 NW 1/4 SE

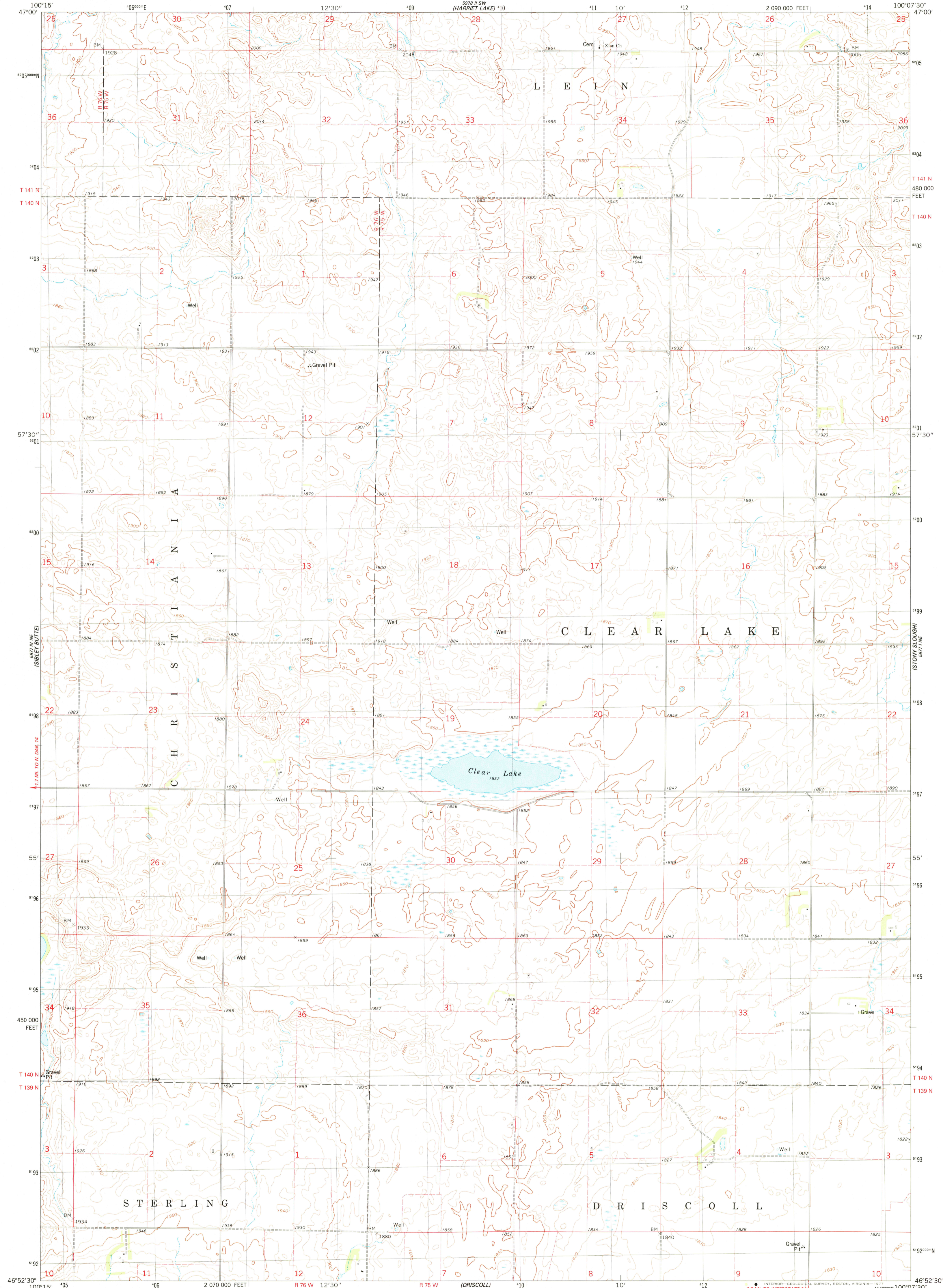

Mapped, edited, and published by the Geological Survey in cooperation with the North Dakota Water Commission. Control by USGS and NOS/NOAA. Topography by photogrammetric methods from aerial photographs taken 1974. Field checked 1975. Projection and 10,000-foot grid ticks: North Dakota coordinate system, south zone (Lambert conformal conic) 1000-metre Universal Transverse Mercator grid, zone 14. 1927 North American datum. Fine red dashed lines indicate selected fence and field lines where generally visible on aerial photographs. This information is unchecked.

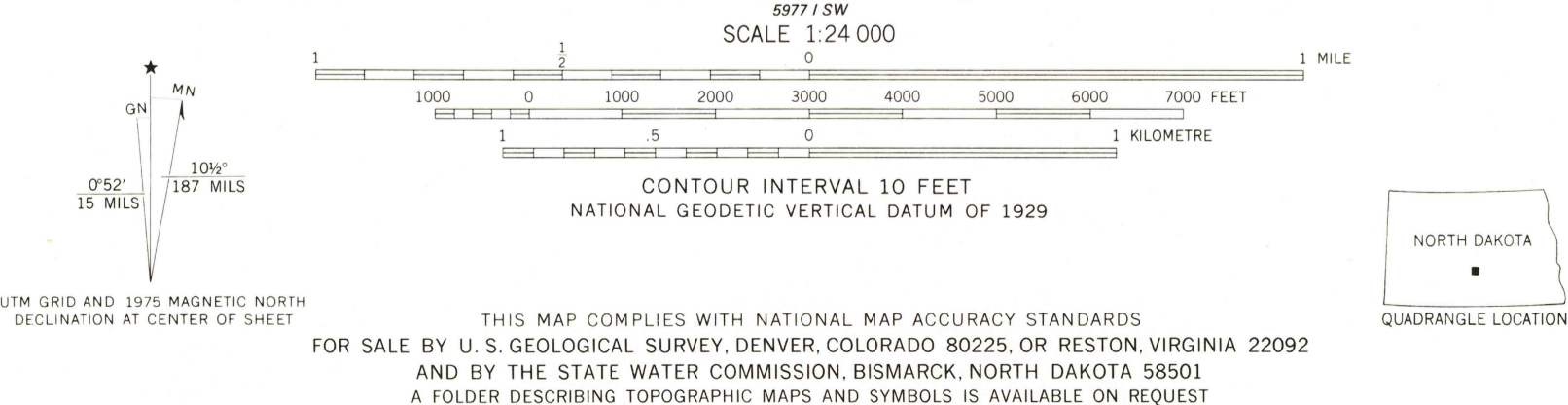

ROAD CLASSIFICATION
Primary highway, hard surface
Secondary highway, hard surface
Unimproved road
Light-duty road, hard or improved surface
Interstate Route
U. S. Route
State Route

CLEAR LAKE, N. DAK.
USGS Historical File Topographic Division
NW/4 DRISCOLL 15' QUADRANGLE
N4652.5-W10007.5/7.5
1975
AMS 5977 1 NW—SERIES V871

2800
OCT 18 1977