

(DEERING NW)
101°07'30"
48°22'30"

UNITED STATES
DEPARTMENT OF THE INTERIOR
GEOLOGICAL SURVEY

DEERING SE QUADRANGLE
NORTH DAKOTA
7.5 MINUTE SERIES (TOPOGRAPHIC)

(GRANVILLE NW)
101°00'
48°22'30"

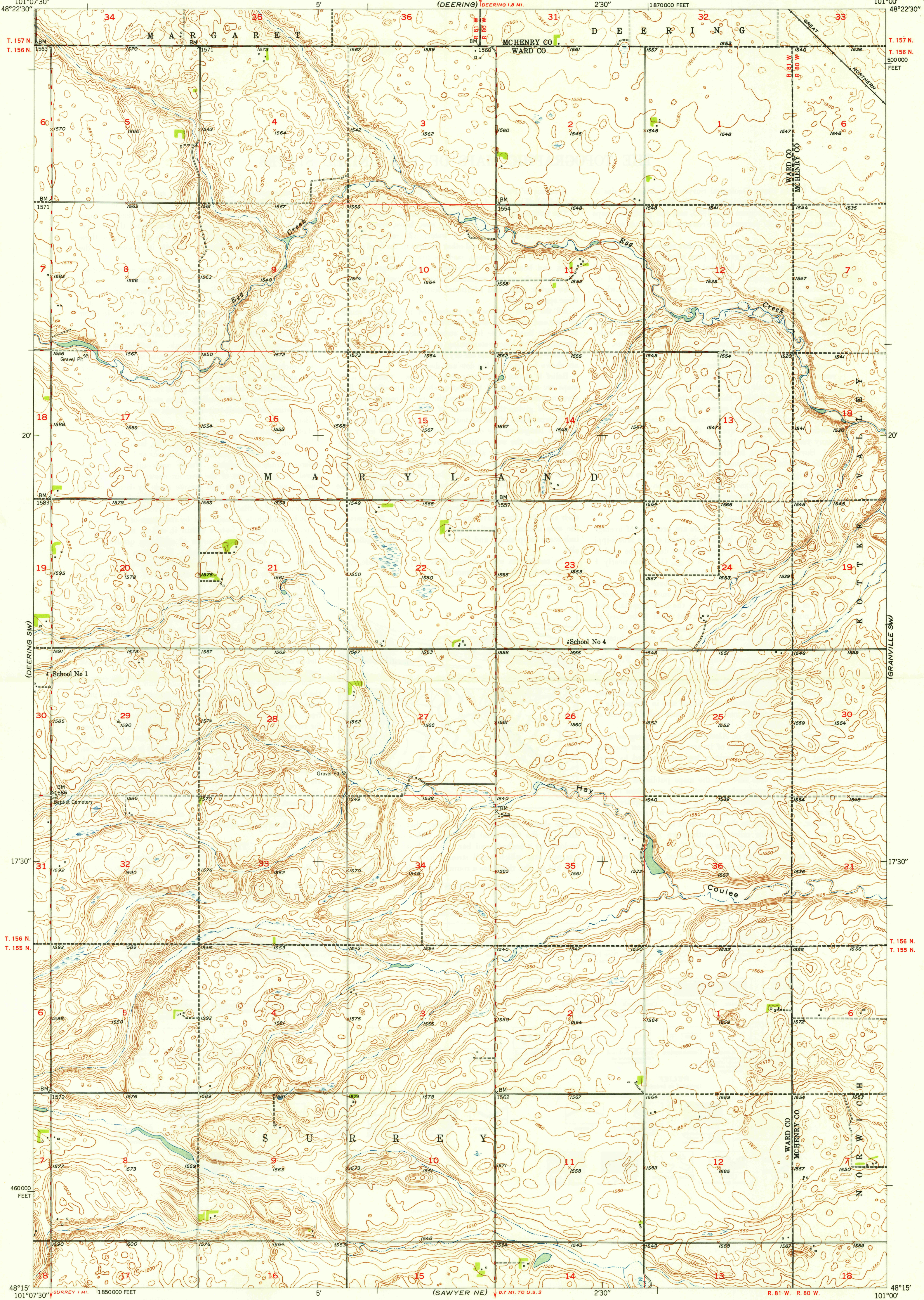

U.S.G.S.
FILE COPY
Inspection and Mailing

U.S.G.S.
FILE COPY
Inspection and Mailing

Mapped, edited, and published by the Geological Survey
as part of the Department of the Interior program
for the development of the Missouri River Basin
Control by USGS and USC&GS
Culture and drainage in part compiled from
aerial photographs taken 1946
Topography by plane-table methods 1948
Polyconic projection. 1927 North American datum
10000-foot grid based on North Dakota coordinate system,
north zone

TRUE NORTH
MAGNETIC NORTH
APPROXIMATE MEAN
DECLINATION, 1948

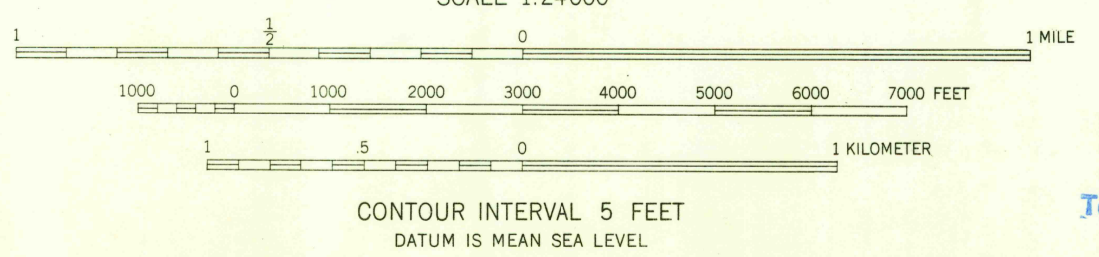

ROAD CLASSIFICATION
HARD-SURFACE ALL WEATHER ROADS DRY WEATHER ROADS
Heavy-duty ———— GRAVEL LAINE Improved dirt ————
Medium-duty ———— GRAVEL LAINE Unimproved dirt ————
Loose-surface, graded, or narrow hard-surface ————
U. S. Route ———— State Route ————

USGS
Historical File
Topographic Division

DEERING SE, N. DAK.
N4815-W10100/7.5
EDITION OF 1949

U.S.G.S.
FILE COPY
Inspection and Mailing

THIS MAP COMPLIES WITH NATIONAL MAP ACCURACY STANDARDS
FOR SALE BY U. S. GEOLOGICAL SURVEY, WASHINGTON 25, D. C.