

UNITED STATES
DEPARTMENT OF THE INTERIOR
GEOLOGICAL SURVEY

FLORA QUADRANGLE
NORTH DAKOTA-BENSON CO.
7.5 MINUTE SERIES (TOPOGRAPHIC)
NW/4 FLORA 15' QUADRANGLE

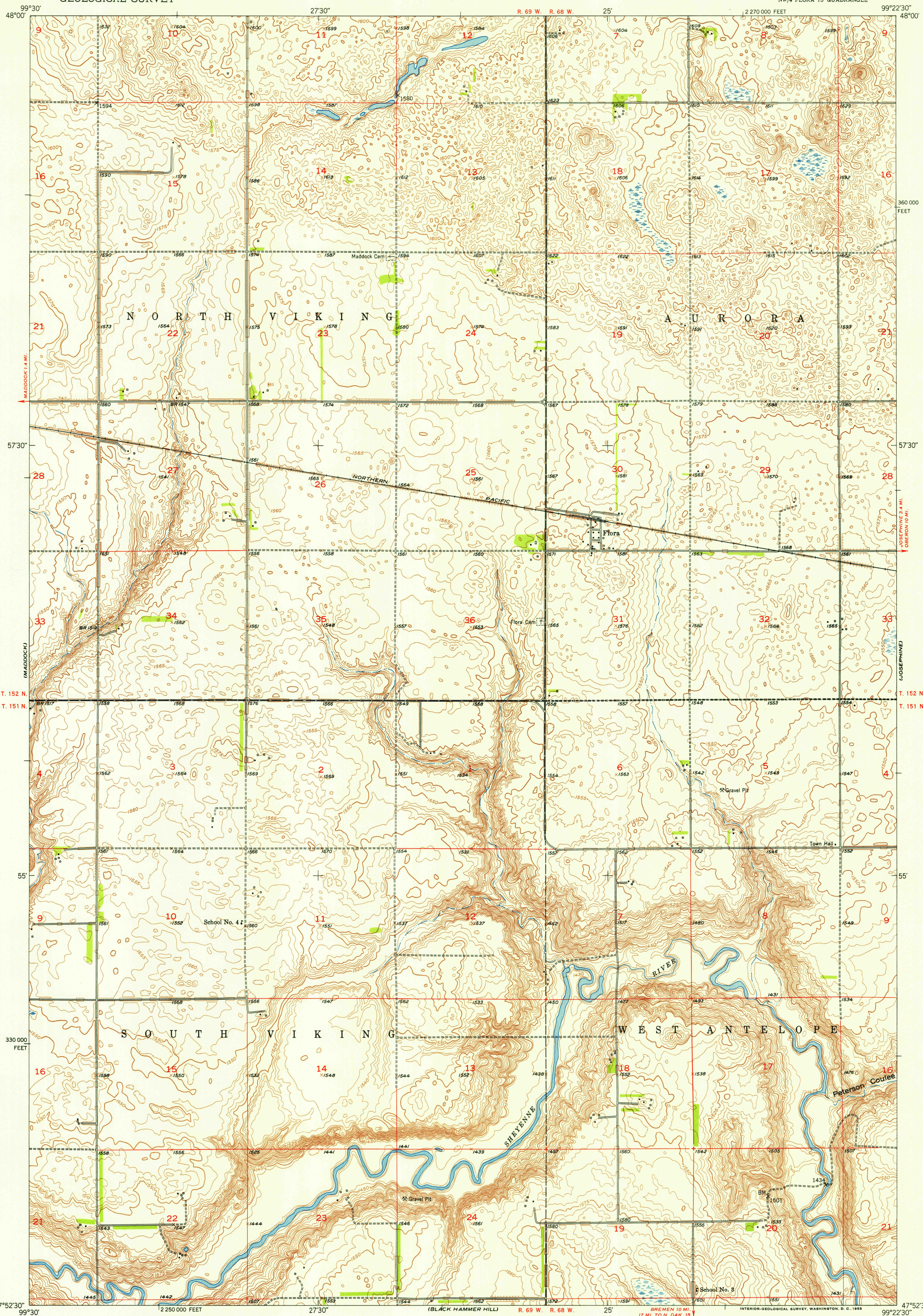

Maped, edited, and published by the Geological Survey
as part of the Department of the Interior program
for the development of the Missouri River Basin
Control by USGS and USC&GS
Culture and drainage in part compiled from aerial photographs
taken 1941. Topography by plane-table surveys 1951
Polyconic projection. 1927 North American datum
10,000-foot grid based on North Dakota coordinate system,
north zone

APPROXIMATE MEAN
DECLINATION, 1951

THIS MAP COMPLIES WITH NATIONAL MAP ACCURACY STANDARDS
FOR SALE BY U.S. GEOLOGICAL SURVEY, FEDERAL CENTER, DENVER, COLORADO OR WASHINGTON 25, D. C.
AND BY THE STATE WATER CONSERVATION COMMISSION, BISMARCK, NORTH DAKOTA
A FOLDER DESCRIBING TOPOGRAPHIC MAPS AND SYMBOLS IS AVAILABLE ON REQUEST

ROAD CLASSIFICATION
Heavy-duty ——— 4 LANE 16 LANE Light-duty ———
Medium-duty ——— 4 LANE 16 LANE Unimproved dirt ———
U. S. Route ——— State Route ———

FLORA, N. DAK.
NW/4 FLORA 15' QUADRANGLE
N4752.5-W9922.5/7.5

1951

FEB 4 1953

2600