

U.S.G.S.  
FILE COPY  
Inspection and Editing.

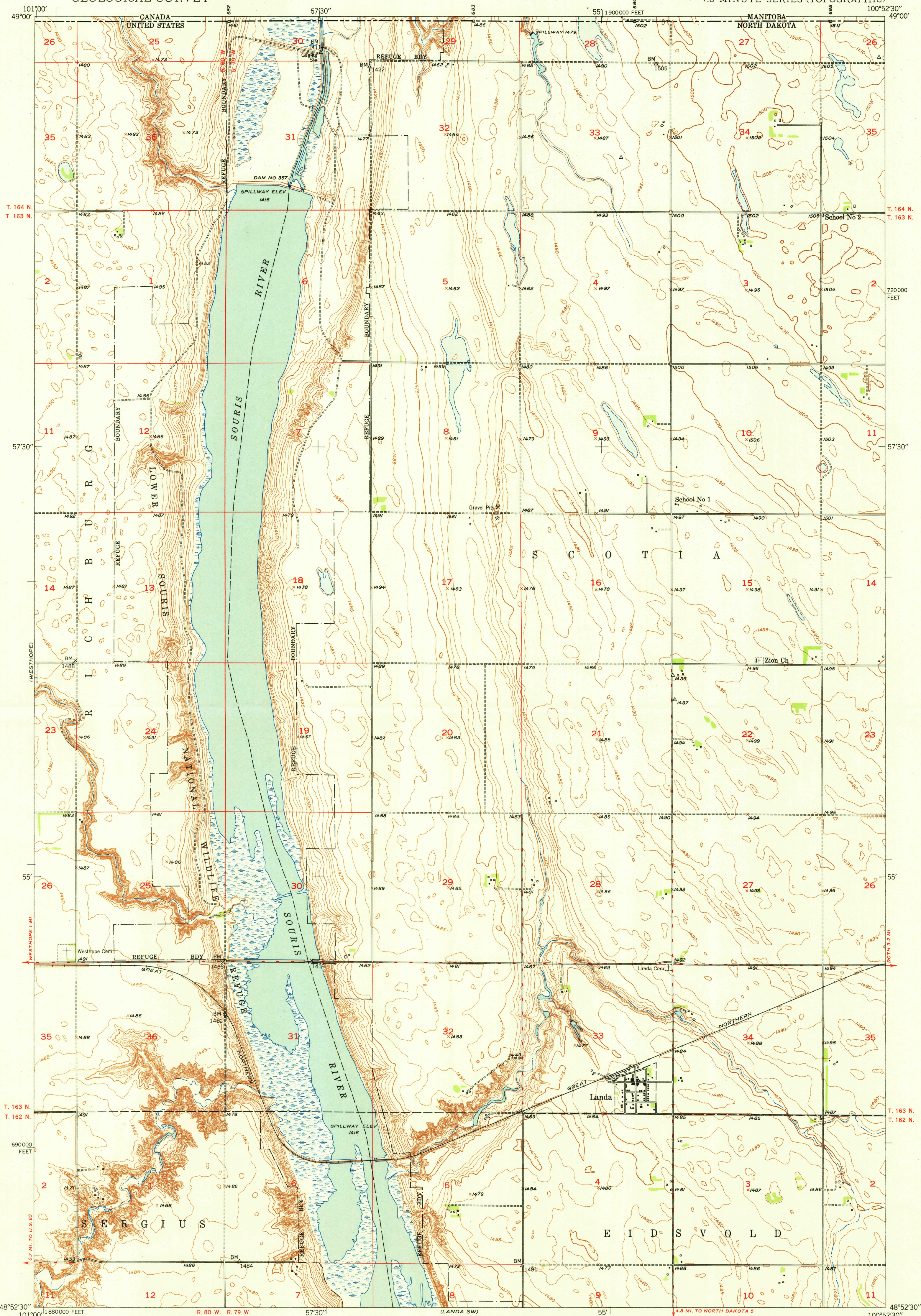

Mapped, edited, and published by the Geological Survey as part of the Department of the Interior program for the development of the Missouri River Basin  
Control by International Boundary Commission, USGS, and USC&GS  
Topography by multiplex methods from aerial photographs taken 1948, and by plane-table surveys 1949  
Field check 1949  
Polyconic projection. 1927 North American datum  
10,000-foot grid based on North Dakota coordinate system, north zone

SCALE 1:24,000  
CONTOUR INTERVAL 5 FEET  
DATUM IS MEAN SEA LEVEL

ROAD CLASSIFICATION  
HARD-SURFACE ALL WEATHER ROADS  
Heavy-duty LANE LANE  
Medium-duty LANE LANE  
Loose-surface, graded, or narrow hard-surface

DRY WEATHER ROADS  
Improved dirt  
Unimproved dirt

U.S. Route  
State Route

USCS  
Historical File  
Topographic Division

LANDA, N. DAK.  
N4852.5-W10052.5/7.5  
EDITION OF 1950

THIS MAP COMPLIES WITH NATIONAL MAP ACCURACY STANDARDS  
FOR SALE BY U. S. GEOLOGICAL SURVEY, FEDERAL CENTER, DENVER, COLORADO OR WASHINGTON 25, D. C.  
A FOLDER DESCRIBING TOPOGRAPHIC MAPS AND SYMBOLS IS AVAILABLE ON REQUEST

U.S.G.S.  
FILE COPY  
Inspection and Editing.

SEP 7 1950