

6381 IV SW (WALLES)

UNITED STATES
DEPARTMENT OF THE INTERIOR
GEOLOGICAL SURVEY

LANGDON WEST QUADRANGLE
NORTH DAKOTA—CAVALIER CO.
7.5 MINUTE SERIES (TOPOGRAPHIC)

6381 IV NE (MOUNTA)

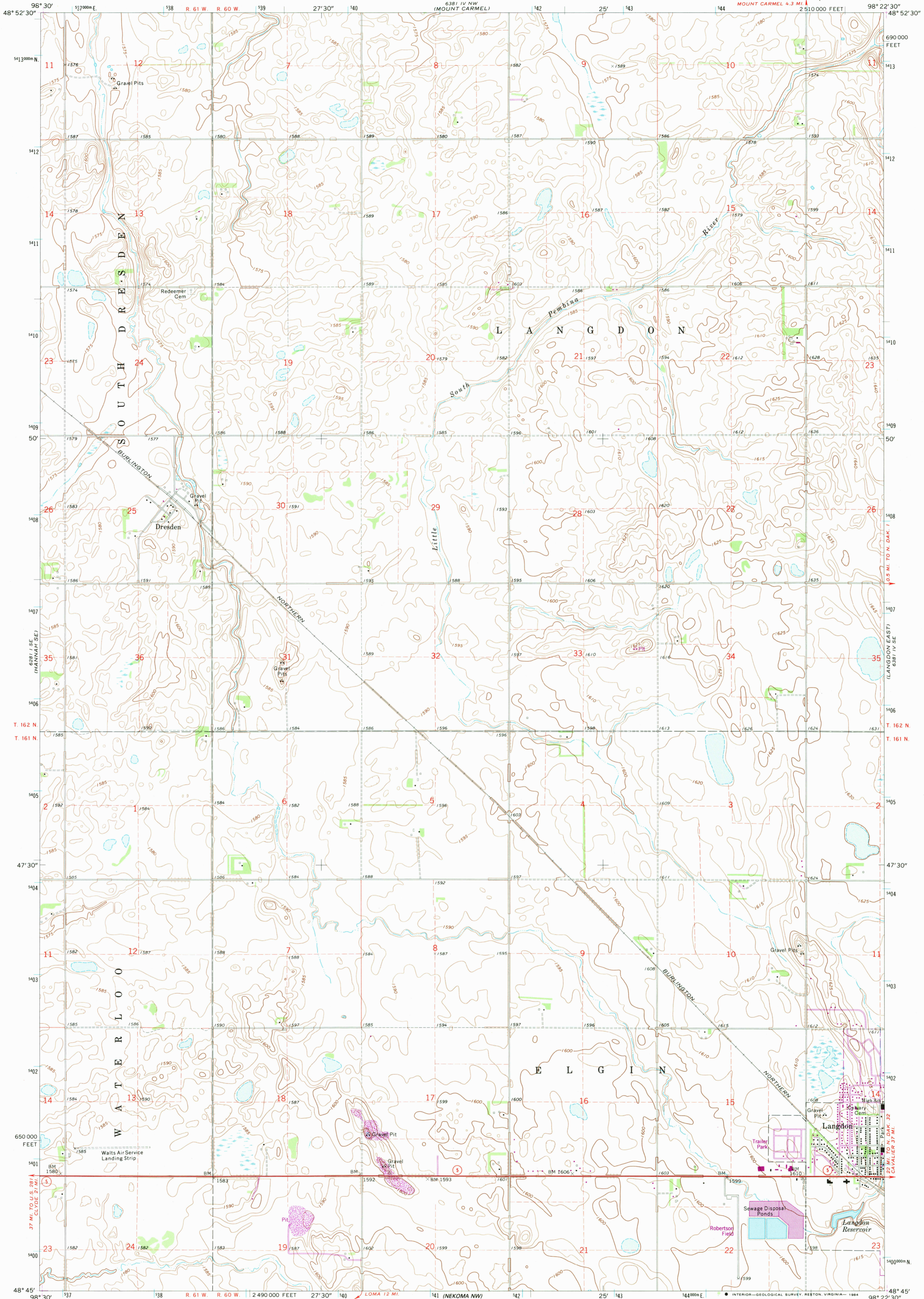

Mapped, edited, and published by the Geological Survey

Control by USGS and USC&GS
Topography by photogrammetric methods from aerial photographs taken 1967. Field checked 1970
Polyconic projection. 1927 North American datum
10,000-foot grid based on North Dakota coordinate system, north zone
1,000-meter Universal Transverse Mercator grid ticks, zone 14, shown in blue
To place on the predicted North American Datum 1983, move the projection lines 3 meters north and 27 meters east as shown by dashed corner ticks
Revisions shown in purple compiled from aerial photographs taken 1981 and other sources. This information not field checked. Map edited 1983

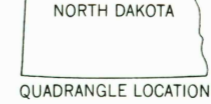
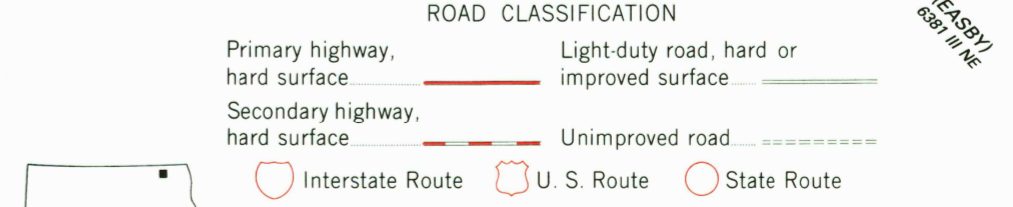
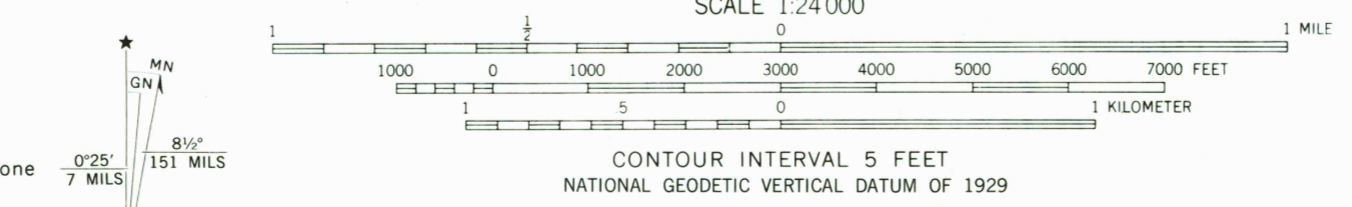

UTM GRID AND 1983 MAGNETIC NORTH DECLINATION AT CENTER OF SHEET
THIS MAP COMPLIES WITH NATIONAL MAP ACCURACY STANDARDS
FOR SALE BY U.S. GEOLOGICAL SURVEY, DENVER, COLORADO 80225, OR RESTON, VIRGINIA 22092
AND NORTH DAKOTA WATER COMMISSION, BISMARCK, NORTH DAKOTA 58501
A FOLDER DESCRIBING TOPOGRAPHIC MAPS AND SYMBOLS IS AVAILABLE ON REQUEST

LANGDON WEST, N. DAK.
48098-G4-TF-024

1970
PHOTOREVISED 1983
DMA 6381 IV SW—SERIES V871

USGS AND HISTORICAL MAP ARCHIVE