

UNITED STATES
DEPARTMENT OF THE INTERIOR
GEOLOGICAL SURVEY

LANSFORD SE QUADRANGLE
NORTH DAKOTA
7.5 MINUTE SERIES (TOPOGRAPHIC)

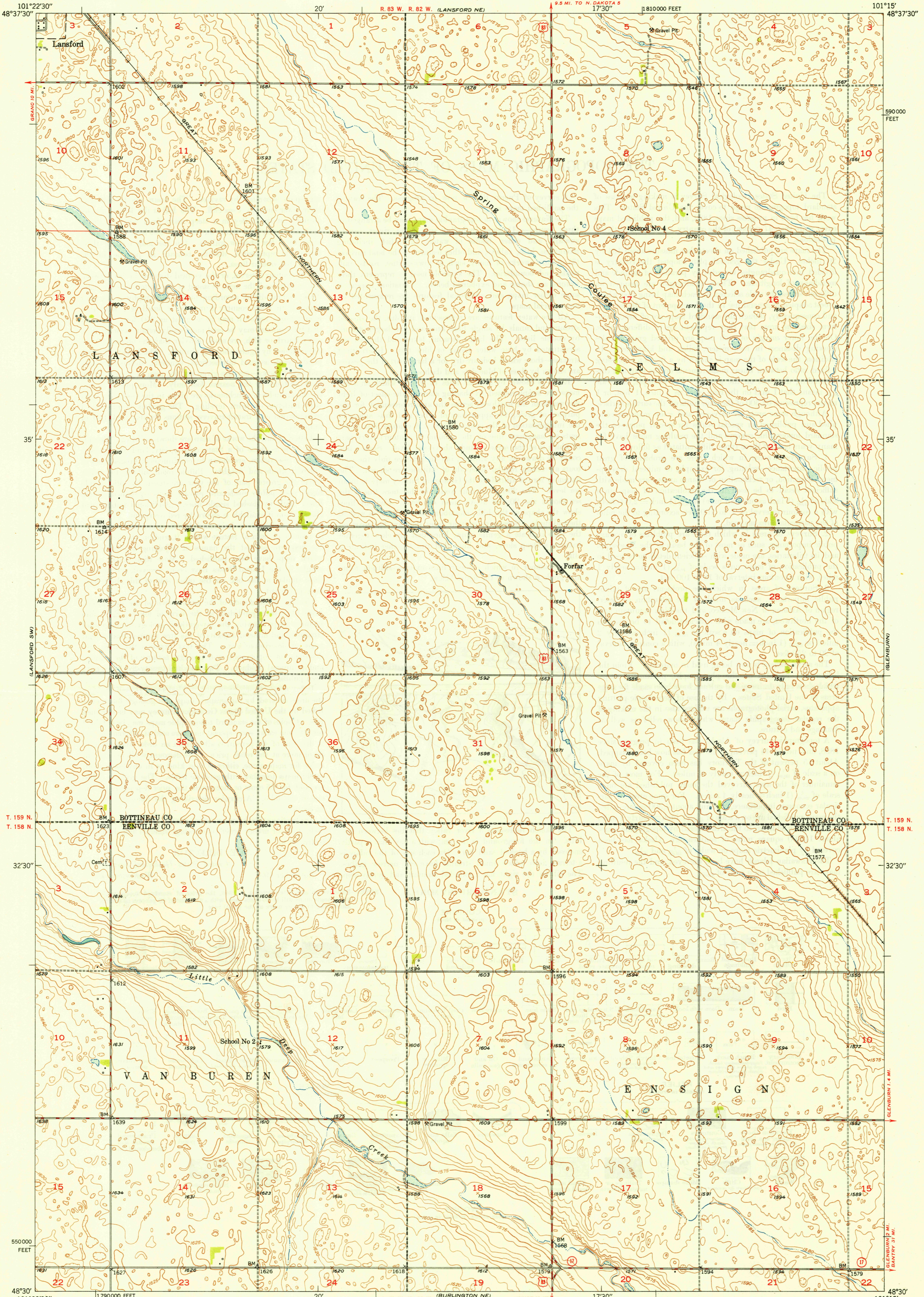

U.S.G.S.
FILE COPY
Inspection and Filing

(LANSFORD NW)
101°22'30"
48°37'30"

Maped, edited, and published by the Geological Survey as part of the Department of the Interior program for the development of the Missouri River Basin. Control by USGS and USC&GS. Culture and drainage in part compiled from aerial photographs taken 1946. Topography by plane-table methods 1948. Polyconic projection. 1927 North American datum. 10,000-foot grid based on North Dakota coordinate system, north zone.

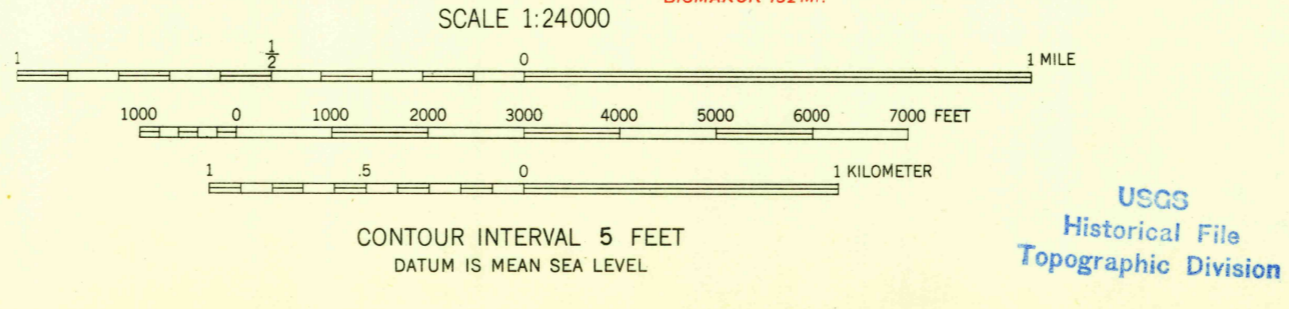
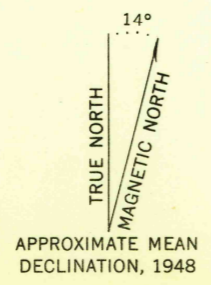

ROAD CLASSIFICATION

HARD-SURFACE ALL WEATHER ROADS	DRY WEATHER ROADS
Heavy-duty — 4 LANE 16 LANE	Improved dirt —
Medium-duty — 4 LANE 16 LANE	Unimproved dirt —
Loose-surface, graded, or narrow hard-surface —	
U. S. Route	State Route

LANSFORD SE, N. DAK.
N4830-W10115/7.5

THIS MAP COMPLIES WITH NATIONAL MAP ACCURACY STANDARDS FOR SALE BY U. S. GEOLOGICAL SURVEY, DENVER, COLORADO OR WASHINGTON 25, D. C.

EDITION OF 1949

U.S.G.S.
FILE COPY
Inspection and Filing

OCT 27 1949 2090