

UNITED STATES
DEPARTMENT OF THE INTERIOR
GEOLOGICAL SURVEY

LEEDS NE QUADRANGLE
NORTH DAKOTA—TOWNER CO.
7.5 MINUTE SERIES (TOPOGRAPHIC)

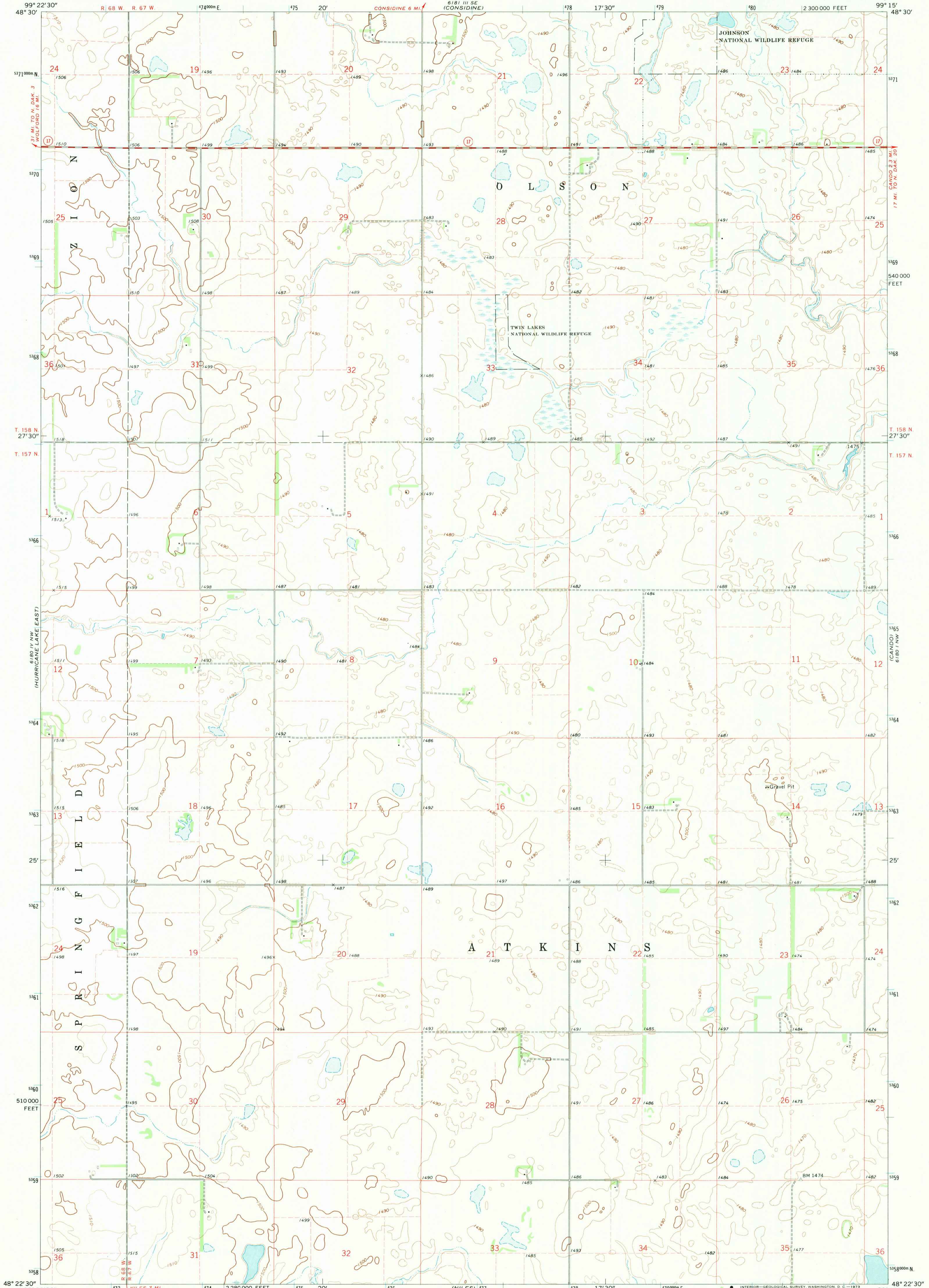

Mapped, edited, and published by the Geological Survey
Control by USGS and USC&GS
Topography by photogrammetric methods from aerial photographs taken 1968. Field checked 1971
Polyconic projection. 1927 North American datum. 10,000-foot grid based on North Dakota coordinate system, north zone. 1000-meter Universal Transverse Mercator grid ticks, zone 14, shown in blue.
Fine red dashed lines indicate selected fence and field lines where generally visible on aerial photographs.
This information is unchecked

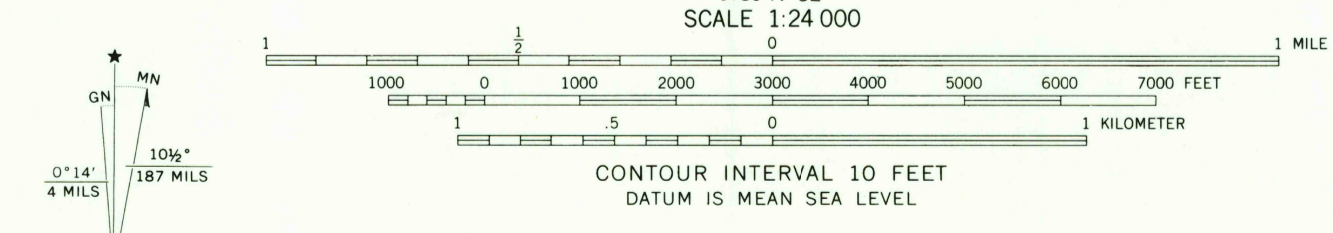

ROAD CLASSIFICATION
Primary highway, hard surface — Light-duty road, hard or improved surface
Secondary highway, hard surface — Unimproved road
Interstate Route — U. S. Route — State Route

THIS MAP COMPLIES WITH NATIONAL MAP ACCURACY STANDARDS
FOR SALE BY U. S. GEOLOGICAL SURVEY, DENVER, COLORADO 80225, OR WASHINGTON, D. C. 20242
AND BY THE STATE WATER COMMISSION, BISMARCK, NORTH DAKOTA 58501
A FOLDER DESCRIBING TOPOGRAPHIC MAPS AND SYMBOLS IS AVAILABLE ON REQUEST

LEEDS NE, N. DAK.
N4822.5—W9915.7.5
1971
AMS 6180 IV NE—SERIES V871

MAY 14 1973
2765