

UNITED STATES
DEPARTMENT OF THE INTERIOR
GEOLOGICAL SURVEY

LITCHVILLE SE QUADRANGLE
NORTH DAKOTA
7.5 MINUTE SERIES (TOPOGRAPHIC)

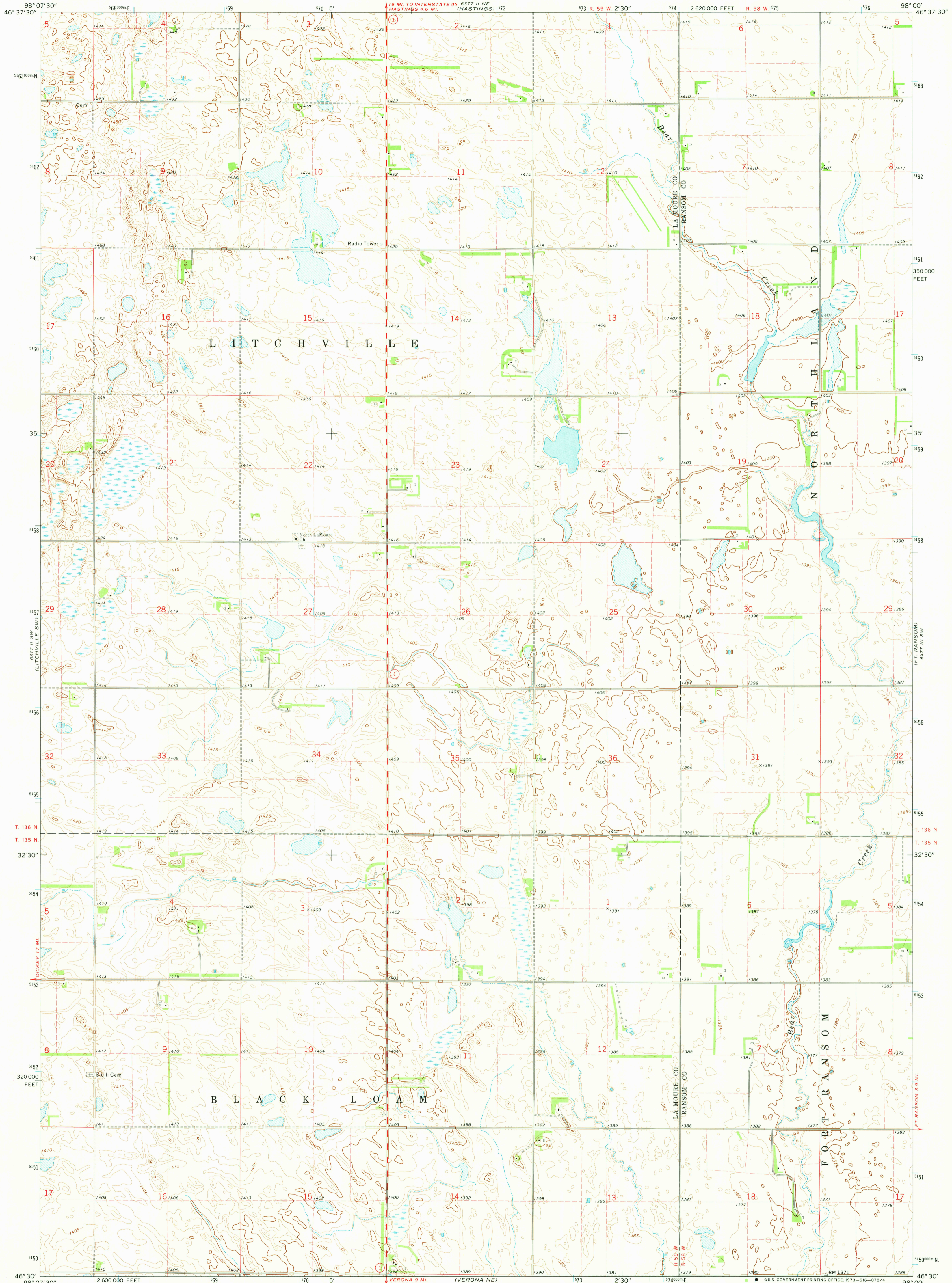

Mapped, edited, and published by the Geological Survey
Control by USGS and USC&GS
Topography by photogrammetric methods from aerial
photographs taken 1969. Field checked 1970
Polyconic projection. 1927 North American datum
10,000-foot grid based on North Dakota coordinate system,
south zone
1000-meter Universal Transverse Mercator grid ticks,
zone 14, shown in blue
Fine red dashed lines indicate selected fence and field lines where
generally visible on aerial photographs
This information is unchecked

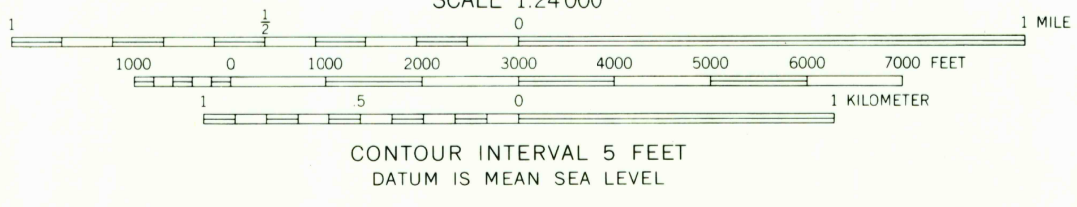
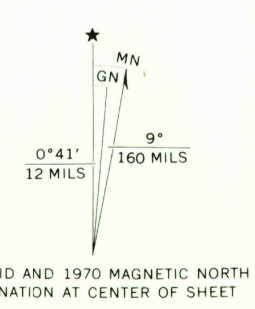

ROAD CLASSIFICATION

Primary highway, hard surface ——— Light-duty road, hard or improved surface

Secondary highway, hard surface ——— Unimproved road

Interstate Route U.S. Route State Route

NORTH DAKOTA
QUADRANGLE LOCATION

THIS MAP COMPLIES WITH NATIONAL MAP ACCURACY STANDARDS
FOR SALE BY U. S. GEOLOGICAL SURVEY, DENVER, COLORADO 80225, OR WASHINGTON, D. C. 20242
AND BY THE STATE WATER COMMISSION, BISMARCK, NORTH DAKOTA 58501
A FOLDER DESCRIBING TOPOGRAPHIC MAPS AND SYMBOLS IS AVAILABLE ON REQUEST

LITCHVILLE SE, N. DAK.
N4630—W9800/7.5

1970

AMS 6377 II SE—SERIES V871

HO-020
2000
USGS
HISTORICAL FILE
TOPOGRAPHIC DIVISION

APR 9 1973