

5878 I SW  
MERCER SE

UNITED STATES  
DEPARTMENT OF THE INTERIOR  
GEOLOGICAL SURVEY



REGAN QUADRANGLE  
NORTH DAKOTA—BURLEIGH CO.  
7.5 MINUTE SERIES (TOPOGRAPHIC)

5878 I SW  
HOSE LAKE

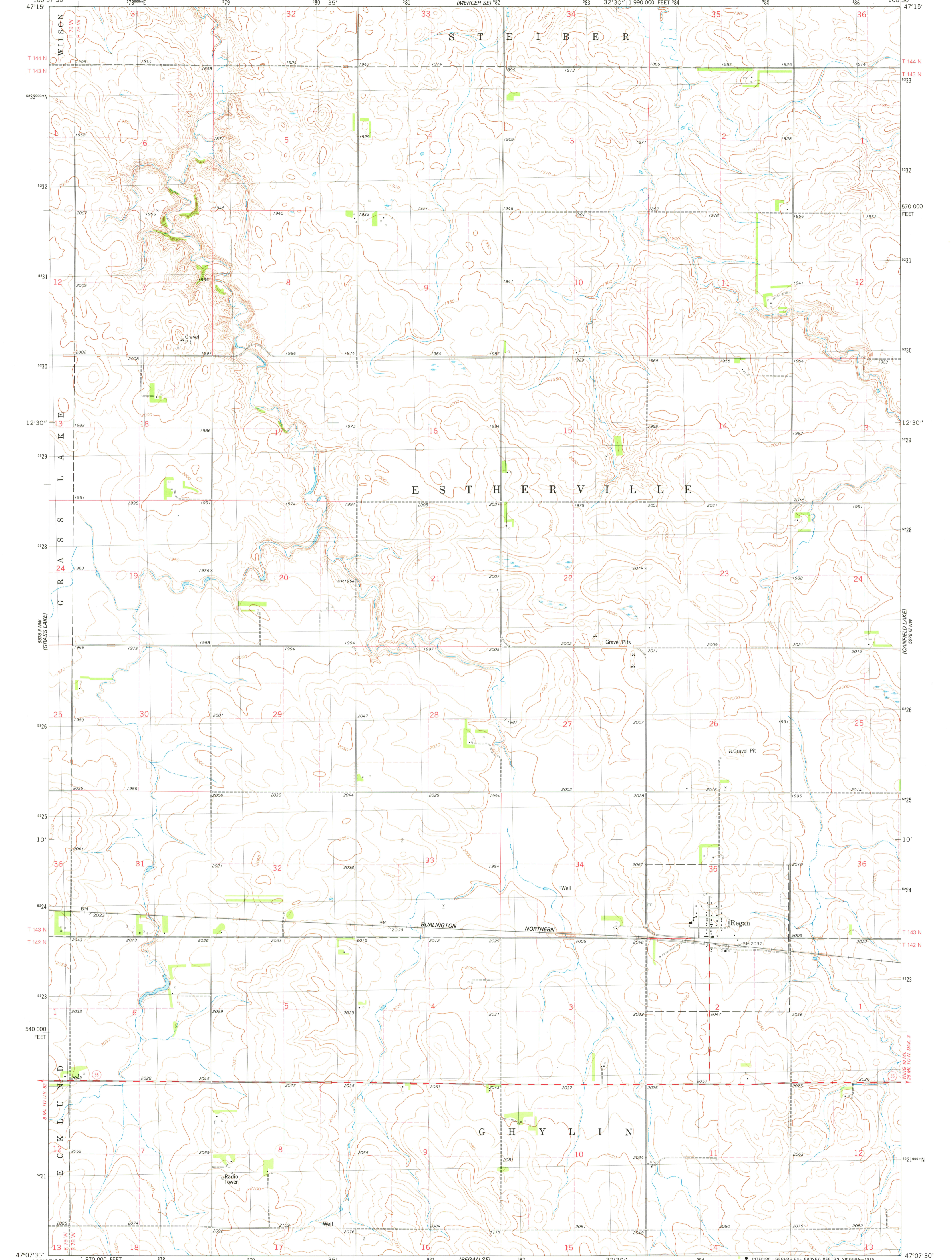

Maped, edited, and published by the Geological Survey  
Control by USGS and NOS/NOAA  
Topography by photogrammetric methods from aerial photographs taken 1974. Field checked 1976. Map edited 1979  
Projection and 10,000-foot grid ticks: North Dakota coordinate system, south zone (Lambert conformal conic)  
1000-meter Universal Transverse Mercator grid, zone 14 1927 North American datum  
Fine red dashed lines indicate selected fence and field lines where generally visible on aerial photographs  
This information is unchecked

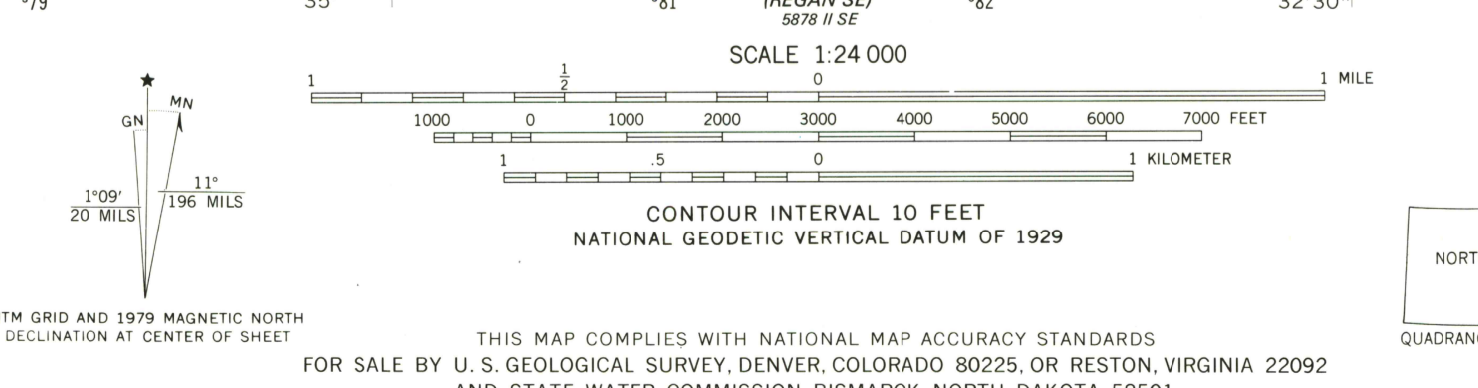

ROAD CLASSIFICATION  
Primary highway, hard surface  
Secondary highway, hard surface  
Unimproved road  
Light-duty road, hard or improved surface  
Interstate Route  
U. S. Route  
State Route

THIS MAP COMPLIES WITH NATIONAL MAP ACCURACY STANDARDS  
FOR SALE BY U. S. GEOLOGICAL SURVEY, DENVER, COLORADO 80225, OR RESTON, VIRGINIA 22092  
AND STATE WATER COMMISSION, BISMARCK, NORTH DAKOTA 58501  
A FOLDER DESCRIBING TOPOGRAPHIC MAPS AND SYMBOLS IS AVAILABLE ON REQUEST

REGAN, N. DAK.  
N4707.5—W10030.7/5

1979

AMS 5878 II NE—SERIES V871